

- Landscape Legend**
- Site Boundary Area Extent.
  - Habitat (existing boundary)
  - Soft Informal & Social.
  - Soft Outdoor PE- Grass.
  - Soft Outdoor PE Synthetic Pitch
  - Hard Outdoor PE
  - Hard Informal & Social
  - Proposed New Building footprint
  - Non Net External Areas- Hard Surfacing (access paths, roads, car parks)
  - Non Net External Areas- (General Grassland)
  - Proposed Shelters, Canopies, (Refuse, Cycles)

- Vehicle Mitigation Bollards.
- 2No. Charging point for 4No. Electric vehicles.
- Ducting and drawstrings for future expansion of EV points
- Existing Floodlighting to Synthetic Pitch to remain in place.
- New automated gate, with access control intercom (managed open for school drop off) 1.8-2.0m High.
- New manual gate, with locking drop bolt and lock (managed open for school drop off) 1.8-2.0m High.
- New Main Secure Line Fence-2.4m High Weldmesh, (with matching gates)
- Proposed Gates 2.4m High Secure Gates (manual control and automated access varies)
- New Sports/ Ball Fencing- Weldmesh- 3.0m High. (Forming part of Secure Line)
- Proposed Sports court entrance Gates 2.4m high (manual control)
- Existing retained weldmesh fence (along carpark frontage) -1.8m High.
- Existing timber knee rail, to be retained
- Existing car park boundary -sliding gate to be retained. (with automated access control for exit)
- Existing vehicle barrier retained.
- Existing Gate - to be retained for maintenance of vehicle access.
- New Access controlled entrance gate 1.8m high to car park.
- Secure Line Timber Screening Fencing-2.4m High.
- Internal Fencing to ASD Garden Timber Screening-1.8m High.
- New access gate to ASD Garden- 1.8 timber- manual control.
- Existing Retained Site Boundary Fences

**Total Site Wide Parking**

Formal Spaces = **94No.**  
 + Drop off/ Informal bays 2m X 6m = **12No.**  
**Total of 106No.**

Parking Summary:  
**Provision= 94No.**  
 Of- Standard Parking Bays 5m X 2.5m = **85No.**  
 Of- Accessible Wheelchair Bay 6.2m X 3.7m = **9No.**  
 Including Active Electric Vehicle Charging = **4No.**

Drop off bays 2m X 6m = **12No.**  
 (9No. Incl Future Electric charging)  
 Service Access Bays 3m X 14m = **1No.**  
 Cycles Storage = **30No.**

**Sports Provision Summary:**  
**Total Site Wide Provision Sports Pitches / PE = 26,400m<sup>2</sup>**  
 Existing Synthetic Football Pitch 18+ (low quality 99X56m) = **1No.**  
 Grass Football Pitch Under 16s (84X53m) = **1No.**  
 Grass Football Pitch Under U7/8s or 5aSide (37X27m) = **2No.**  
 Grass Football Pitch Under U9/10s or 7aSide (57X37m) = **1No.**  
 Grass Running Track 200m length X 6No. Lanes = **1No.**  
 Grass Rounders Pitches = **2No.**  
 Rugby Practice = **1No.** (not shown)

Existing MUGA Court = **1No.**  
 Incl Full Size Tennis = **3No.**  
 Incl Full Size Netball = **3No.**  
 Incl Basketball = **3No.**  
 Incl 5ASide = **3No.**  
 Incl Min Football/ 7ASide = **1No.**

Additional Hard Surface (mini sports area) for future allowance of:  
 Full Size Tennis = **1No.**  
 Full Size Netball = **1No.**  
 Basketball = **1No.**  
 Mini Soccer = **1No.**

Cricket Practice Nets. **2No.**  
 Long Jump. **1No.**

This document is © Bond Bryan Architects Ltd. If in doubt ASK. Drawing measurements shall not be obtained by scaling. Verify all dimensions prior to construction. Immediately report any discrepancies on this document to the Originator. This document shall be read in conjunction with associated models, specifications and related consultants' documents.

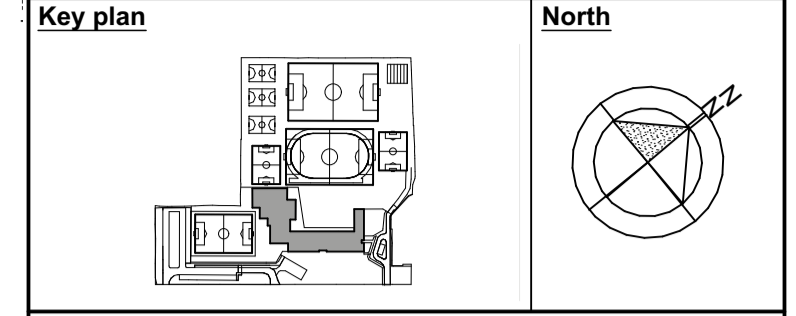

P22	Stage 4 comments	ZZ	SR	21/11/2023
P21	New substation and temp substation	ZZ	SR	20/11/2023
P20	Bollards and Road	ZZ	ZZ	24/10/2023
P19	Comments	ZZ	ZZ	20/10/2023
P18	S14-Updated-Bollards, EV, TempMUGA Levels	SR	SR	19/10/2023
P17	S14 Updated to DIE Comments	SR	SR	16/10/2023
P16	S14 Issue- Updated to comments & sports pitch entrance surface removed.	SR	SR	09/10/2023
P15	Stage 4 Update Substation, Comments and Planning	SR	SR	27/09/2023
P14	Client's comments	ZZ	SR	07/09/2023
Rev	Description	Drawn	Checked	Date

**B**

BOND BRYAN

e info@bondbryan.co.uk  
w www.bondbryan.co.uk

**DfE**

**Orchards Academy**  
Orchards Academy

**Landscape-Proposed Masterplan**

Originator project ref <b>22237</b>	Purpose of Issue <b>For Information</b>
Scale(s) <b>1:500</b>	Revision description <b>PRELIMINARY</b>
Paper size <b>A1</b>	

project originator	volume	level	type	role	number	revision
<b>SRP1072</b>	<b>BBA</b>	<b>ZZ</b>	<b>00</b>	<b>D</b>	<b>L</b>	<b>1006</b>
Name: 2023/1/2023						<b>P22</b>