

amendments		
rev.	date	comment
-	-	-

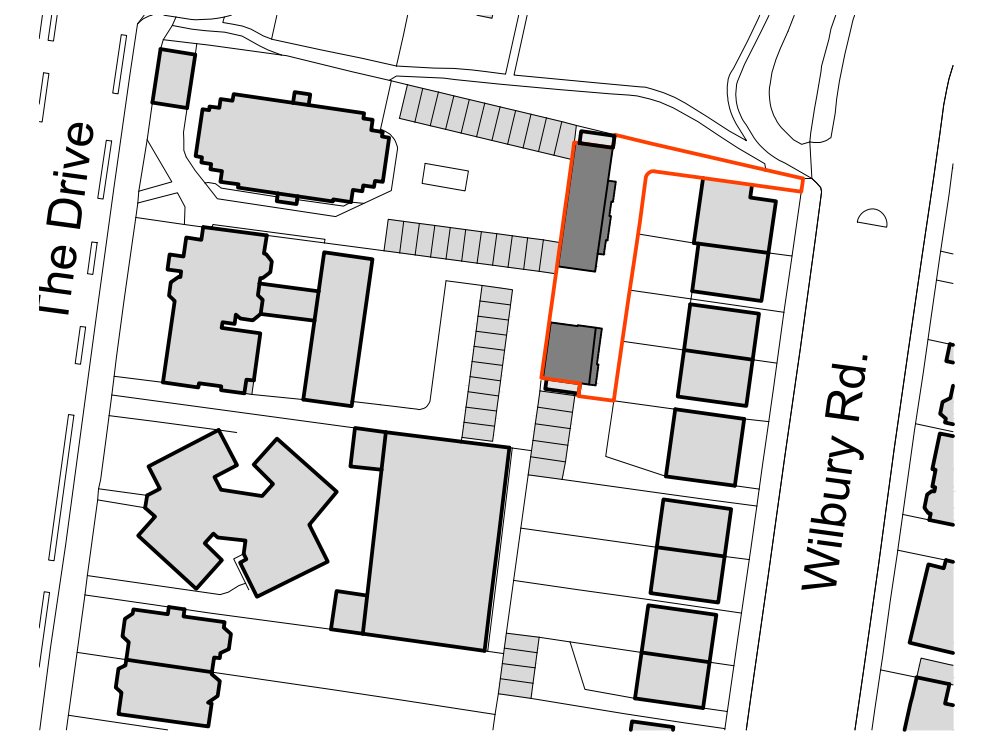

Location Plan 1:1250

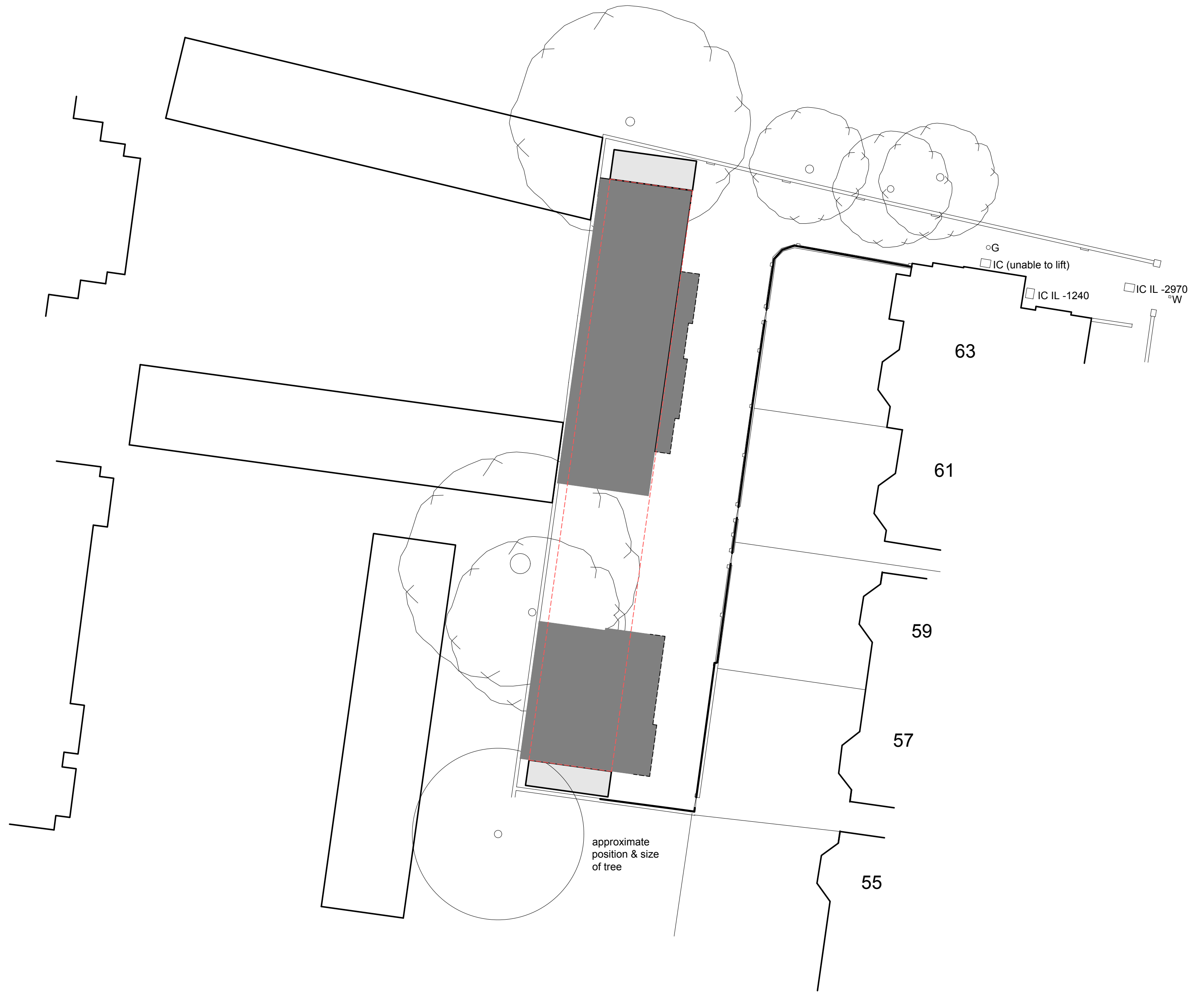
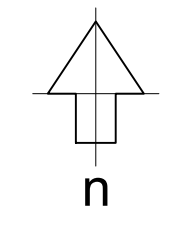
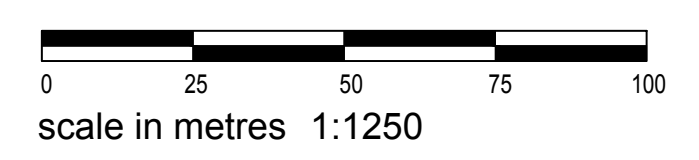

Site Plan 1:200

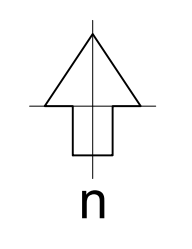
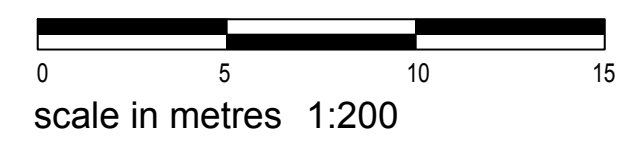

Block Plan 1:500

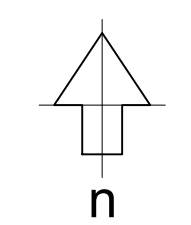
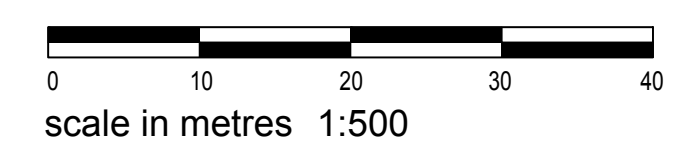

- Site boundary
- Neighbouring buildings
- Proposed dwellings
- Retained stores
- Existing garages for demolition

client	drawing number	revision
Skep Projects	0697.PL.400	-
project	drawing title	
LRO 57-63 Willbury Road, Hove, BN3 3PB	Proposed Site Plan Location & Block Plans PLANNING	
drawn by	checked by	riba work stage
ES	GI	-
		date
		Jan '24
		scale/original sheet size
		As shown @ A1
<small>www.abir.co.uk studio@abirarchitects.co.uk Unit 1, Bala House, St John's Road, Hove, BN3 2FX, United Kingdom Hove +44 (0)1273 724 384 Company No 06877117 VAT No 971 4147 17</small>		<small>© ABIR Architects Ltd. Check all dimensions on site before work is undertaken. All goods, materials and workmanship to conform with current building regulations, BSS and COP's.</small>