

**Ground-Guards** GreenTek

**EuroMat®**  
Heavy Duty Temporary Access Mat

Ground protection and site access system  
Ground-Guards are an "instant recovery" system of lightweight plastic panels, capable of taking vehicles of up to 10 tonnes weight.

**Heavy Duty Temporary Access Mats**  
Temporary mats up to 50 tonnes "EuroMat"® are available from the specialist manufacturer of heavy-duty mats and temporary ground protection systems.

**Temporary BS5837 tree fencing to protect RPAs and scattered boundary vegetation during construction**

Examples of temporary ground protection to protect RPAs outside fencing where vehicular/plant access is required

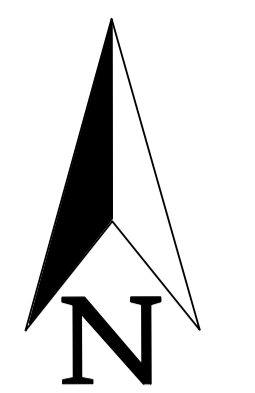
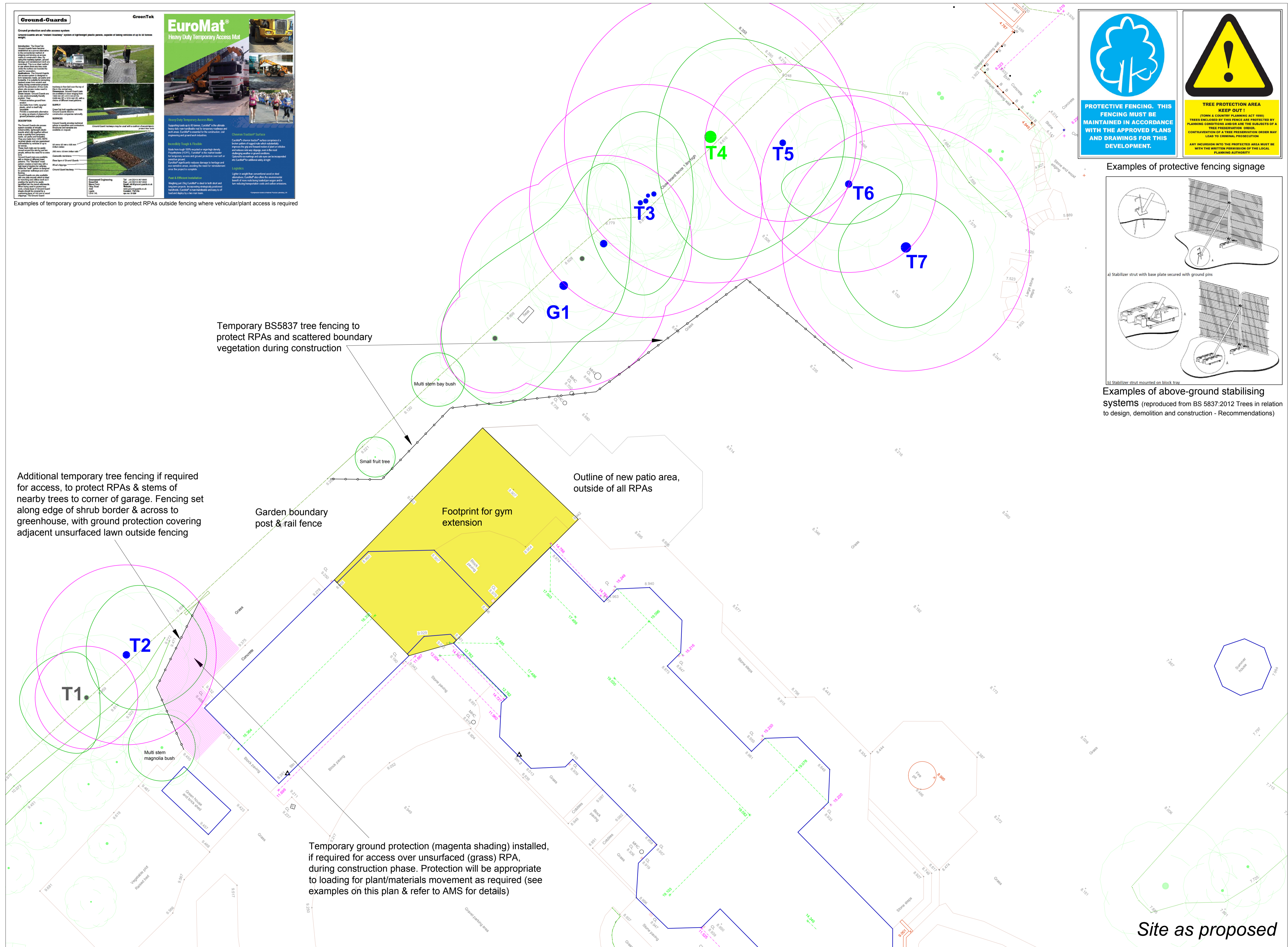

Examples of protective fencing signage

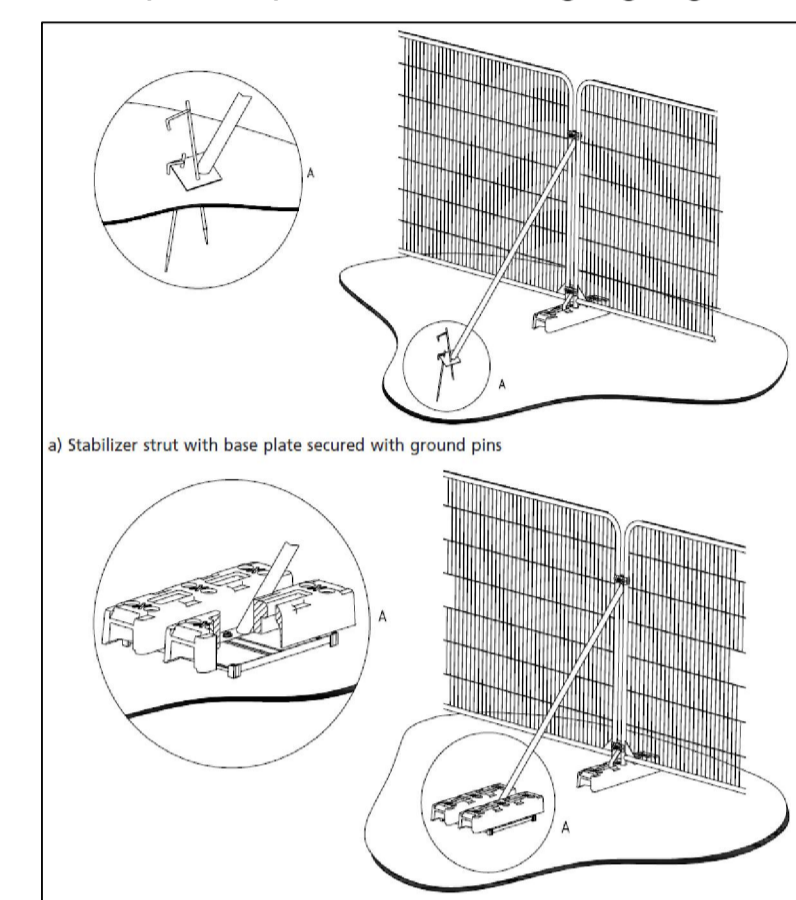

Examples of above-ground stabilising systems (reproduced from BS 5837:2012 Trees in relation to design, demolition and construction - Recommendations)

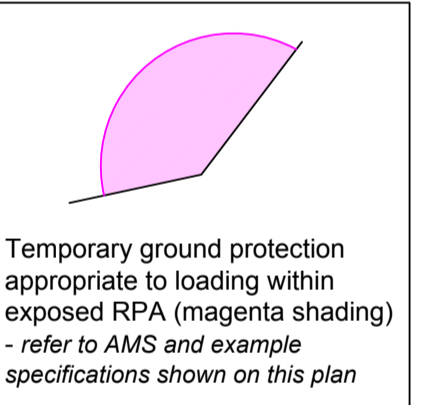
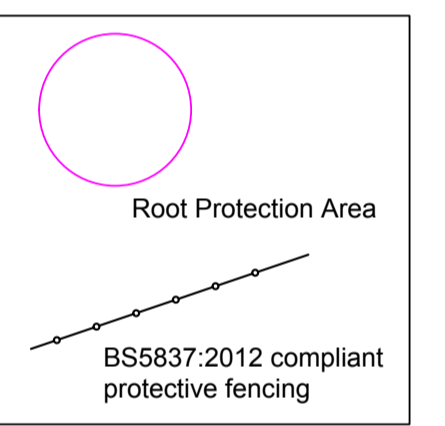

M: 07967 725238  
E: info@woodsidetrees.co.uk  
W: www.woodsidetrees.co.uk

**CLIENT:**  
Mr R. Batchelor

**PROJECT:**  
Land at Beach House Cottage, Bembridge

**DRAWING TITLE:**  
Tree Protection Plan

**DRAWING NO:**  
AS/RB/0324 TPP

**DATE:**  
26.03.2024

**SCALE:**  
1:125 @ A1

© Woodside Tree Consultancy

Site as proposed