

A

EAST LANE

HEDGE HT 2.75m

HEDGE HT 2.9m

Bottom of Bank

HEDGE HT 3m

GATE

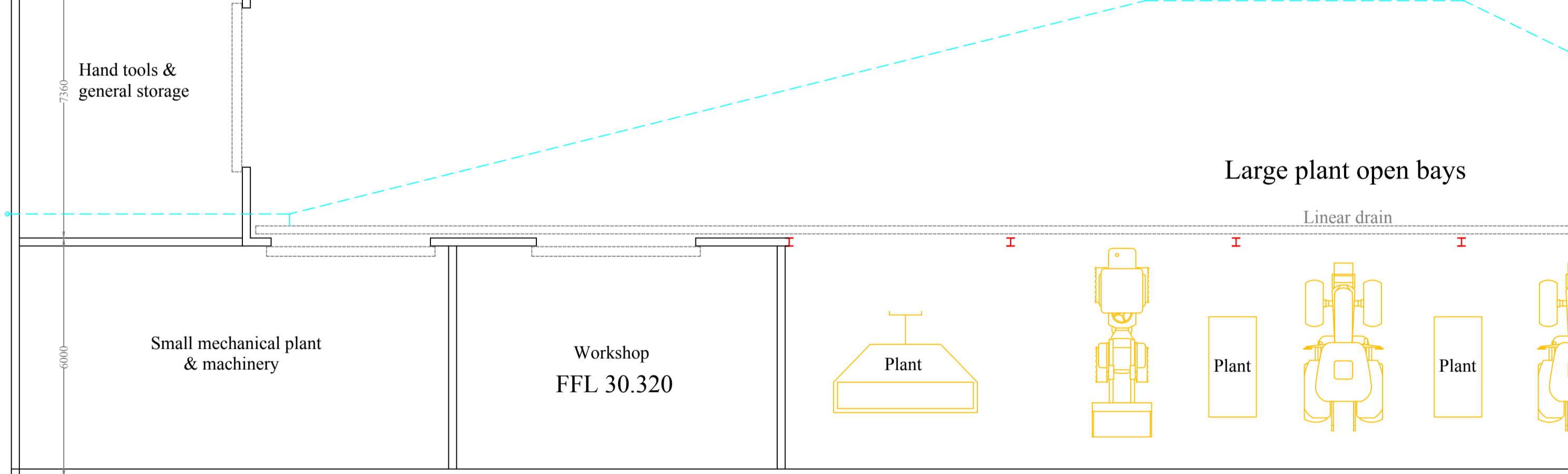
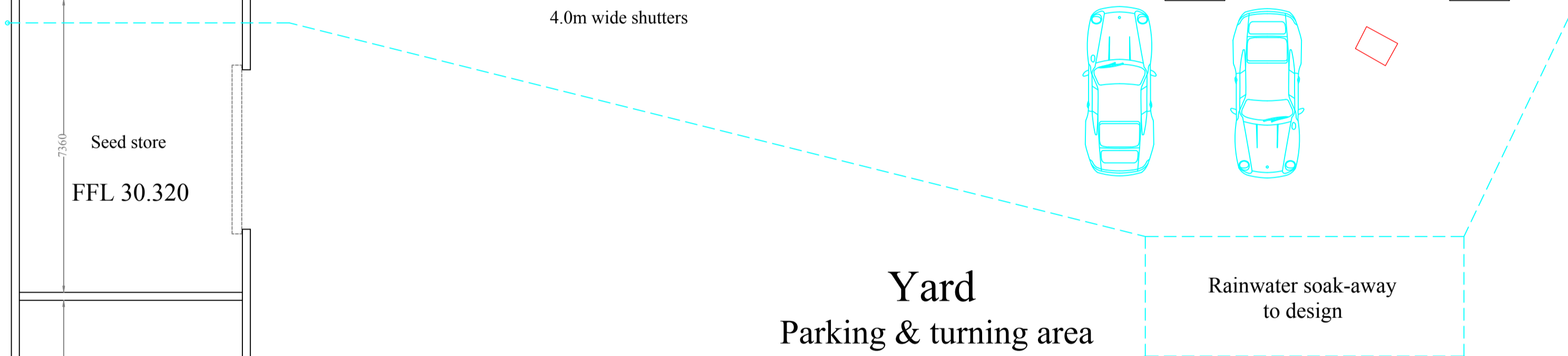
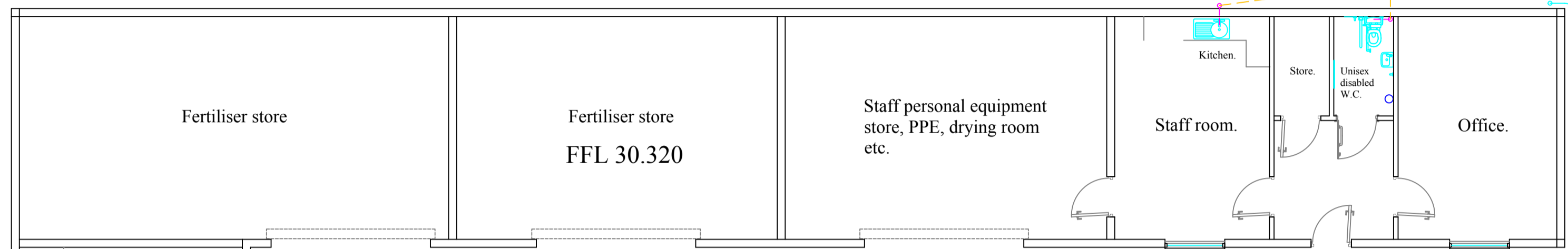

Yard
Parking & turning area

Large plant open bays

STORE

Cesspool

BURY LANE

HEDGE HT VARIES 2m -2.3m

Boundary Post & wire fence in hedge.

A

B

B

Actual Boundary

Refer also to Landscape Plan 31-2023-5

ALL LEVELS AND DIMENSIONS MUST BE CHECKED ON SITE THESE DRAWINGS ARE TO BE READ IN CONJUNCTION WITH ENGINEERS, AND ALL OTHER SPECIALIST CONSULTANT DETAILS. IT IS THE CLIENT'S RESPONSIBILITY TO AGREE ANY ALTERATIONS TO APPROVED PLANS WITH THE PLANNING AND BUILDING REGULATION AUTHORITIES. IT IS THE CLIENT'S RESPONSIBILITY TO READ AND COMPLY WITH CONDITIONS IMPOSED ON ANY PLANNING AND BUILDING REGULATION APPROVALS ASSOCIATED WITH THESE PLANS, INCLUDING AGREEING MATERIALS AND FINISHES WITH PLANNERS PRIOR TO COMMENCEMENT.

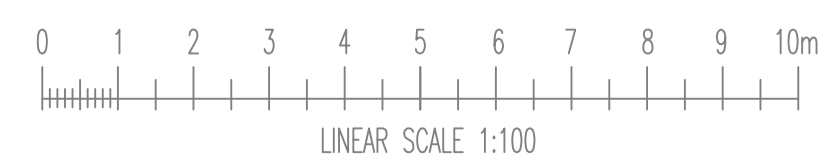

Date August 2023
Drawn by PM
Checked by

Revision Rev B April 2024

Scale A1 @ 1:100
Drawing No. 31-2023-1

Location: Hillcroft Turf Supplies, East Lane, Merstone.
Project: Proposed Site Plan.

'The Dairy' at Hebbardens,
Yarmouth Road, Shalfleet,
Newport,
Isle Of Wight,
PO30 4NB.
Tel: 01983 555132

