

NOTES:

1. This drawing is to be read in conjunction with all relevant contract documentation from the design team, with any conflicting information to be brought to the attention of Farrer Huxley Associates in writing before commencing on site.
2. The contractor is to check and verify all levels and dimensions before construction. Any discrepancies are to be brought to the attention of Farrer Huxley Associates in writing before commencing on site.
3. All dimensions in mm, unless otherwise stated.
4. Do not scale from this drawing.
5. All sub base and concrete design and specification to engineer's details. All diagrams provided here are purely indicative.
6. Waterproofing of any element to be specified by others.
7. All proprietary products shall be installed in accordance with manufacturers written instructions.
8. Plant numbers are an indication only and plants should be ordered to suit site areas in accordance with scheduled plant densities.
9. Any proposed plant substitution shall be agreed with the landscape architect prior to ordering.

DESIGN PARAMETERS:

The swift tower will reference the Eagle Brewery's chimney in its form and location, whilst adhering to strict habitat requirements (safe from predators, away from direct sunlight etc). These parameters include a height range of 3-7+m. As a design element of some height, the tower it will also act as a totem or landmark that enables wayfinding.

A swift tower is made up of chambers (of specific size) and openings (of particular placement). Within these constraints there is potential to explore more aerodynamic forms, concentric iterations, or naturally found shapes.

- 7.7m has been established as the maximum height of the swift tower. Placed within a planter at the north end of the site, the top of the tower aligns with the corner of the adjacent pitched roof.
- This would align with a recommended 6m minimum clearance from the base of column to the base of swift chambers, and a 1.7m height allowance for the nest chambers.

Illustrative elevation showing design intent only. Swift tower to be further developed post-planning and subject to a planning condition.

For additional information regarding the swift tower please refer to pg 29, 32, 60, 70,71,72 of the Design & Access Statement.

• APPLICATION NUMBER – 24/00640/CREG3

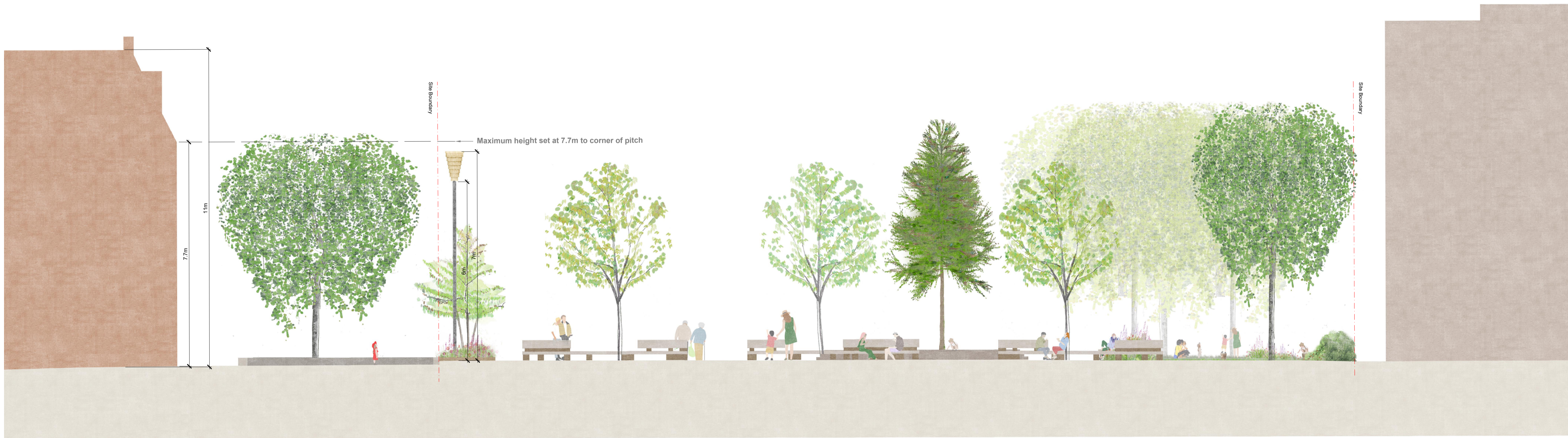

01 INDICATIVE DESIGN ELEVATION SHOWING SWIFT TOWER LOCATION

Scale 1:75 @ A1

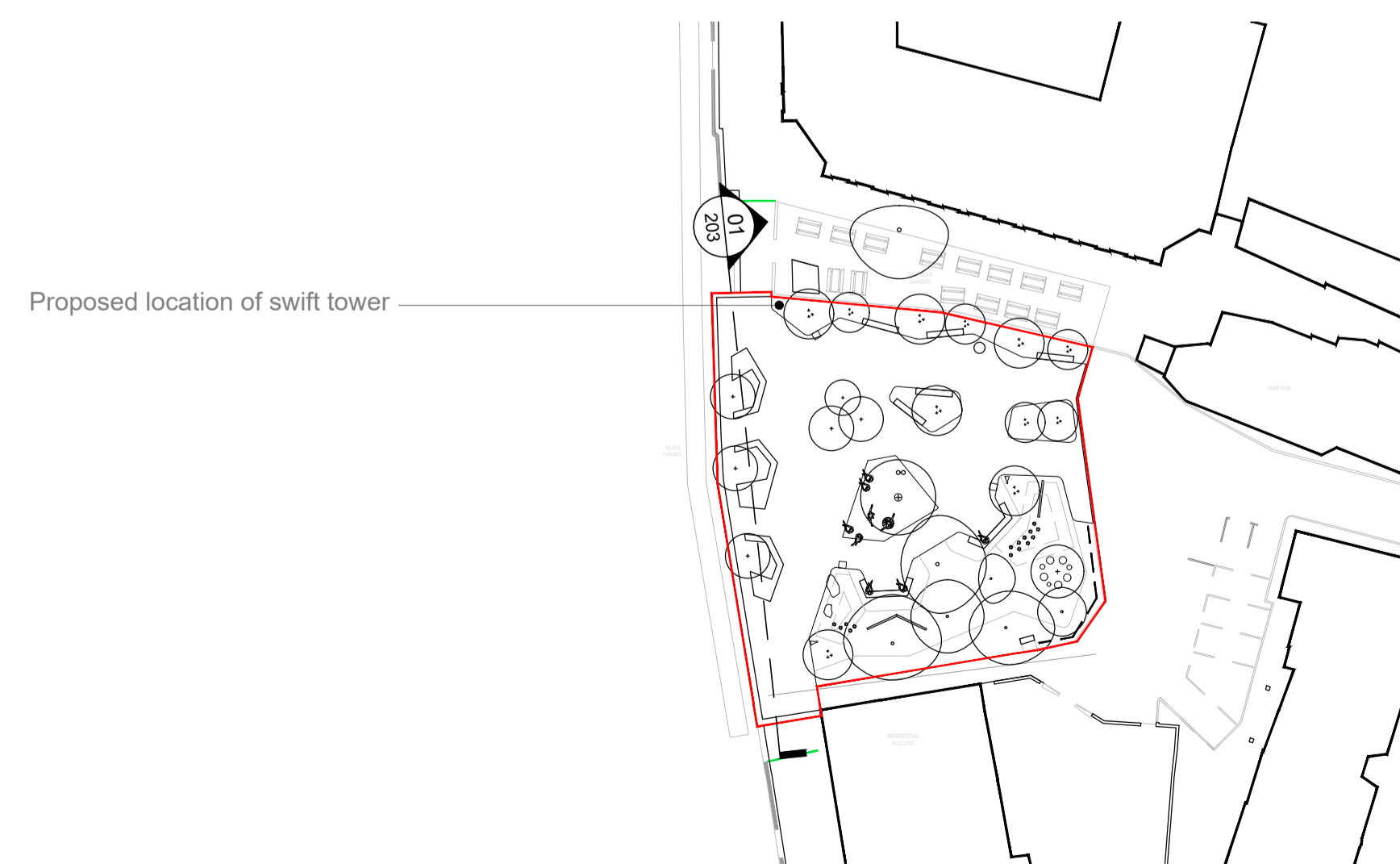

LOCATION MAP

Scale 1:500 @ A1

DATE	ISSUED	DESCRIPTION OF REVISION	REVISION	APPROVED
24/03/25	HW	FOR PLANNING	01	HW

FARRER HUXLEY

Unit 11, Union Wharf
23 Wenlock Road, London, N1 7SB
www.farrerhuxley.co.uk info@farrerhuxley.co.uk
T: 020 7490 3625

DRAWING STATUS:

FOR PLANNING

CLIENT:
KINGSTON COUNCIL

PROJECT TITLE:
EAGLE BREWERY WHARF

DRAWING TITLE:
PROPOSED LOCATION AND INDICATIVE DESIGN OF SWIFT TOWER

DRAWING SCALE: As Shown
DRAWN BY: CT
PAPER SIZE: A1
DRAWN DATE: MARCH 2024
APPROVED BY: HW

DRAWING NUMBER: 827-FH-XX-00-DT-L-203
REVISION: 01

Copyright Farrer Huxley 2023