

11M-TRUCK Meters
 Width : 2.50
 Track : 2.50
 Lock to Lock Time : 6.0 s
 Steering Angle : 37.4 deg

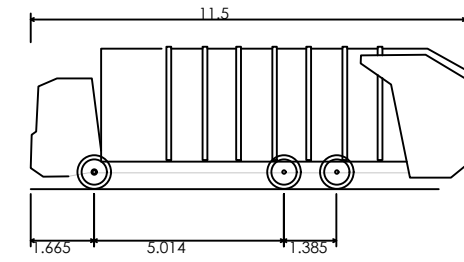

Eagle Elite 2 6x4 (non rear steer)
 Overall Length 11.5m
 Overall Width 2.530m
 Overall Body Height 3.756m
 Min Body Ground Clearance 0.307m
 Track Width 2.530m
 Lock to Lock Time 4.00s
 Kerb to Kerb Turning Radius 11.550m

SWEPT PATH ANALYSIS VEHICLE
 N.B. Slightly shorter than typical Refuse collection vehicle (11.3m) but with longer axle - refuse lorry will have smaller turning radius

TYPICAL REFUSE COLLECTION VEHICLE - ASSUMED
 Slightly longer than LA Refuse Collection Vehicle but assumed similar axle length/turning radius

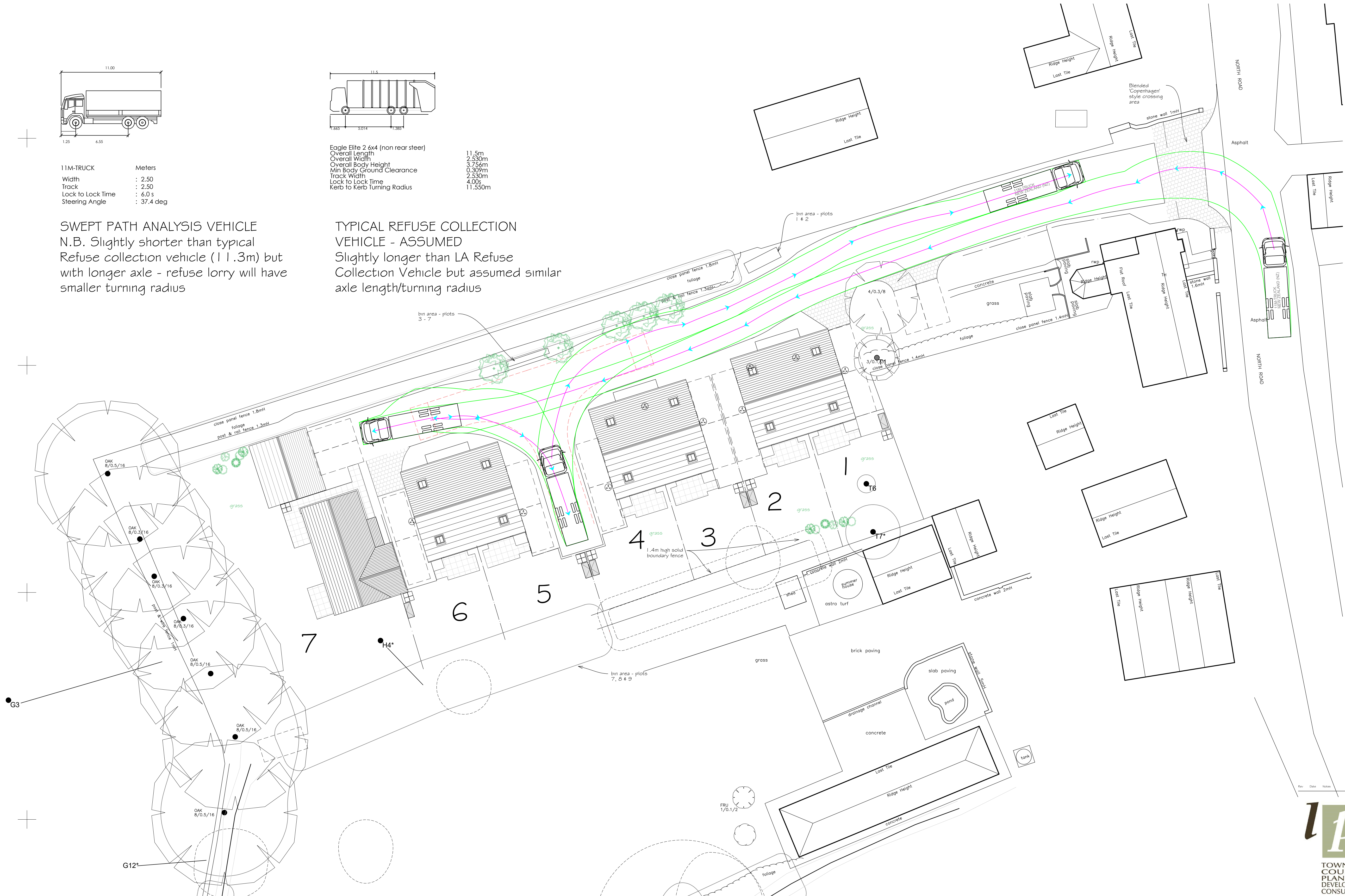

--- FIRE APPLIANCE TURNING



LPC (TRULL) LTD.,
 TRULL, TETBURY, GLOUCESTERSHIRE GL6 2SQ
 Tel: 01285 841433 email: admin@lpc-trull.com

Drawn by
 Mr K Scott
 229 North Road, Yate
 BS37 7PL

Client
 SITE PLAN - PROPOSED
 SWEPT PATH ANALYSIS
 Date: December 2023 Scale: 1:200 @ A1
 Drawing Number
 LPC 5357 PR 102

