

Amendments/Notes

Rev.	Detail	By	Date
------	--------	----	------

NOTE:

- SETTING OUT DIMENSIONS MEASURED FROM FACE OF MASONRY WALLS (BRICK / BLOCK) AND/OR STRUCTURAL FACE OF TIMBER STUD PROPRIETARY PARTITIONS (NOTE: NOT PLASTERBOARD FACE).
- ALL DIMENSIONS ARE TO FACE OF BRICKWORK / BLOCKWORK / STUDWORK UNLESS OTHERWISE NOTED.
- ALL STRUCTURAL STEEL WORK TO BE PAINTED BY SPECIALIST SUBCONTRACTOR TO 1 HOUR FIRE PROTECTION WITH 'NILLIFIRE' OR SIMILAR APPROVED PRODUCT. WORKS TO BE CERTIFIED BY SUBCONTRACTOR ON COMPLETION.
- ALL SERVICE PENETRATIONS ETC. THROUGH FIRE COMPARTMENT WALLS AND FLOORS ETC. TO BE FIRE STOPPED USING PROPRIETARY FIRE COLLARS, STEELS ETC.
- VERTICALLY INSULATED DPC TO BE INSTALLED TO JUNCTION BETWEEN OLD AND NEW WALLS.
- GRID LINES TAKEN TO CENTRE LINE OF CAVITY WALL / POROTHERM WALL (EXCLUDES EW) CONSTRUCTION.
- DOOR SIZES AS SHOWN ARE TO STRUCTURAL OPENING DIMENSIONS UNLESS OTHERWISE NOTED.
- WINDOW SIZES AS SHOWN ARE TO BLOCK OPENING DIMENSIONS UNLESS OTHERWISE NOTED.
- FOR BELOW GROUND DRAINAGE REFER TO STRUCTURAL ENGINEER DRAWINGS
- NOTE! THE PROPOSED ABOVE GROUND DRAINAGE SHOWN ON THIS PLAN IS ONLY INDICATIVE. IT IS THE RESPONSIBILITY OF THE MAIN CONTRACTOR TO ENSURE THAT ALL ABOVE GROUND DRAINAGE DESIGN & INSTALLATION WORKS ARE TO BE CARRIED OUT BY THE MAIN CONTRACTOR IN ACCORDANCE WITH ENGINEERS SPECIFICATION. POSITIONS OF BELOW GROUND DRAINAGE TO PICK UP SVP'S AND OTHER ABOVE GROUND DRAINAGE POINTS ARE TO BE CONFIRMED PRIOR TO CARRYING OUT THE INSTALLATION OF THE BELOW GROUND DRAINAGE WORKS.
- THIS DRAWING TO BE READ IN CONJUNCTION WITH ALL CONSULTANTS DRAWINGS & DETAILS. PLEASE NOTE: IF THERE IS A DISCREPANCY IN SIZE OF STRUCTURAL MEMBERS, STRUCTURAL ENGINEER'S DRAWINGS TAKE PRECEDENCE.
- INCLUDE FOR ALL BUILDER'S WORK IN CONNECTION WITH M&E, INTERIOR DESIGN, STRUCTURAL, AV, etc



PLANNING

All dimensions and levels to be checked on site by contractor prior to preparation of shop drawings and commencement of work on site.
 This drawing and the copyrights and patents therein are the property of the Architect and may not be used or reproduced without consent.
 This drawing is to be read in conjunction with all relevant consultants and/or specialist's drawings/documents and any discrepancies or variations are to be notified to the Architect before the affected work commences.
 All works on site are to be carried out fully in accordance with current CDM regulations and recommendations, current Building Regulations, British Standards and Codes of Practice as appropriate.

Project
**18 NORTH APPROACH
 MOOR PARK
 NOTHWOOD
 HA6 2JG**

Drawing
**PROPOSED LOFT
 FLOOR PLAN**

**SEABROOK
 ARCHITECTS**
 CHARTERED ARCHITECTS
 Unit17, Chiltem Court, Ashridge Road,
 Chesham, Bucks, HP5 2PX
 Tel: 01494 778918
 e-mail: info@gsarchitects.co.uk

Drawn By	DM	Date	03.07.2023
Checked By	.	Date	.
Approved By	.	Scale	1:50 @ A1
Drawing No.	6096 PL 202	Rev.	PL 2

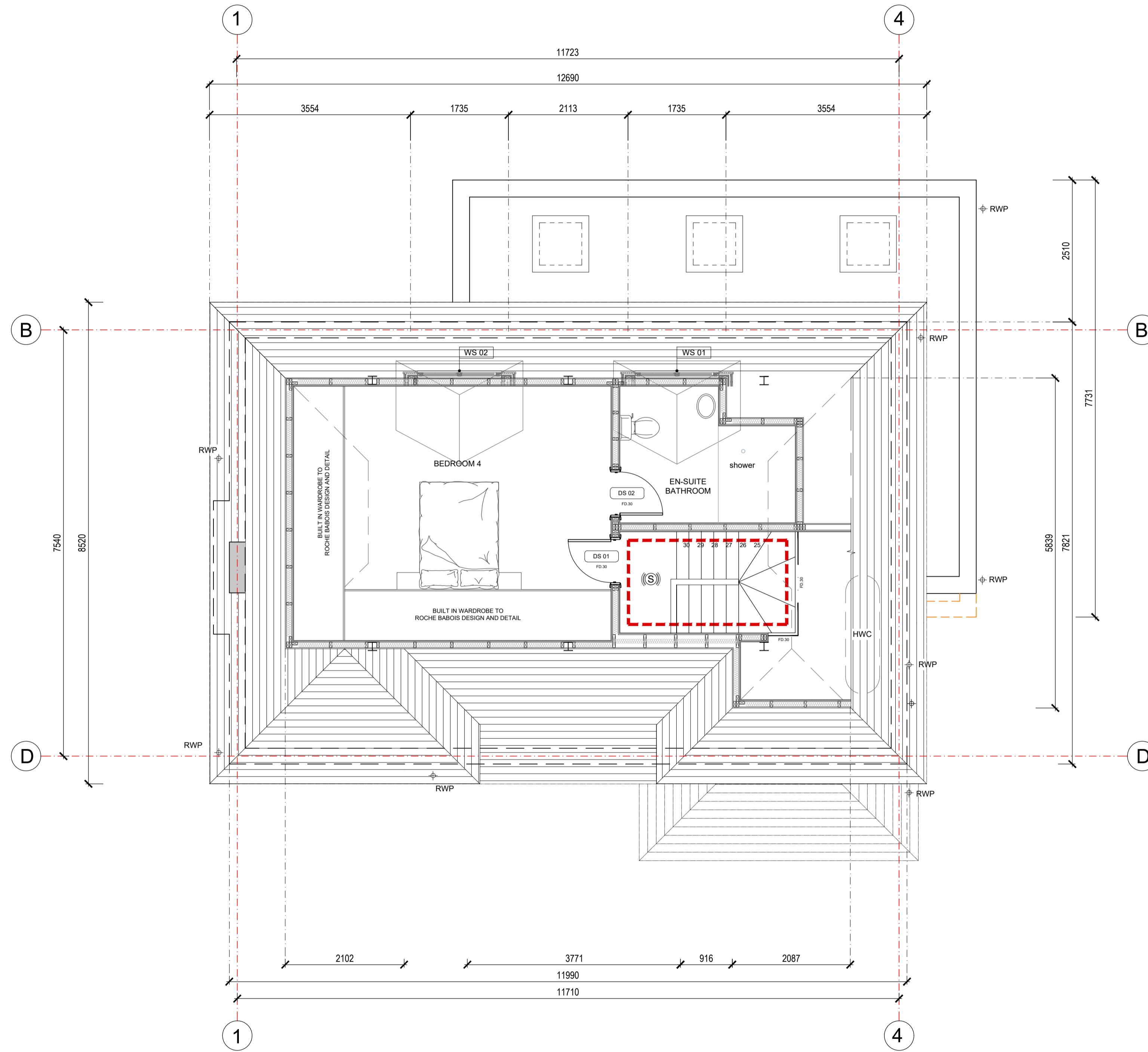

LEGEND

- Proposed new timber stud walls
- Existing masonry walls with new insulation injected into cavity by specialist contractor application.
- Existing internal masonry walls
- Proposed new external cavity walls
- Proposed new beams to SE specification and detail
- Demolished
- Proposed new concrete padstone
- Proposed Fire Compartmented Area
- Span Proposed Beam and Block floor
- Span Proposed Timber Floor
- Fire door = 30mins fire resisting
- Rainwater Pipe
- Soil Vent Pipe
- Automatic Smoke Detector & Alarm Sounder
- Automatic Heat Detector/Sounder
- Automatic CO2 Detector/Alarm
- External Door - Security

0 Scale 1:50 5m

1 PROPOSED LOFT PLAN
 6096 PL 202