



Property (GIA) Gross internal floor area = 269.7m²
 Gross External Area (GEA) = 310m²
 Carriage floor area = 34.7m²

A Proposed Site Plan
 Scale 1:200

This drawing is the copyright of Mansfield Monk
 All dimensions to be checked on site prior to commencement of work

- Drawing Legend:**
- Denotes area of lawns/ grassland/ gardens
 - 1 Denotes area of existing hard surfaces/ concrete pathways
 - 2 Denotes areas of new permeable block paving
 - Denotes areas of new permeable gravel driveway/ roadway
 - Denotes areas of new raised decking/ steps/ ramps/ walkways
 - Denotes redline site boundary

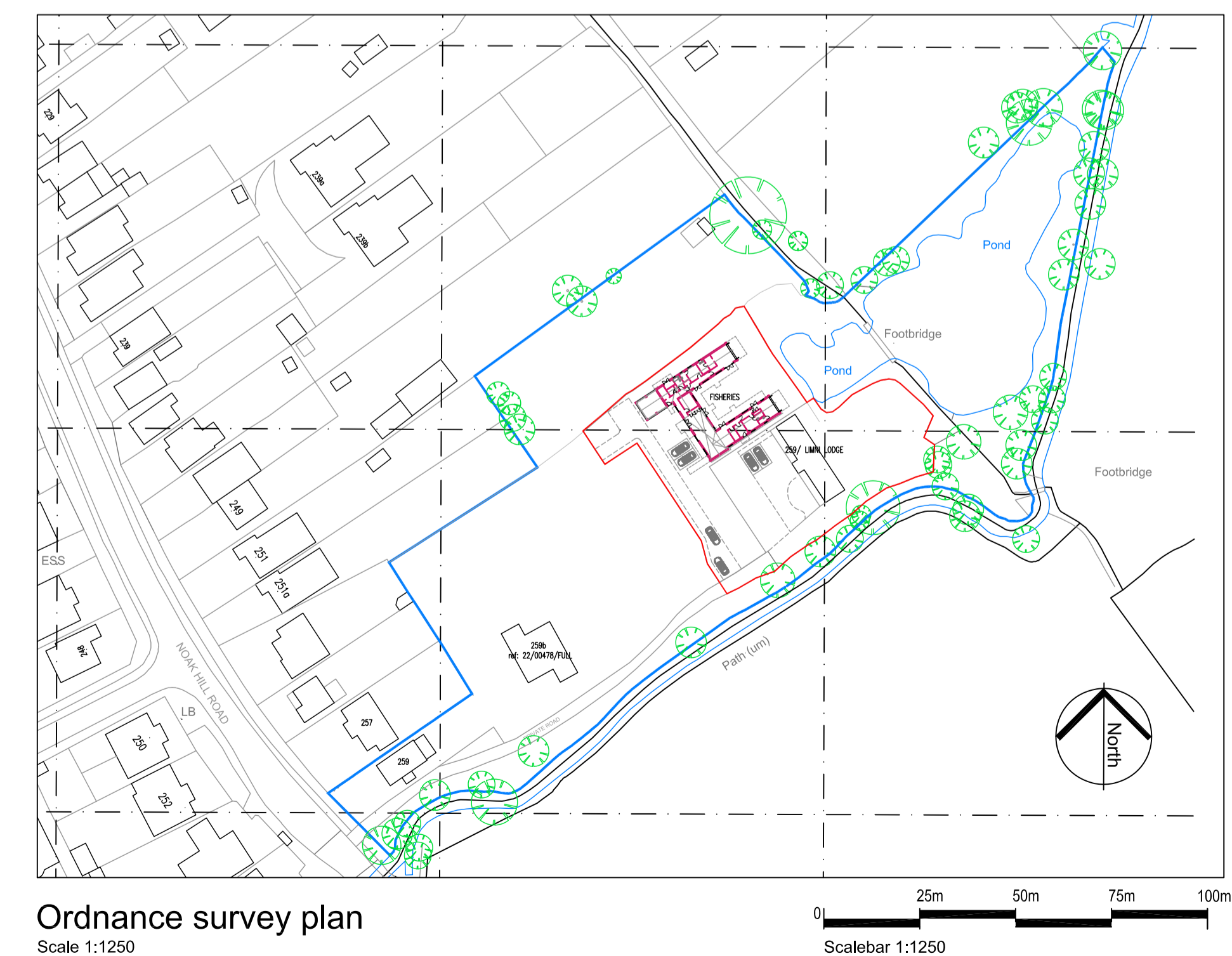

C	LC	Site plan coordinated with planning statement and extent of works updates to suit. Drawing legend added. Issued for Planning Approval.	20.03.24
B	LC	Site plan coordinated with Flood risk assessment and surface water drainage added. Red/ blue boundaries updated.	09.10.23
A	LC	Floor area reduced and building moved south away from northern most boundary. Issued for Full Planning Permission.	20.04.23
-	LC	Issued for Pre-application advice.	08.12.22
Rev.	Drawn	Description	Date



Client	Mr R Judd		
Project	259 Noak Hill Road - Fisheries Site Great Burstead, Billericay, Essex CM12 9UL		
Drawing	Proposed site plan arrangement		
Drawing Status	APPROVAL		
Scale	1:200@A1	Cad file	-2734 PASP
Drawn by	LC	Project no.	222734
Checked by	LC	Drawing no.	PASP
Date	OCT 2022	Revision	C