

NOTES

1. ALL DIMENSIONS TO BE CHECKED ON-SITE.
2. ANY DISCREPANCIES TO BE BROUGHT TO THE ATTENTION OF THE ARCHITECT.

New stone lintel
4 courses high to
match existing

Typical door details for new and replacement of 20th Century doors. Please refer to proposed Elevation drawings 2151.PD.202-204. Door height and width will differ for each opening. Site dimensions to be taken prior to manufacture. All new doors are to be manufactured in Sapele, primed and painted internally and externally with 14mm thin double glazed units. 4mm clear float outer pane, 6mm gas filled cavity with aluminium white spacer bar, 4mm Low E clear float glass inner pane. Any glass below 800mm from floor to be toughened. Please note: the door section and elevation shown are typical details of the general construction of the doors and the proportions of a proposed French door, front door, fixed glazing and stable door have been adjusted on the elevations to show the extent of glazing and relationship to the surrounding sash windows.

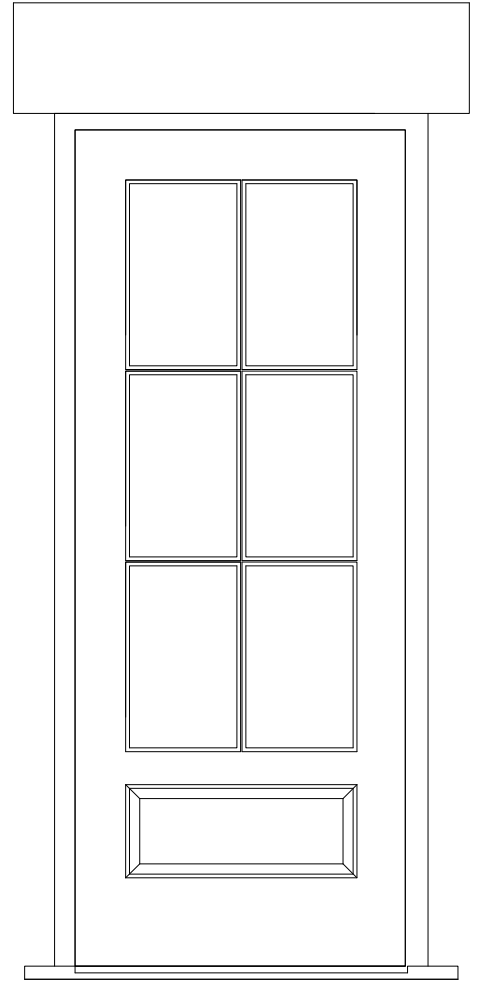

1:20 Typical Door Elevation

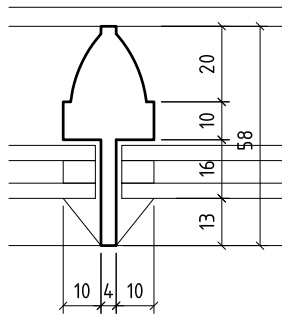

1:2 Typical Glazing Bead

New stone cill

Internal Floor Level

External Ground level

REV	BRIEF DETAILS	DATE

Typical Door Detail for Extension as Proposed

for
ONEHOUSE HALL
LOWER ROAD
ONEHOUSE
STOWEMARKET
IP14 3BY

© The copyright of this drawing belongs to Kay Pilsbury Thomas

NO.	REV	CHECKED
2151 / PD / 207		ST
SCALE	DATE	DRAWN
1 : 10 @ A4	NOV '22	KB

KAY PILSBURY THOMAS ARCHITECTS
 TEL 01799 599208 FAX: 01799 599965
 www.kpt.co.uk info@kpt.co.uk
 HONEYLANDS, RADWINTER, SAFFRON WALDEN, ESSEX, CB10 2TJ

500mm 400 300 200 100 0 SCALE 1:10 500mm 1000mm

1:10 Typical Door Section

1m 800 600 400 200 0 SCALE 1:20 1m 2m