

NOTES

1. THESE ARE PLANNING DRAWINGS AND ARE FOR THAT PURPOSE ONLY
2. THESE ARE NOT TO BE USED FOR CONSTRUCTION

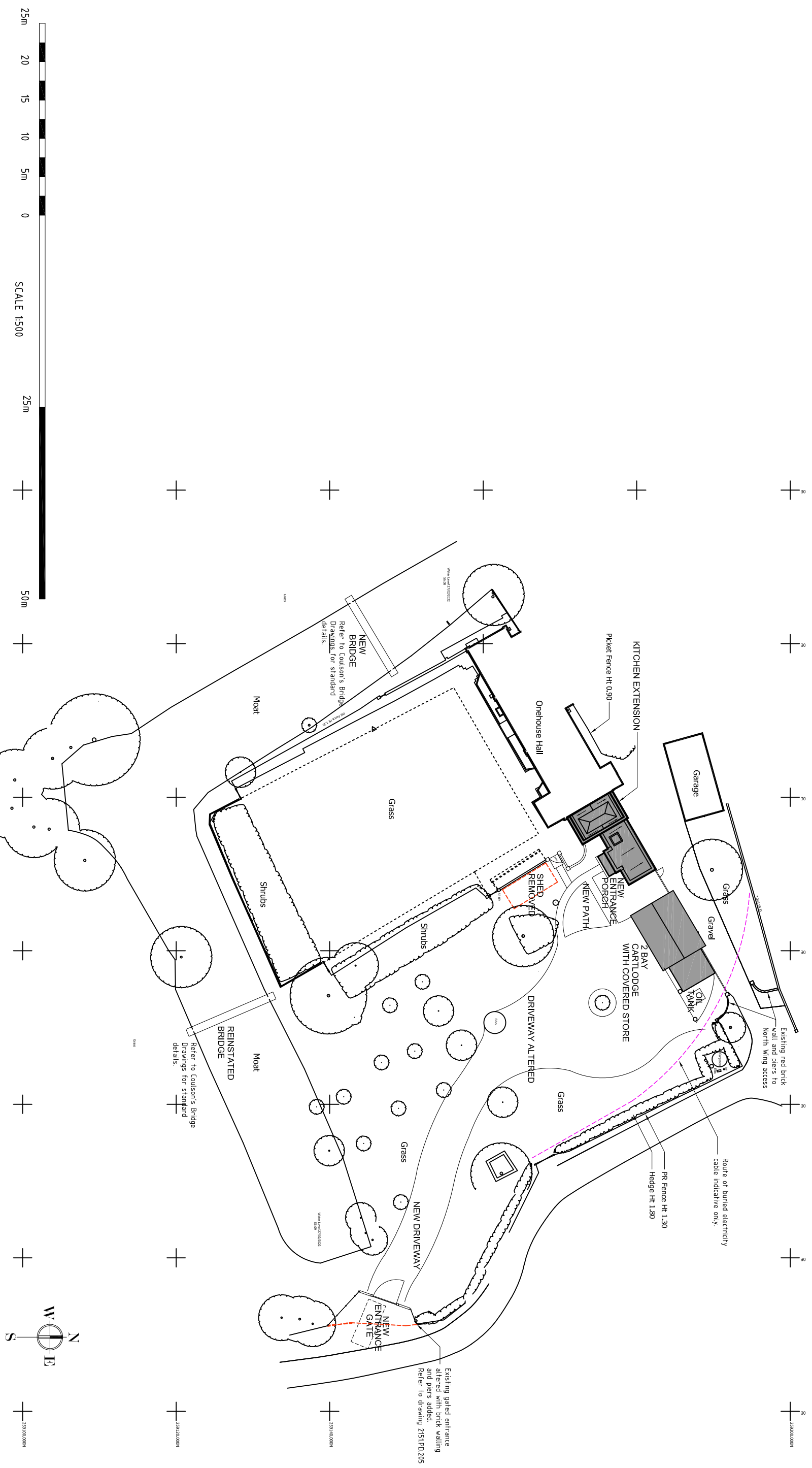

SCALE 1:500

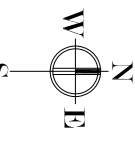

| REV | BREF DETAILS   | DATE     |
|-----|--|----------|
| A   | Option 1 with buried cables (reusing perpendicular) to house                     | 18/05/22 |
| B   | Driveway layout updated  | 09/06/22 |
| C   | Shed position updated  | 14/06/22 |
| D   | Garage layout amended, bridge positions added                                    | 07/09/22 |
| E   | Log store and south gate amended and underground cable position adjusted         | 27/11/22 |
| F   | Root Plan updated  | 23/11/22 |
| G   | Amended to reflect revised garage layout. Revised electric cable layout updated. | 27/11/24 |

Proposed Block Plan  
for  
ONEHOUSE HALL  
LOWER ROAD  
ONEHOUSE  
STOWMARKET  
IP14 3BY

© The copyright of this drawing belongs to Kay Pilsbury Thomas

|       |                 |      |        |         |    |
|-------|-----------------|------|--------|---------|----|
| NO    | 2151 / PD / 200 | REV  | G      | CHECKED | ST |
| SCALE | 1 : 500 @ A3    | DATE | MAR 22 | BRN     | SA |

**KAY PILSBURY THOMAS ARCHITECTS**  
 TEL: 01799 599208 FAX: 01799 599365  
 www.kpt.co.uk info@kpt.co.uk  
 HONEYLANDS, RADWINNER, SAFFRON WALDEN, ESSEX, CB10 2TJ