

GROUND FLOOR AREA
108.7 SQ M

Existing Ground Floor Plan

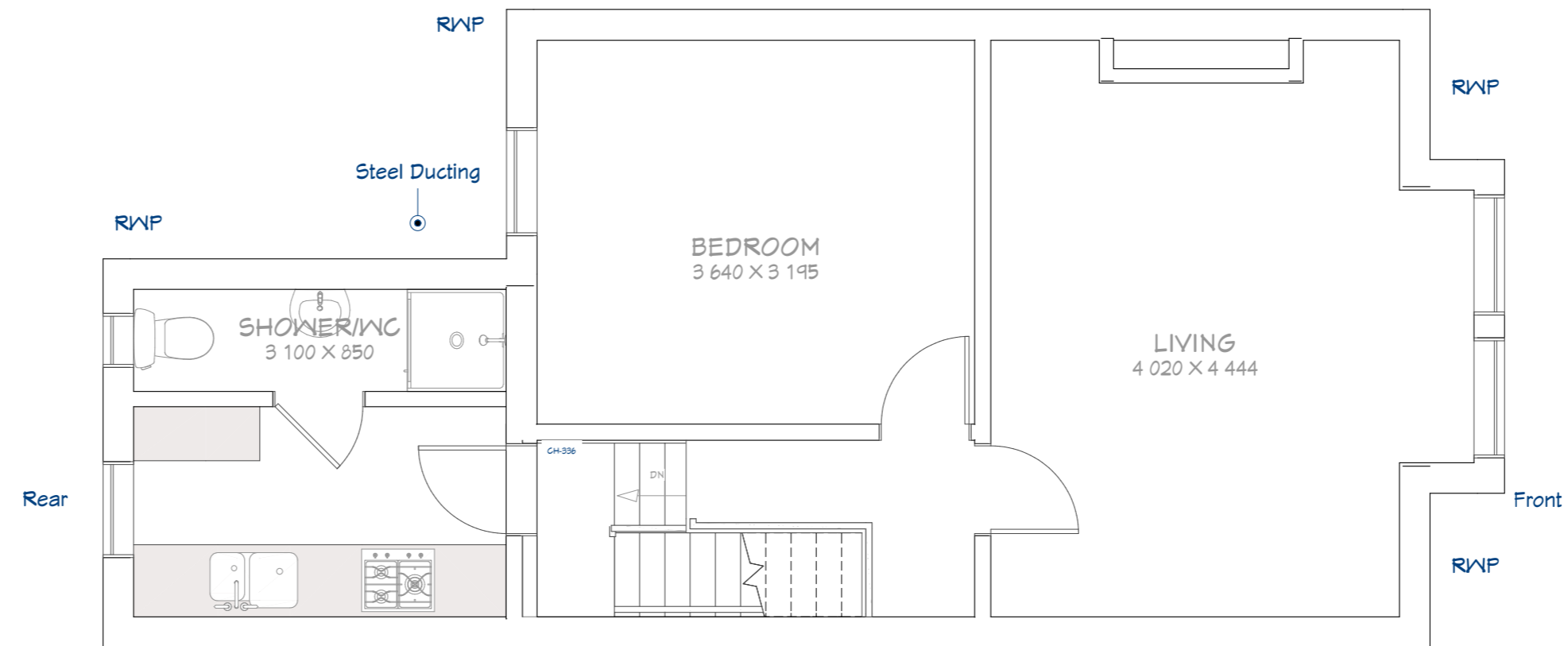

FIRST FLOOR AREA
48.9 SQ M

Existing First Floor Plan

Existing Floor Plans

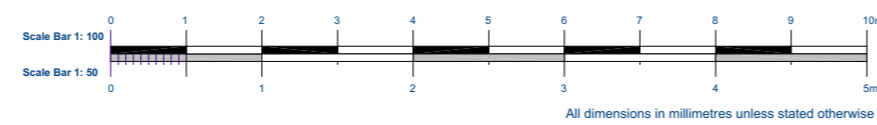

Title Existing Floor Plans		Drg No. 18.N181LB-2	Scale 1: 50 @A2 unless stated	Project Address 265a Fore Street First Floor Flat London N18 2TY
Date 06/02/2024	Drawn by: Shiraz Uddin	Client Arun Joshi	NOTES: 1. Contractor to check all dimensions on site and report any errors before commencing construction 2. This drawing to be read in conjunction with all other relevant drawings and specifications	
			Ikitect AI London Registered in England © Copyright UK	

