

IMPORTANT: THIS DRAWING IS NOT TO BE USED FOR CONSTRUCTION UNLESS SIGNED AND STAMPED SITE ISSUE.

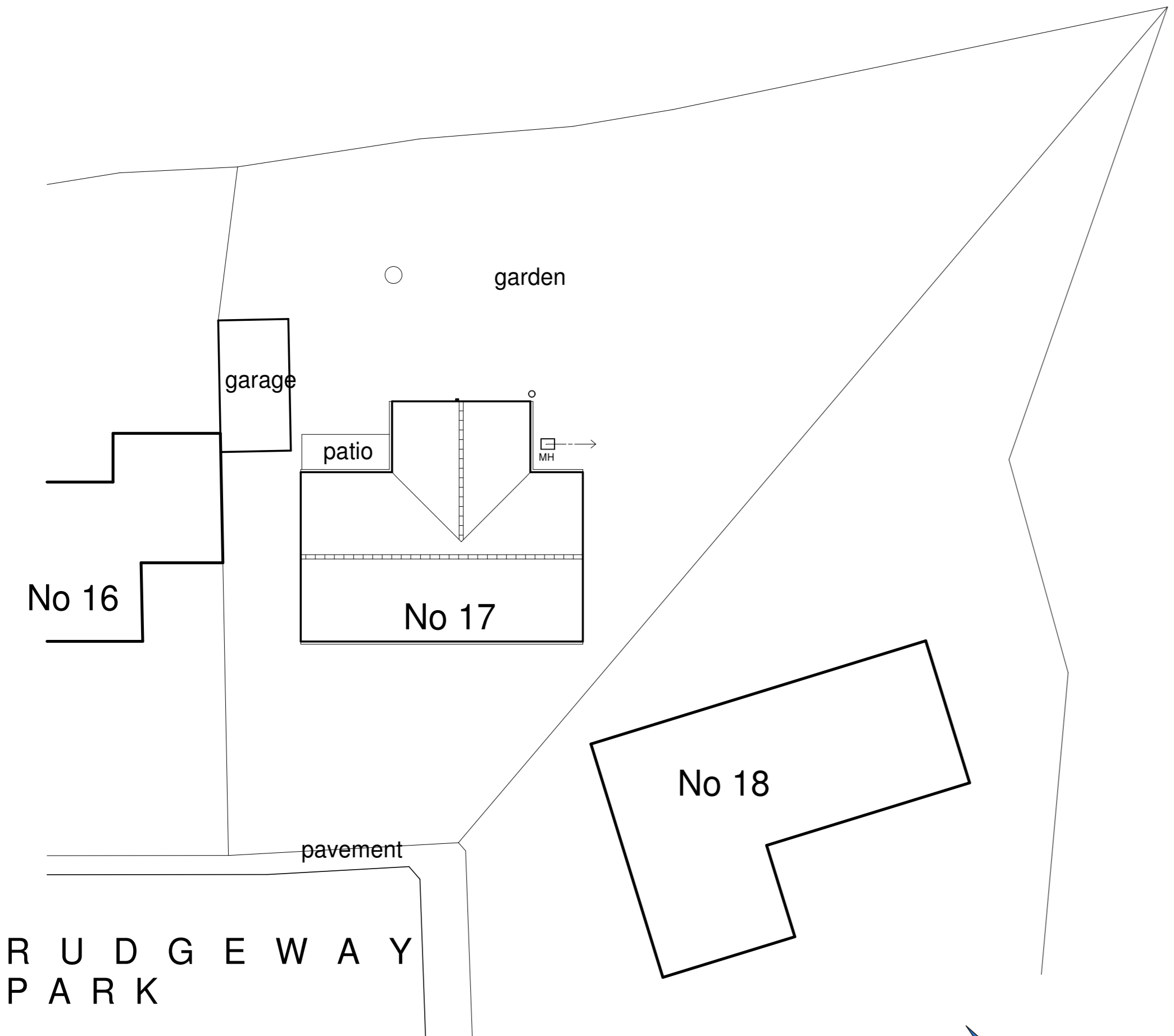

Existing Proposed Site Plan 1:200

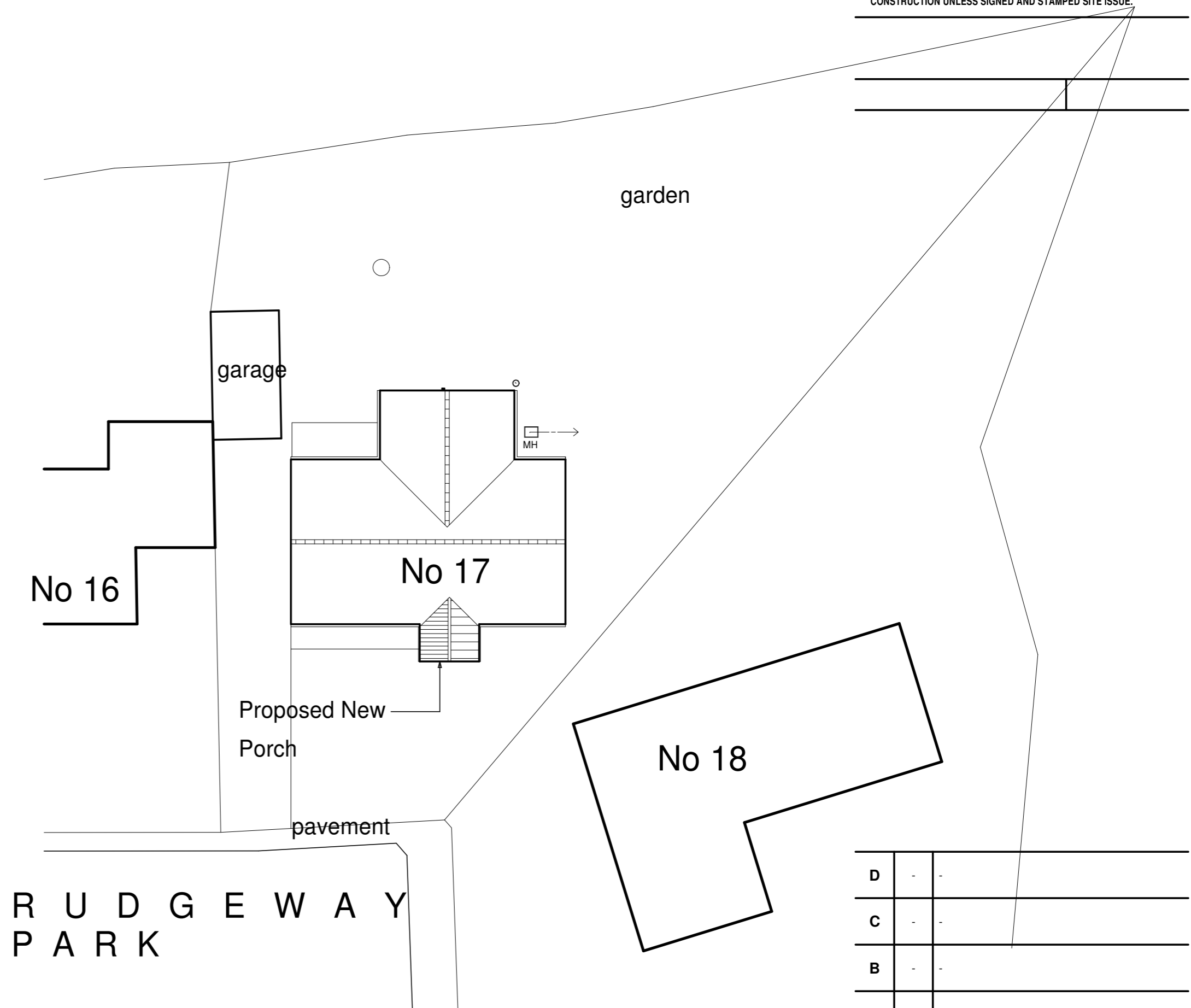

Proposed Site Plan 1:200

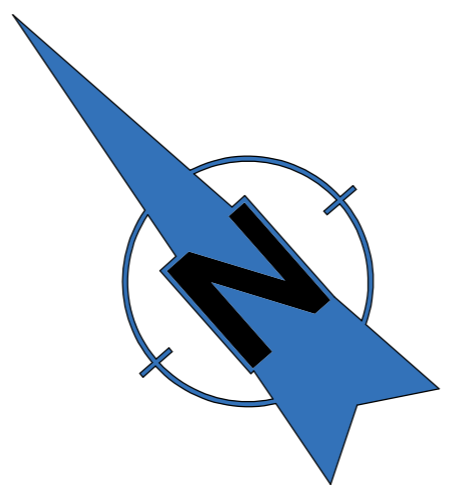

SCALE 1:200 @ A2

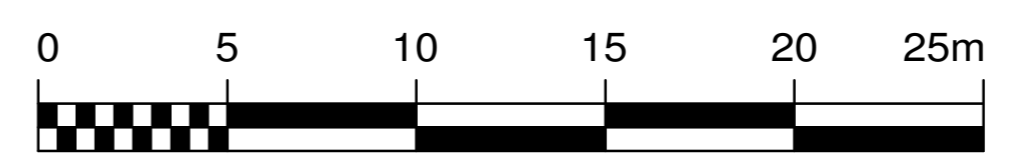

REV.	DATE	DESCRIPTION
D	-	-
C	-	-
B	-	-
A	APR24	PD Works omitted

R & J CONSULTANTS
ARCHITECTURE & DESIGN

R & J Consultants Ltd.
Tel: 0117 9565289 -- Mob: 07775 870051
Email: richardhopkins@rjconsultants.co.uk
Website: www.rjconsultants.co.uk

CIAT
CHARTERED PRACTICE

CLIENT
Mr. & Mrs. M. JOHNSON

PROJECT
17 RUDGEWAY PARK,
RUDGEWAY, Nr. THORNBURY,
BRISTOL, BS35 9RU

EXISTING & PROPOSED SITE PLANS

DRAWN	SCALE	DATE
RH	1:200 @ A2	MARCH 2024

PROJECT NO:	SHEET	REVISION
B 12271	02	A

This drawing is copyright © of R & J CONSULTANTS Ltd and must not be reproduced in whole or in part without written permission.