

20 KIRBY ROAD WALTON ON THE NAZLE
CO 14 8QZ

FLAT ROOF CONSTRUCTION WARM DECK

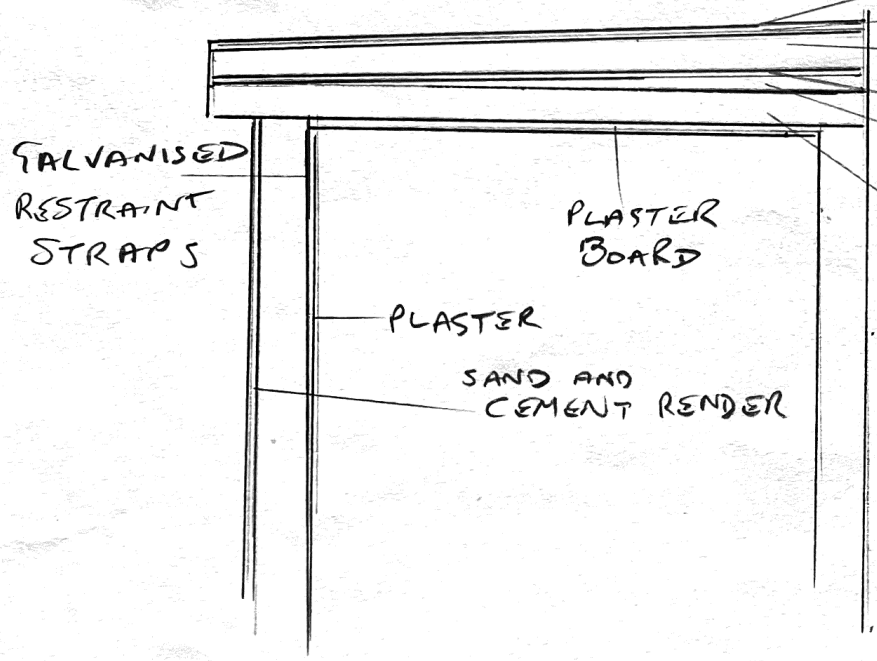

3 LAYERS HIGH PERFORMANCE ROOFING FELT
BS 747 HOT LAYED FULLY BONDED TO BS 8217
ON 39 UNDERLAY PARTIALLY BONDED
TO 130MM THICK CELLOTEX XR 4130
TO GIVE UVALUE OF 0.15W/M2K
ON VAPOUR BARRIER TYPE 13
LAID ON 18MM ROOF GRADE PLYWOOD
ON 50MM WIDE GALVANISED FIRING PIECES
TO GIVE 1-40 FALL ON 175MM X 50MM
JOISTS GRADE C24 AT 400MM CENTRES
WITH 1 LAYER OF 12.5MM PLASTER BOARD
CEILING SKIM COATED

SCALE 1 - 50