

1G LINTELS REF L1/S 100 WITH INSULATED CORE  
 3.2 MM SHEET THICKNESS

PROPOSED PLAN

BEARING AT ENDS MASS CONCRETE PADSTONE 300 LONG  
 G-RATE C30 CONCRETE MIN BEAM BEARING 150 MM

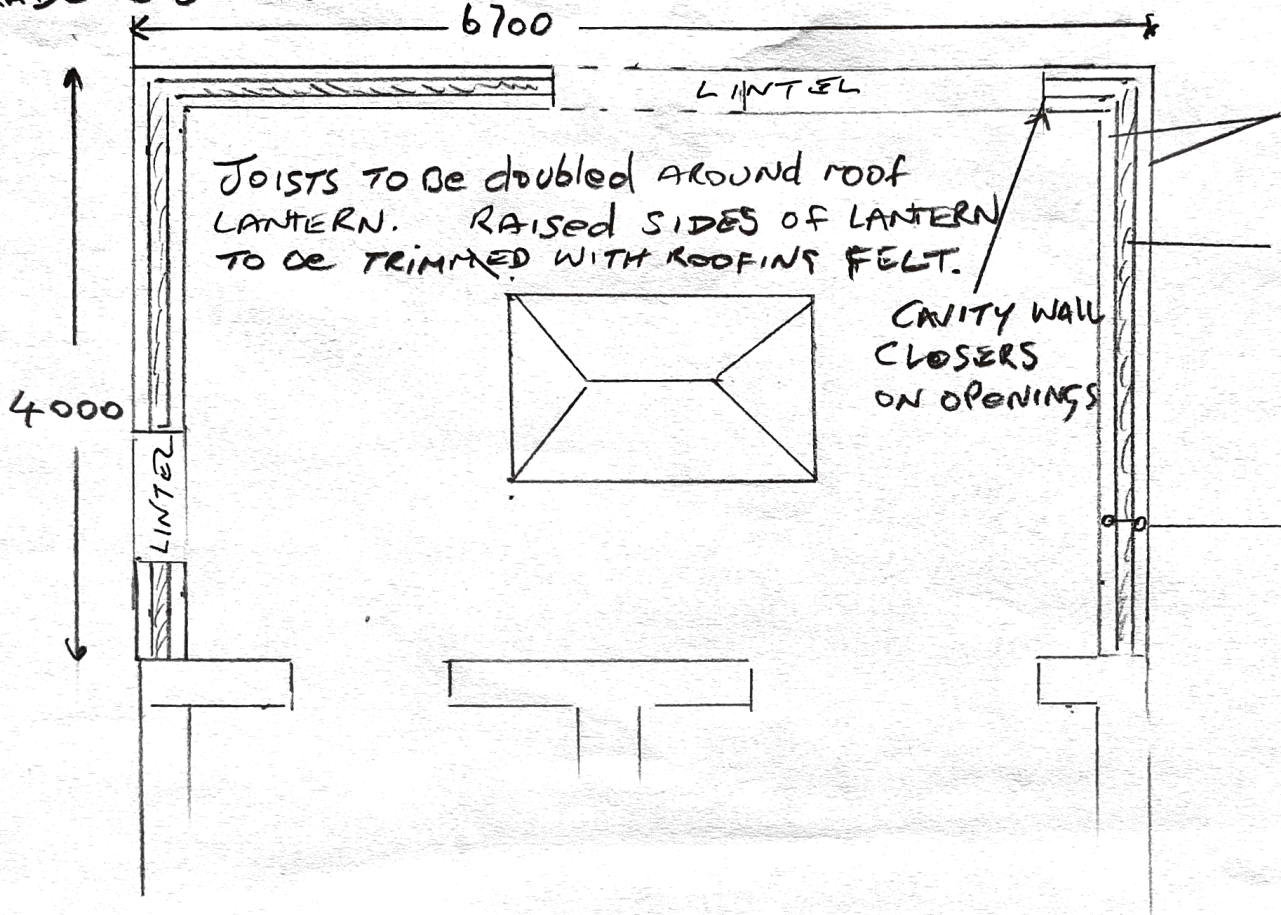

CELCON CONCRETE BLOCKS  
 7.3 NEUTONS

100 MM CAVITY WALL INSULATION  
 1200<sup>MM</sup> X 450 MM CELOTEX CW4050

TO GIVE A VALUE OF 0.18 W/M<sup>2</sup>K

225 MM CAVITY WALL TIES  
 SPACING 900 MM HORIZONTAL  
 450 MM VERTICAL  
 Doubled at openings

LIGHTING TO BE CONFIRMED  
 BUT WILL BE LED IP65  
 FIRE RATED DOWNLIGHTS  
 THAT MEET ALL RELEVANT  
 BRITISH STANDARDS AND  
 HAVE HIGHEST EFFICIENCY

ALL ELECTRICAL WORK WILL  
 BE UNDERTAKEN BY A  
 COMPETENT PERSON  
 IN ACCORDANCE WITH  
 BS 7671



SCALE 1 - 50