

DO NOT SCALE

* WIDTH TO SUIT RE-USE OF EXTG FRENCH DOORS & WINDOWS ETC (SUBJECT TO CONFIRMATION FROM THE BUILDING INSPECTOR THAT THE DOORS & WINDOWS ARE SUITABLE FOR RE-USE)

APPROX 700mm DEEP

1500 *1170 1165 *2665 1200

EXISTING LOW LEVEL WALLS RETAINED WHERE DEEMED ACCEPTABLE BY BUILDING CONTROL

EXTG FOUNDATIONS TO BE EXPOSED FOR THE APPROVAL OF THE BUILDING INSPECTOR

PROVIDE 1200 x 1200mm VELUX FLAT ROOF LIGHTS (OR SIMILAR) TRIM FLAT ROOF TO ENGINEERS DETAILS

EXTG DOORS / WINDOWS REMOVED & OPENING REDUCED IN SIZE TO SUIT REQUIRED REPLACEMENT DOORS - TO BE AGREED ON SITE WITH THE OWNERS

REST OF HOUSE NOT SURVEYED

INDICATES WALLS REMOVED TO ENGINEERS DETAILS

KITCHEN LAYOUT INDICATIVE ONLY. FINAL LAYOUT TO BE AGREED WITH THE OWNERS

NOTE REQUIREMENT FOR INTERNAL WALL SURFACES TO BE FINISHED WITH CELOTEX PL4040 INSULATED PLASTERBOARD

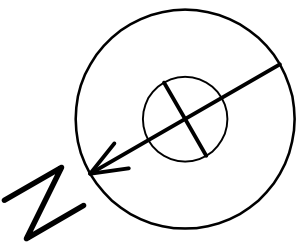

PROPOSED GROUND FLOOR PLAN

SCALE 1:50

FRONT

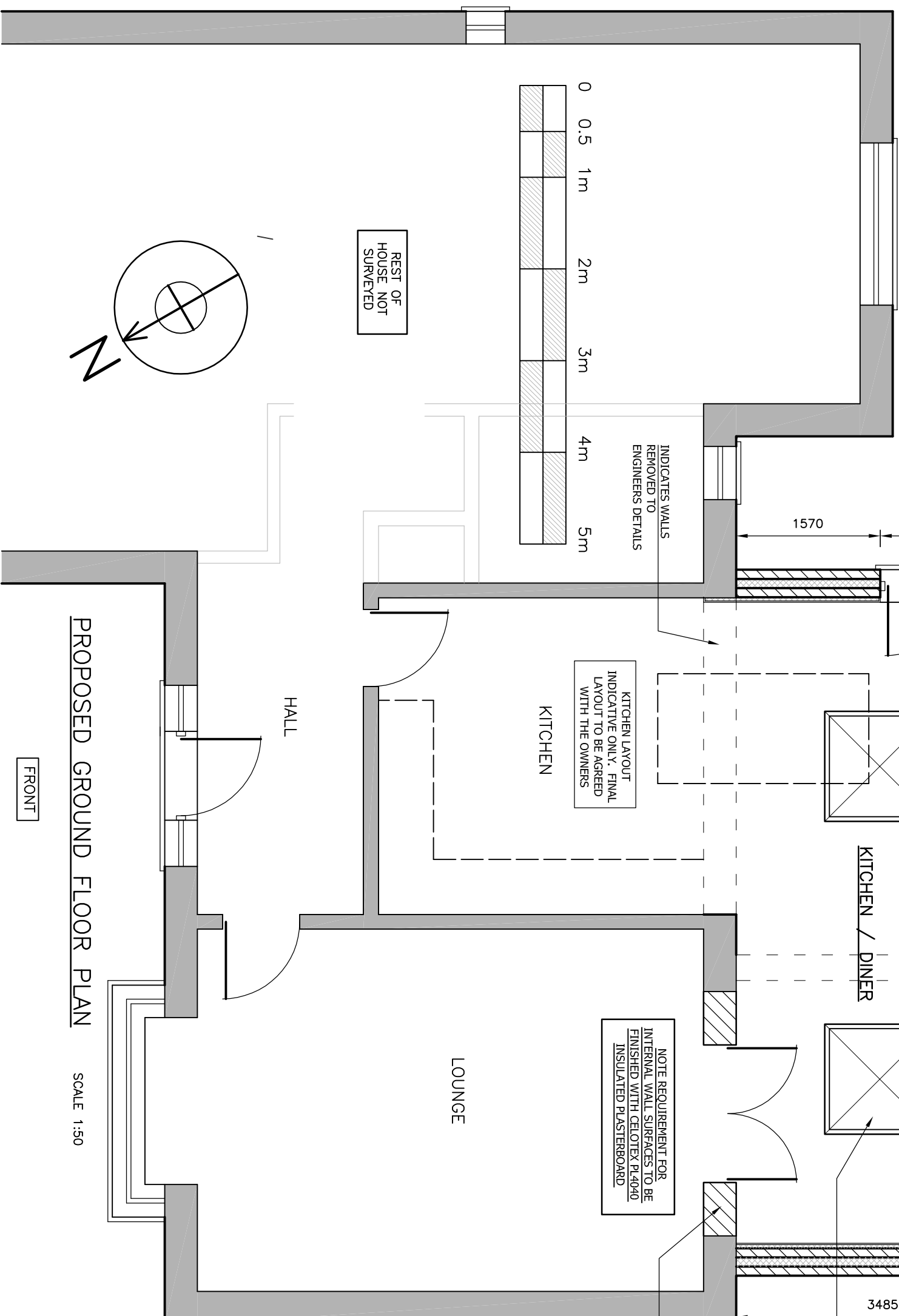

REVISIONS

REV	DATE	DESCRIPTION
A	MAR 24	MINOR AMENDMENTS
B	MAR 24	AMENDED FOR PLANNING VALIDATION

Ridgeway

Building Design Limited

Tel: 01621 810175

Mobile: 07946 743715

chris@ridgewaybuildingdesign.co.uk



AS SHOWN ON A3 Drawn C. ROBARDS Date MARCH 2024

Project 35 AVOCET PLACE, THORRINGTON, ESSEX CO7 8FH

Client MILLS & KIRBY LTD

Title PROPOSED SINGLE STOREY REAR EXTENSION & ALTERATIONS

Drawing No. 2636 - 02 B