

Proposed Lowest Storey (Level -1)

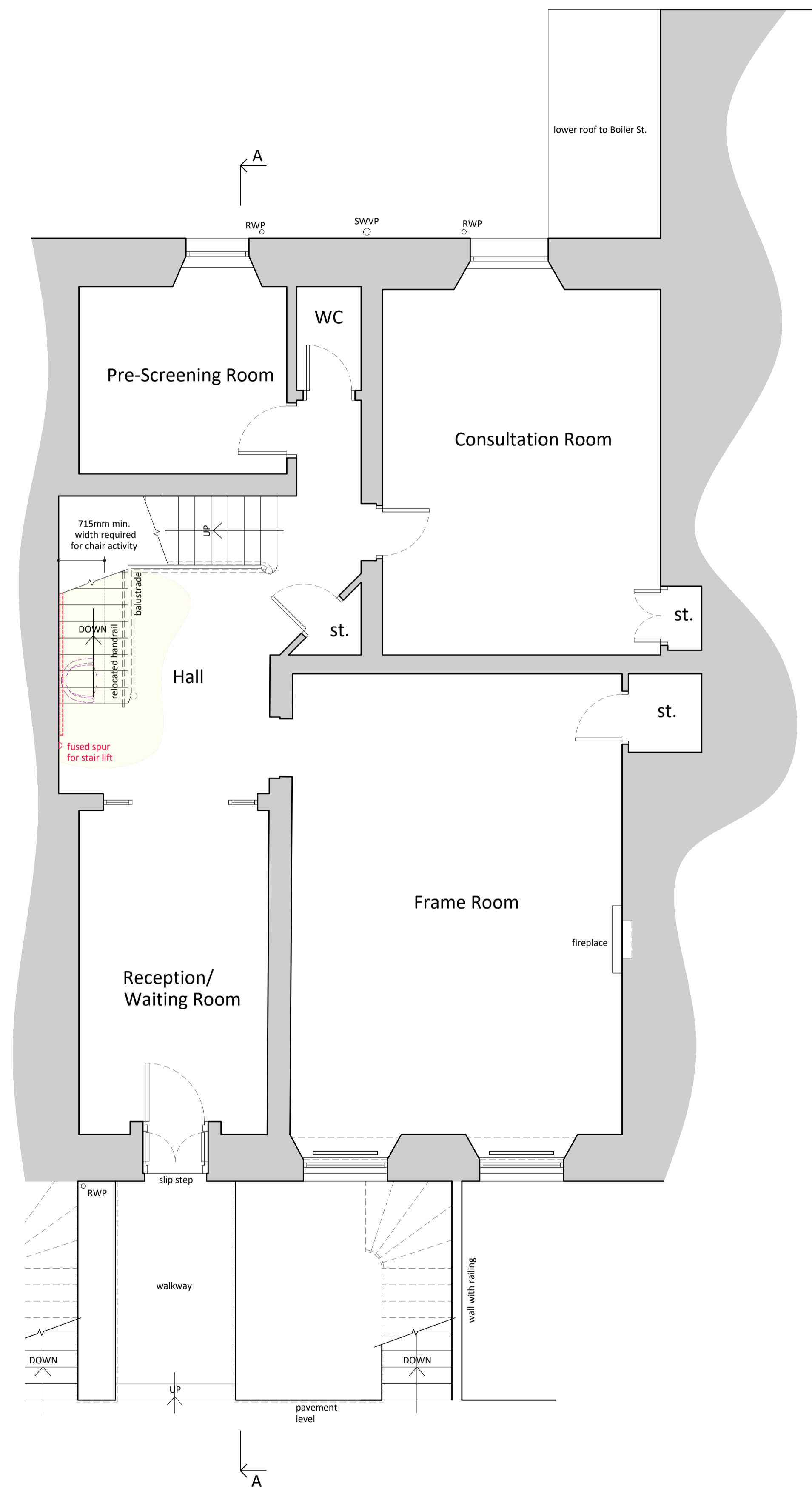
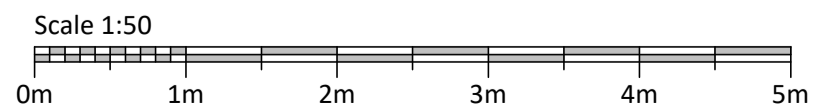

Proposed Ground Storey (Level 0)

- General Notes:**
- This drawing must be read in conjunction with all other drawings and specifications produced specifically for this project.
 - Any discrepancies found are to be brought to the attention of the building designer and/or Engineer at the earliest possible moment.
 - All dimensions given on this drawing are in millimetres, unless stated otherwise.
 - The contractor must check all sizes on site before proceeding with the works.
 - All works are to be completed in strict accordance with the Building Regulations for Scotland as per the approved drawings.
 - Where manufacturers' names are listed, they should be read as 'equal and approved'.
 - The Contractor will allow for all necessary precautions to be undertaken to satisfy HSE requirements, including ensuring all construction risks including the use of hazardous materials are fully assessed, clearly highlighted and adequate safety measures are put in place to ensure the safety of the workforce, client and public at all times.
 - Works shall be carried out in accordance with good building practices.
 - All works to comply with the Building(Scotland) Act 2003, the Building (Scotland) Regulations 2004 and all current amendments.
 - The Contractor shall be responsible for contacting the appointed Building Standards inspector as soon as works commence in order to establish the Local Authority's policy for carrying out inspections and witnessing the testing of drainage inspections. The Contractor is responsible for giving notice, arranging and carrying out the required inspections to the satisfaction of the Local Authority. Work must not be covered over and concealed before the inspection takes place or the tests are witnessed.
 - If in doubt, stop and ask.
 - The Contractor is to satisfy himself as to the location of all overhead and underground services on site prior to the commencement of works.
 - The Contractor is advised to expose all underground services by hand.
 - The Contractor is responsible for notifying the building designer of any services below or adjacent to the building footprint.

Rev'n	Date	Description	By

© DX2 Consultancy Ltd 2013. All rights reserved.

Project / Client:
Proposed Alterations to Offices at 5 St. Vincent Street, Edinburgh for Cameron Optometry

Drawing Title:
Floor Plans (Levels 0 and -1): Proposed

Architectural Services and Technical Construction Specialists

A: 317 Rona Place, Glenrothes, Fife, KY7 6RR
 T: 07925-372034 / 07925-130388
 E: enquiries@DX2consultancy.com
 W: www.DX2consultancy.com

Project Reference: 20-040-Cameron_Optometry	Scales: 1:50	Date: Mar 24
Drawing Number: 24-20/040-049	Sheet size: A1	Drawn: k.h.b
	Revision: -	Checked: d.d.g