

THE CONTRACTOR IS RESPONSIBLE FOR CHECKING ALL DIMENSIONS ON SITE. ANY DISCREPANCY SHOULD BE REPORTED TO THE CONSULTANT PRIOR TO COMMENCEMENT OF ANY WORKS.
IT IS THE CONTRACTOR'S RESPONSIBILITY TO DETERMINE THE LOCATION OF ALL UNDERGROUND SERVICES.
THIS DRAWING IS COPYRIGHT AND IS NOT TO BE REPRODUCED WITHOUT WRITTEN CONSENT OF THE PARTNERSHIP.

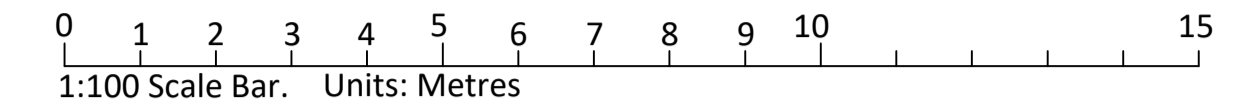

UNDERGROUND STORM DRAINAGE
The existing storm drainage system will be retained. The roof area is the same as the existing roof area so there will be no change in the rainwater collection area.
Existing rainwater pipes will be replaced with new in the same location as existing. The rainwater specification will be compatible with the roof and gutter specified elsewhere.

BELOW GROUND DRAINAGE FOUL AND STORM
Carry out site investigation to verify locations, depths and flow directions of existing drainage system. Notify the Architect of discrepancies with the drawings. Where existing runs will be under the new buildings maintain in use at all times unless it can be confirmed that they are no longer in use. Seal off ends of disused pipes.

Underground foul drainage shall consist of 100 mm Ø uPVC pipes laid to minimum falls of 1 in 80, and draining to new manholes and access chambers, bedded on at least 100 mm of granular fill, with the fill taken up to at least half the depth of the pipe.

Drain runs with cover less than 1200 mm under the car park, and 600 mm elsewhere, are to be provided with extra protection from damage by means of a reinforced concrete slab, laid over the trench on compressible filler. The slab is to extend at least 300 mm beyond each side of the slab. The pipe will be surrounded by pea-gravel, with at least 75 mm over.

Access chambers to be of proprietary manufacture where the invert is less than 900 mm below ground level, installed in accordance with the manufacturer's recommendations. For deeper manholes construction is to consist of 200 mm thick concrete slab, walls of precast concrete ring sections, with sand cement benching to channels, and tops consisting of concrete slabs with cast iron covers (heavy duty to parking areas and roads; medium duty elsewhere). Galvanised mild steel step irons to be provided to sides of manholes where they are deeper than 900 mm. Internal diameters to be not less than 1050 mm for manholes under 1.5 m deep, otherwise 1200 mm diameter.

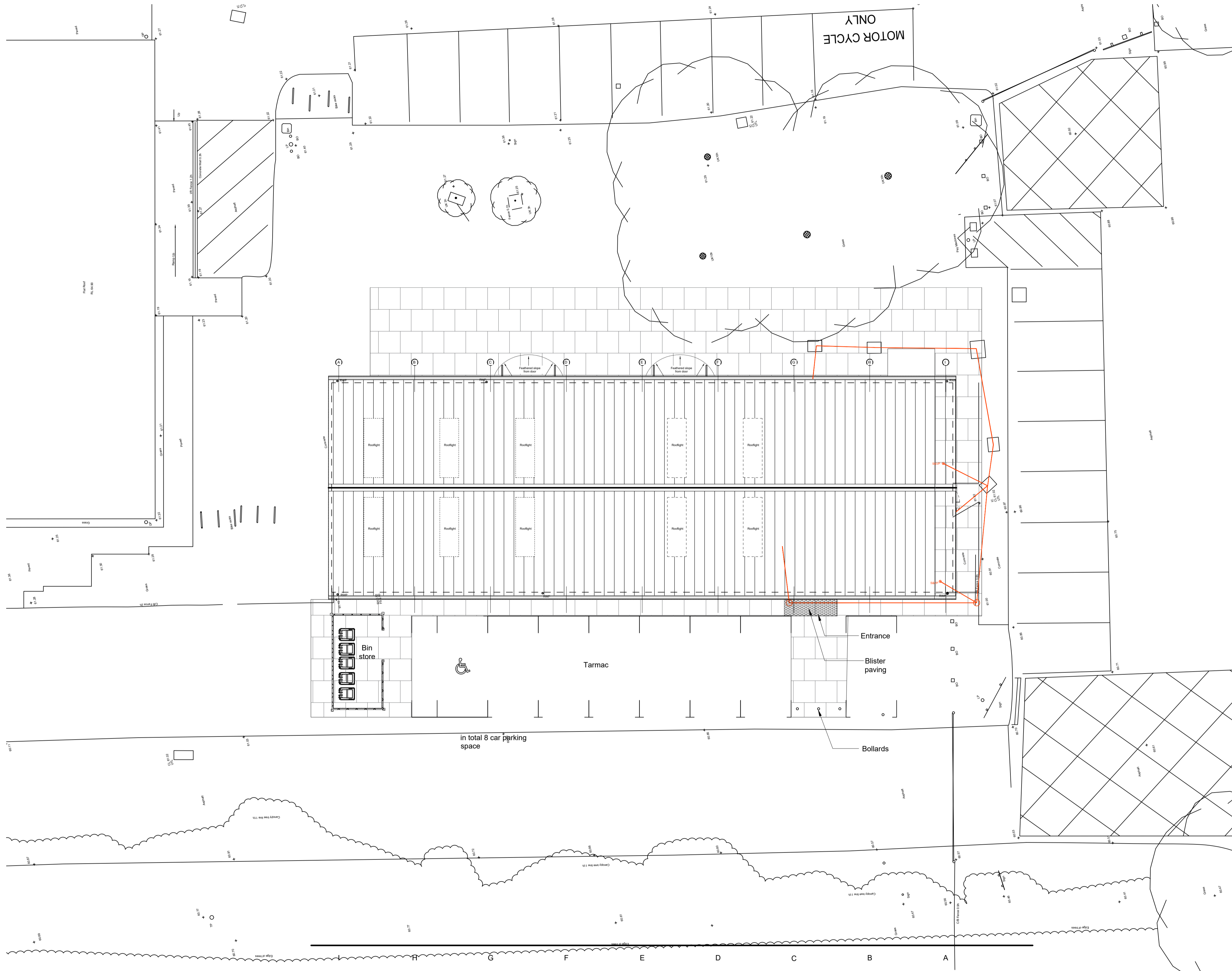

C - Add Scale Bar. 15/01/24
REVISION DATE

PROJECT:
Community and Spiritual Centre
Court place Farm, Marston
CLIENT:
Paul Harris

DRAWING:
Site Plan

DRAWING NUMBER:
5550/43/C

SCALE @ ALL DATE
1:100 05/12/23

DRAWN CHECKED
MEJA



Bricknells Barn
32 Lime Avenue
Eyton
Daventry
Northamptonshire NN11 3PG
t: (01327)260585 f: (01327) 262353
enquiries@rogercoy.co.uk
Roger Coy Partnership Ltd Reg.No.8569981