

THE CONTRACTOR IS RESPONSIBLE FOR CHECKING ALL DIMENSIONS ON SITE. ANY DISCREPANCY SHOULD BE REPORTED TO THE CONSULTANT PRIOR TO COMMENCEMENT OF ANY WORKS.
IT IS THE CONTRACTOR'S RESPONSIBILITY TO DETERMINE THE LOCATION OF ALL UNDERGROUND SERVICES.
THIS DRAWING IS COPYRIGHT AND IS NOT TO BE REPRODUCED WITHOUT WRITTEN CONSENT OF THE PARTNERSHIP.

0 1 2 3 4 5 6 7
1:50 Scale Bar. Units: Metres

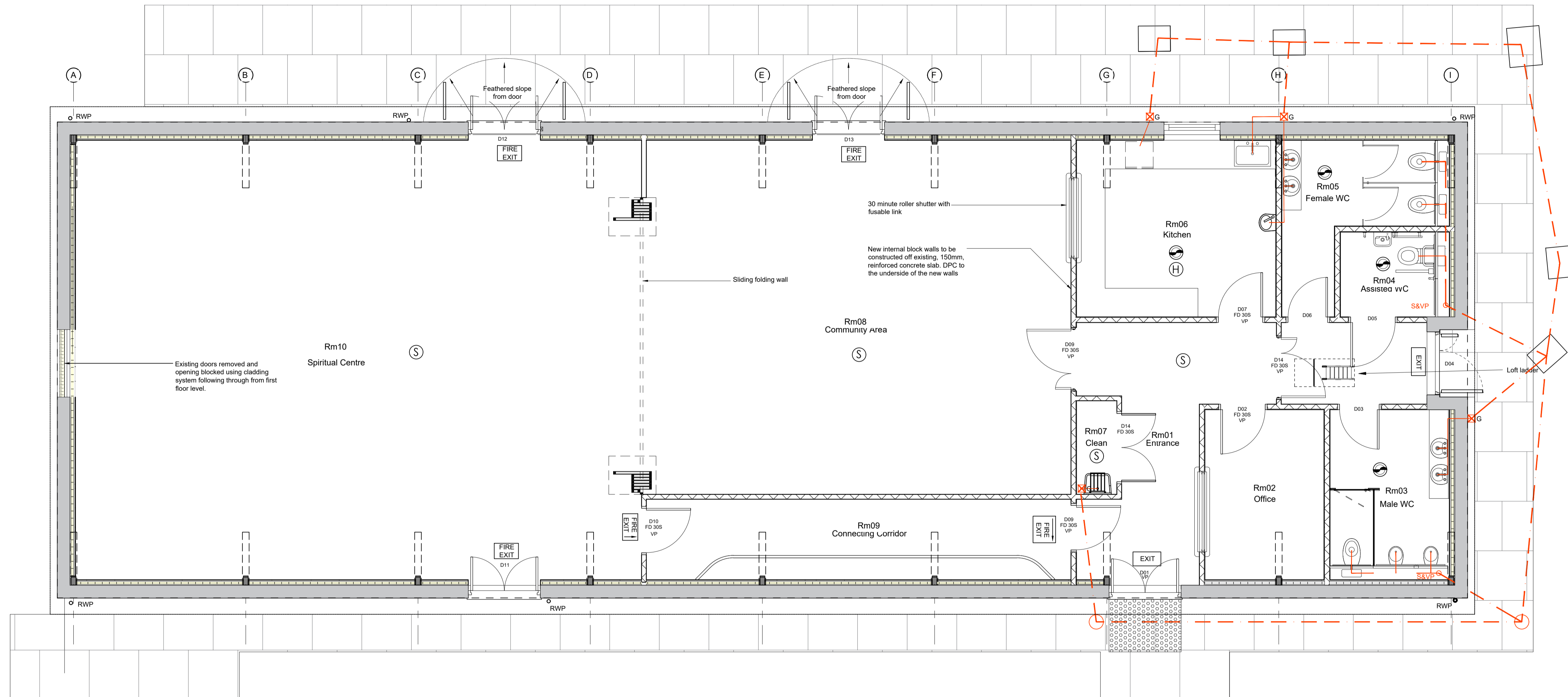

INTERNAL GROUND FLOOR WALLS

The internal ground floor walls are to consist of 100 mm thick concrete blockwork as indicated on the drawings, built off existing 150mm reinforced concrete slab. Slab to be examined for suitability by the structural engineer. Walls to be finished both sides with 13mm 2 coat gypsum plaster or to be fair face painting quality to client choice.

FIRE

Ironmongery to doors on fire escape routes shall be easy to open at all times, from the risk side. Emergency exit hardware for areas with up to 50 occupants shall comply with BS EN 179. Hardware in areas to which the public have access shall comply with BS EN 1125.

Doors designated FD30S on the plans, are to be 1/2 hour, and combined intumescent strip and smoke seals recessed into the frame. Fire doors with the 'VP' suffix are to have vision panels. Fire doors with the 'KS' suffix denotes keep shut or keep locked shut.

Emergency light outside fire exits.

"Fire door keep clear" sign fixed externally to fire doors.

BS 5266 emergency lighting guidelines recommend varying illuminations, depending on the location of the lighting. Floor level: lighting of no less than one lux
Anti-panic areas: lighting of no less than 0.5 lux. Escape routes less than 2 metres wide should be lit using minimum one lux lighting.

SAFETY

Guarding to be provided where the door swings across the external paving. The guarding is to consist of 50 mm diameter tubular steel, formed into an 'n' shape 750 mm wide and up to 750 mm above pavement level. The ends of the tubes to be set in concrete below pavement level, and the pavement finishes to be brought up to the tubes. Tubes to be finished to match the windows and doors.

FIRE ALARM AND SMOKE DETECTORS.

Provide Mains operated self-contained smoke alarms in compliance with BS5839-1 & Building Regulation AD'B' vol.2 - 2019 Edition. Facility must be protected by an electrically operated automatic fire detection and alarm system in accordance with BS 5839-1 to at least Category L1-5 standard assessed under Purpose Group 4 'Shop & Commercial'. Alarm system call points if required must comply with either (a) BS 5839-2 (b) BS EN 54-11 Type A (direct operation) and installed in accordance with BS 5839-1.

Mains units with secondary power supply are acceptable. They should be permanently wired to a separately fused circuit at the distribution board, and may operate at a lower voltage via a mains transformer. Wiring must be in accordance with IEE. Regulations but need have no special fire surviving properties. Smoke alarms must be positioned in circulation & seating areas and close to Kitchen/Servery. Smoke alarms fixed to ceilings should be located minimum 300mm from any wall or electrical fitting. A central position is preferable. Units designed for wall mounting should be fixed 150-300mm below ceiling. Smoke alarms should be located for ease of maintenance.

Fire detection and alarm system to be designed, installed & maintained by specialist supplier/contractor being third party certified. A design, installation & commissioning certificate is to be provided for Building Control approval.

DISABLED FACILITIES

Disabled access to the building is to be provided by dropped kerbs between the car park and the pavement, and a level threshold at the main entrance door. The main entrance door is an 1800 mm wide double leaf doorset to achieve a clear opening of one leaf of at least 800 mm.

Doors within the building generally are to be 900 mm wide single leaf doorsets (clear opening at least 750mm), with a 1000 mm single leaf door set to the DAP WC.

The door to the Disabled Persons WC is outward opening. The WC is to the minimum standard to allow wheelchair users room to manoeuvre.

Fit out the Disabled Persons WC with 'Armitage Shanks' Doc M Pack, or similar, to include all necessary rails and equipment, as required by App. Doc. M3.

WINDOWS AND DOORS

Glazing safety
All glazing in critical locations shall be in toughened or laminated glass. Critical locations are defined as any where within 800 mm of floor level; and within 1500 mm of floor level to doors and within 300 mm of the sides of a door.

All doors marked VP on the drawings shall contain a vision panel, with glazing at least between 900 and 1500 mm above the floor.

The external windows and doors are to be constructed in polyester powder coated aluminium, colour to be confirmed, incorporating factory sealed double glazed units with low-E glass and minimum 16 mm gap between panes to achieve a 'U' value of no worse than 1.80 W/sq.mK. The low-E glass is to have soft coating with emissivity no higher than 0.1.

New operable windows are to be fitted with restraints to limit the opening to 100 mm.

Glazed doors at ground floor level are to receive manifestation at 1500 mm above floor level.

Where outward opening doors swings across the external paving, provide a 50 mm diameter tubular steel guarding, formed into an 'n' shape, 750 mm wide and up to 750 mm above pavement level, to prevent collision with pedestrians. The ends of the tubes to be set in concrete below pavement level, and the pavement finishes to be brought up to the tubes.

Bollards are to be provided outside doors as shown.

C - Add Scale Bar. Coloured line for external drainage - 15/01/24

REVISION DATE

PROJECT:
Community and Spiritual Centre
Court place Farm, Marston
CLIENT:
Paul Harris

DRAWING:
Ground Floor Plan as Proposed

DRAWING NUMBER:
5550/40/C

SCALE @ ALL DATE
1:50 20/12/23

DRAWN CHECKED
MEJA



Bricknells Barn
32 Lime Avenue
Eyton
Downton
Northamptonshire NN11 3PG
t: (01327)260585 f: (01327) 262353
enquiries@rogercoy.co.uk
Roger Coy Partnership Ltd Reg.No.8569981