

Old Quad Staircase 1-7 and Tower

Room Ref.	Room Name
1.7	Porters' Lodge
1.7a	Porters' Office
1.8	Fellow's Office
1.9	Communal WC
1.ST	Stair
2.7	Fellow's Office
2.7a	Fellow's Office - Ancillary
2.7b	Plant
2.8	Communal WC
2.9	Scouts' Store
2.ST	Circulation
3.1	Junior Common Room
3.2	Ward Perkins Room
3.10	Scouts' Cleaning Store
3.ST	Stair
4.1	Fellow's Office
4.1a	Fellow's Office - Ancillary
4.2	Shared Office / Research Centre
4.2a	Shared Office - Ancillary
4.2b	Shared Office - kitchenette
4.8	WC
4.12	Scouts' Cleaning Store
4.ST	Stair
5.1	Fellow's Office
5.1a	OxNet Administrator
5.6	Academic Office 1
5.7	Academic Office 2a
5.7a	Academic Office 2b
5.8	Academic Office 3
5.9	Academic Office - Store
5.10	Plant
5.ST	Stair
6.1	Staff Room
6.2	Communal WC and Shower
6.3	The Rookery
6.3a	The Rookery - Kitchenette
6.11	Lobby
6.12	Plant
6.ST	Stair
7.1	Stationery Cupboard
7.ST	Stair
BR.1	Broadgates Hall - SCR Common Room
BR.2	Kitchenette
BR.3	Breakout area
BR.4	Accessible WC
BR.5	Lobby
BR.6	WC
T.12	Postal store
T.13	Parcel store
T.13a	Porters' store
T.ST	Stair

Staircase 8

Room Ref.	Room Name
8.16	WC - Male
8.17	Circulation
8.18	WC
8.19	WC - Female
8.20	Fellow's Office
8.21	Samuel Holt Monk Room
8.22	Mary Hyde Eccles Room
8.ST1	Stair
8.ST2	Basement Stair

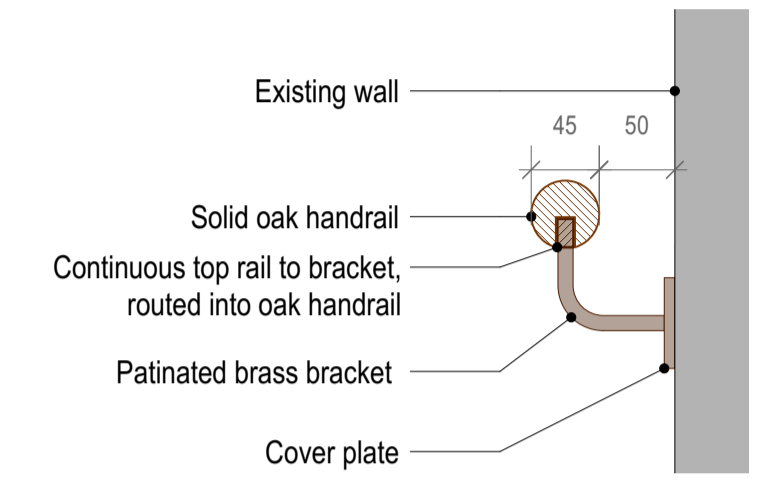
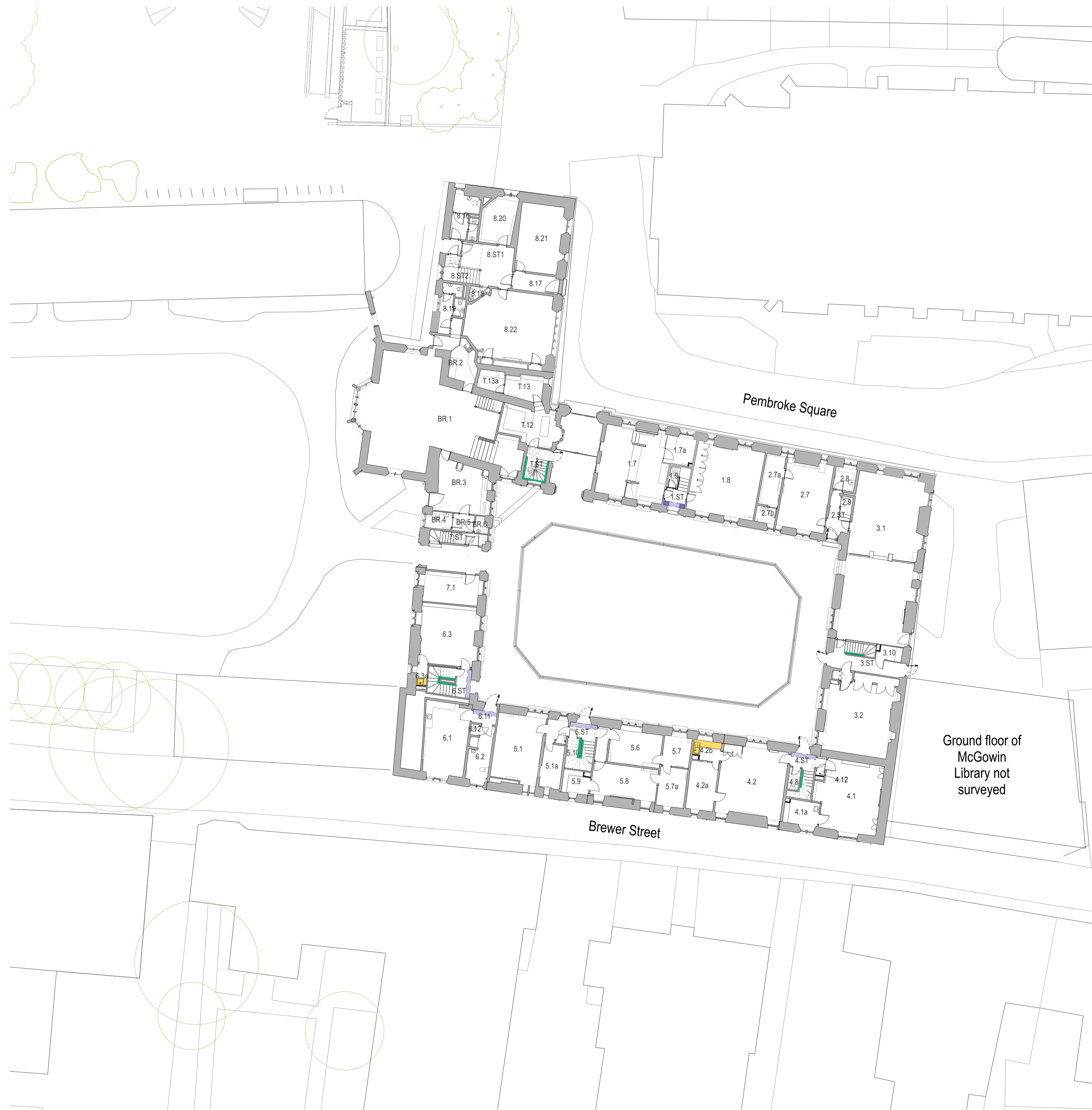

Typical bracket detail (section view)
1:5 @ A1

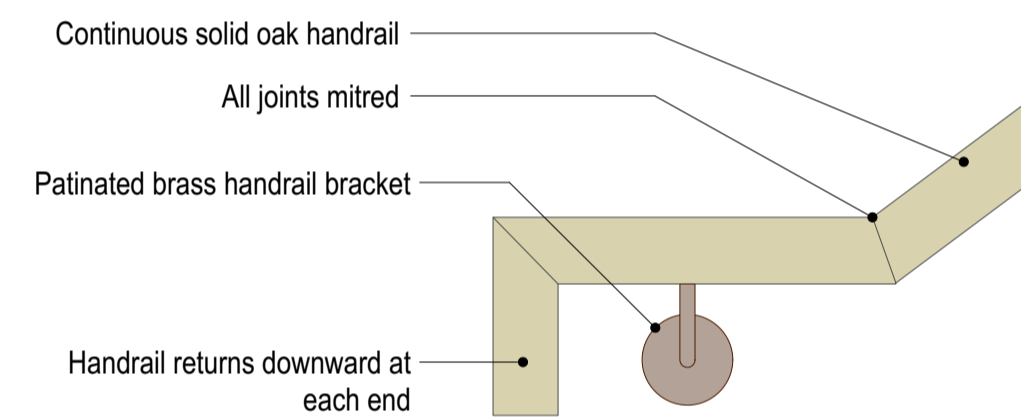

Typical handrail joint and termination detail (elevation view)
1:5 @ A1

- Key**
- Kitchenette
 - Half-height joinery within bathrooms to conceal services
 - Joinery to conceal services - full height
 - Joinery to conceal services - high level only
 - Fire rated enclosure for electrical services
 - Mirror
 - Flush mirror integrated with concealed storage behind (push to open)
 - New handrail to stair. Refer to large-scale details on drawing 2313-PR-1601

Notes

0 5 10 15 20 M

Rev Date	Amendment
15.03.24	Issued for Planning

Checked by TL	Scale 1:200@A1	Date Drawn 04.12.23	Job No. 2313
Drawing No. PD-1601		Revision -	

© This drawing is copyright. Check dimensions on site

WALTERS & COHEN ARCHITECTS

Pembroke College Rokos and Old Quad

2 Wilkin Street
London
NW5 3NL
mail@waltersandcohen.com

Telephone 020 7428 9751

PLANNING

FF&E Scope - Ground Floor