

GENERAL NOTES

1. Do not scale from this drawing.
2. Print this drawing in colour.
3. This drawing is to be read in conjunction with all other MXF documents (drawings, schedules and specifications) along with other design team documentation.

PROJECT SPECIFIC NOTES

1. Radiators shown are in typical sizes of Series Planar H
2. Final radiator sizes to be confirmed for planning
3. It is assumed towel heaters will be replaced with direct electric heaters where existing LTHW towel heaters exist
4. For internal distribution of pipework refer to typical staircase drawing J7411-MXF-SS-00 to 2F - DR-M00100
5. Where service routes cross fire compartmentation lines, as defined by a fire specialist, suitable firestopping is to be installed to comply with the fire strategy. Further site investigation and a scope of opening up works are proposed to establish the extent of existing concealed installation and enable co-ordination to be completed.

KEY

- Radiator (minimal intervention to existing pipework)
- Radiator (significant intervention - new pipework)
- Pipework at High Level
- Pipework at Low Level
- Concealed heater (in floor or joinery)

- F/A From Above
- T/B To Below
- F-R Flow and Return
- TOW Towel Heater

 Additional radiators required to meet the design heat load for room following detailed review

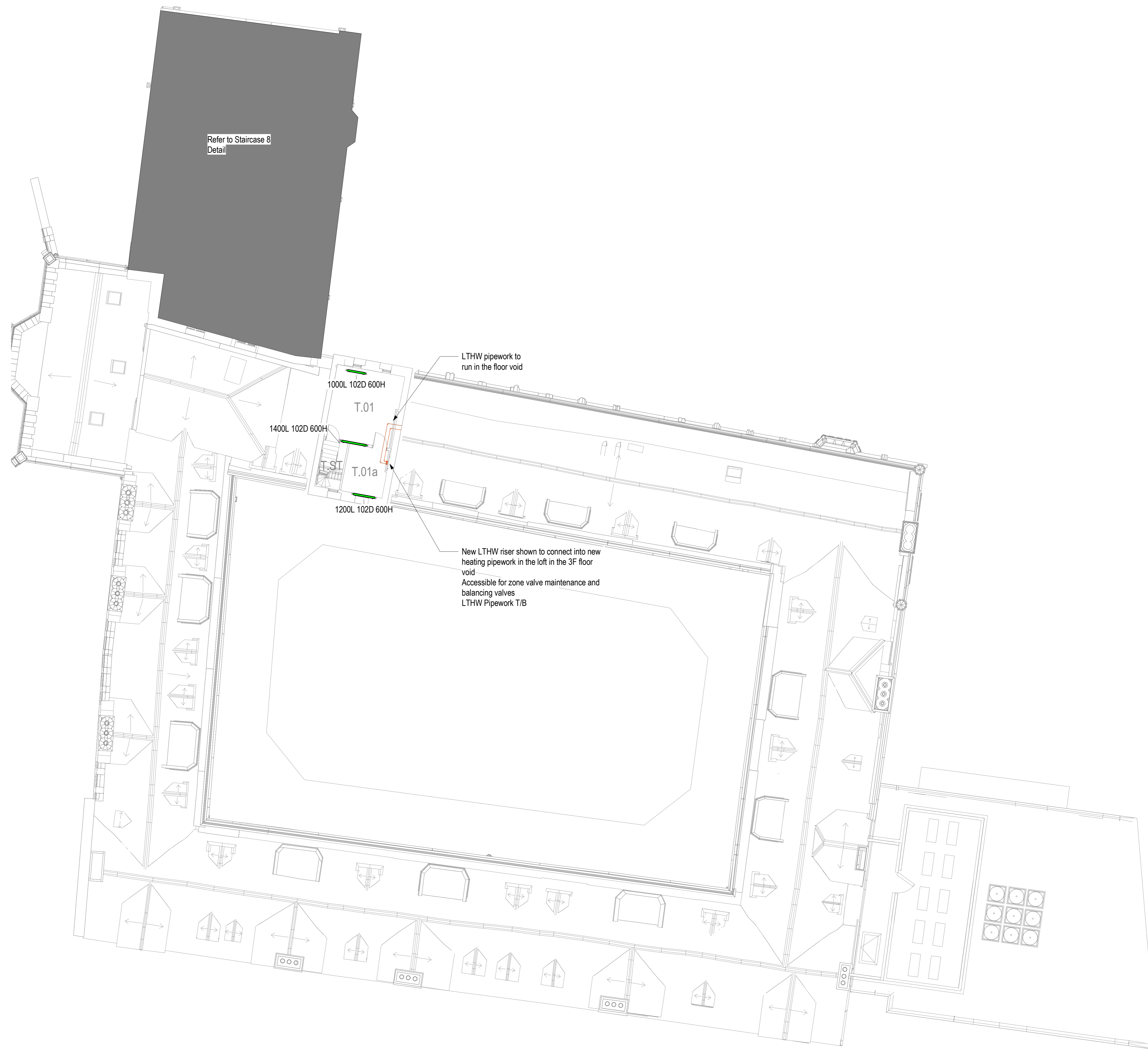

1 500 - Heating (Detail) - Level 03 (Tower) - Old Quad
1 : 100