

Roof vents added to cold roof - as necessary to comply with British Standards

Existing loft insulation repaired and additional insulation added  
Refer to 2313-PD-1925 (Roof Insulation Scoping)

**Old Quad Section AA**  
Staircase 3  
1:50@A1

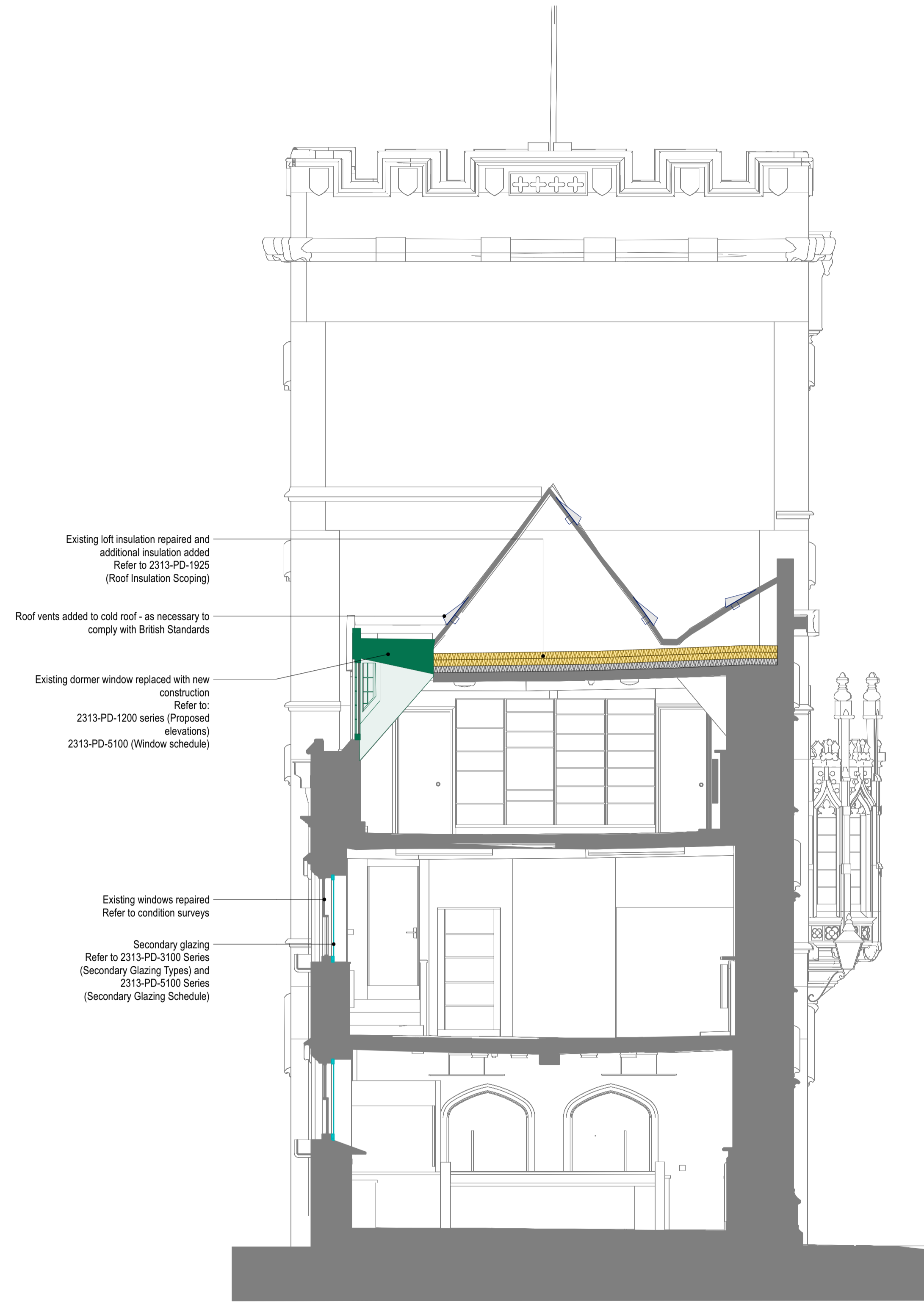

Existing loft insulation repaired and additional insulation added  
Refer to 2313-PD-1925 (Roof Insulation Scoping)

Roof vents added to cold roof - as necessary to comply with British Standards

Existing dormer window replaced with new construction  
Refer to:  
2313-PD-1200 series (Proposed elevations)  
2313-PD-5100 (Window schedule)

Existing windows repaired  
Refer to condition surveys

Secondary glazing  
Refer to 2313-PD-3100 Series (Secondary Glazing Types) and 2313-PD-5100 Series (Secondary Glazing Schedule)

**Old Quad Section BB**  
Staircase 1  
1:50@A1

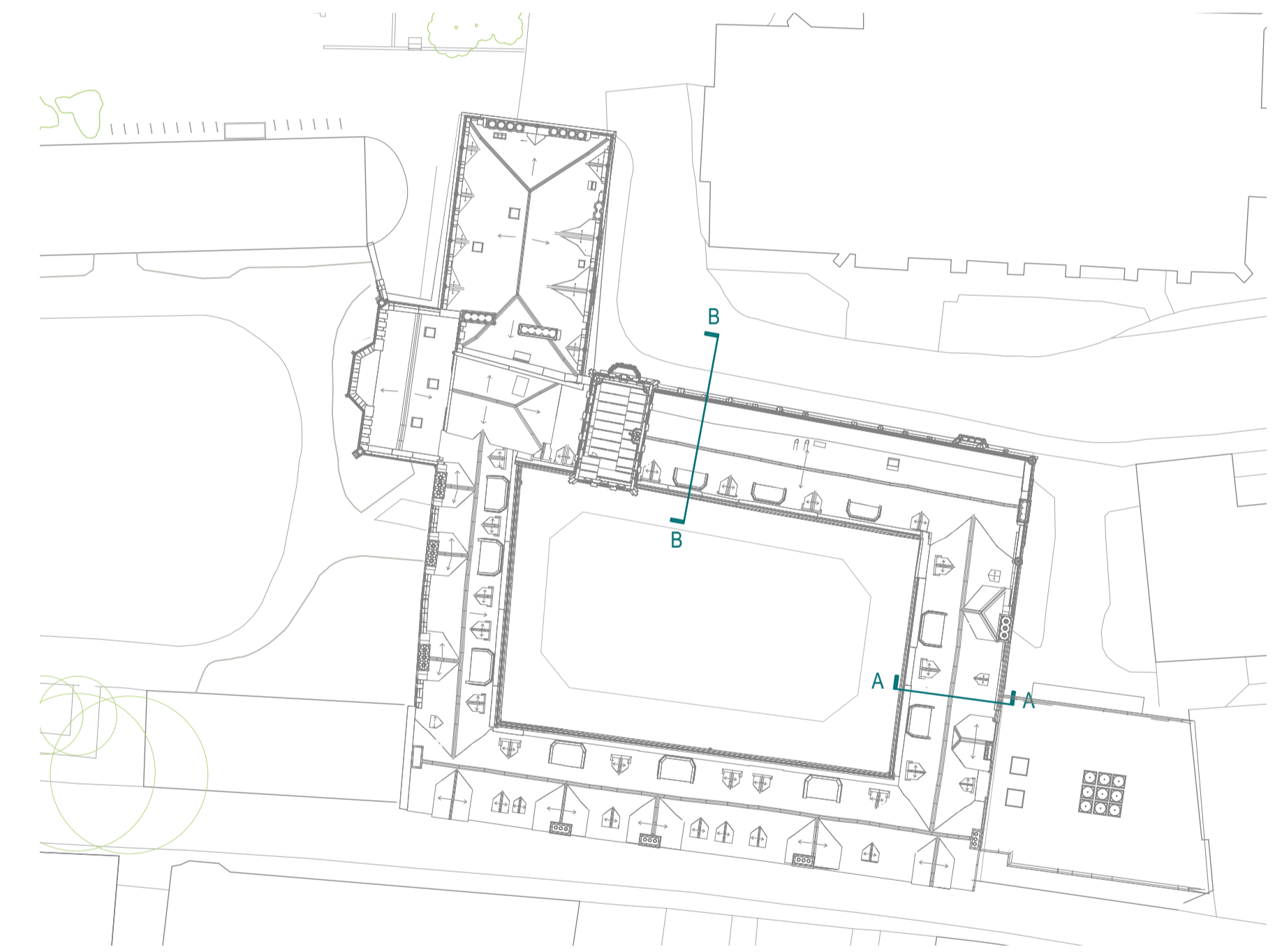

**Key Plan**  
NTS

**Key**

Insulation

Secondary glazing

New external door

Other proposed fabric

**Notes**



| Rev      | Date     | Amendment           |
|----------|----------|---------------------|
| 15.03.24 | 15.03.24 | Issued for Planning |

**WALTERS & COHEN ARCHITECTS**

**Pembroke College - Old Quad & Rokos**

2 Wilkin Street  
London  
NW5 3NL

Telephone 020 7428 9751  
mail@waltersandcohen.com

**Proposed Sections - Old Quad 1of2**

| Checked by | Scale     | Date Drawn | Job No. | Drawing No. | Revision |
|------------|-----------|------------|---------|-------------|----------|
| TL         | 1:50 @ A1 | 04.09.23   | 2313    | PD-1100     | -        |

© This drawing is copyright. Check dimensions on site

**PLANNING**