

GENERAL NOTES

1. Do not scale from this drawing.
2. Print this drawing in colour.
3. This drawing is to be read in conjunction with all other MXF documents (drawings, schedules and specifications) along with other design team documentation.

PROJECT SPECIFIC NOTES

1. Plant layout subject to further co-ordination.
2. All LTHW pipework in loft is to be rigidly fixed on unistru frame.
3. Where service routes cross fire compartmentation lines, as defined by a fire specialist, suitable firestopping is to be installed to comply with the fire strategy. Further site investigation and a scope of opening up works are proposed to establish the extent of existing concealed installation and enable co-ordination to be completed.
4. Where pipework is drawn, it is new unless stated otherwise.

KEY

- Low Temperature Hot Water Flow (LTHW F)
- Low Temperature Hot Water Return (LTHW R)
- Existing LTHW Pipework
- Pipework at High Level
- Pipework at Low Level
- Pump
- F/A From Above
- T/B To Below
- F-R Flow and Return
- BV Buffer Vessel
- HEX Heat Exchanger
- EV Expansion Vessel
- PU Pressurisation Unit

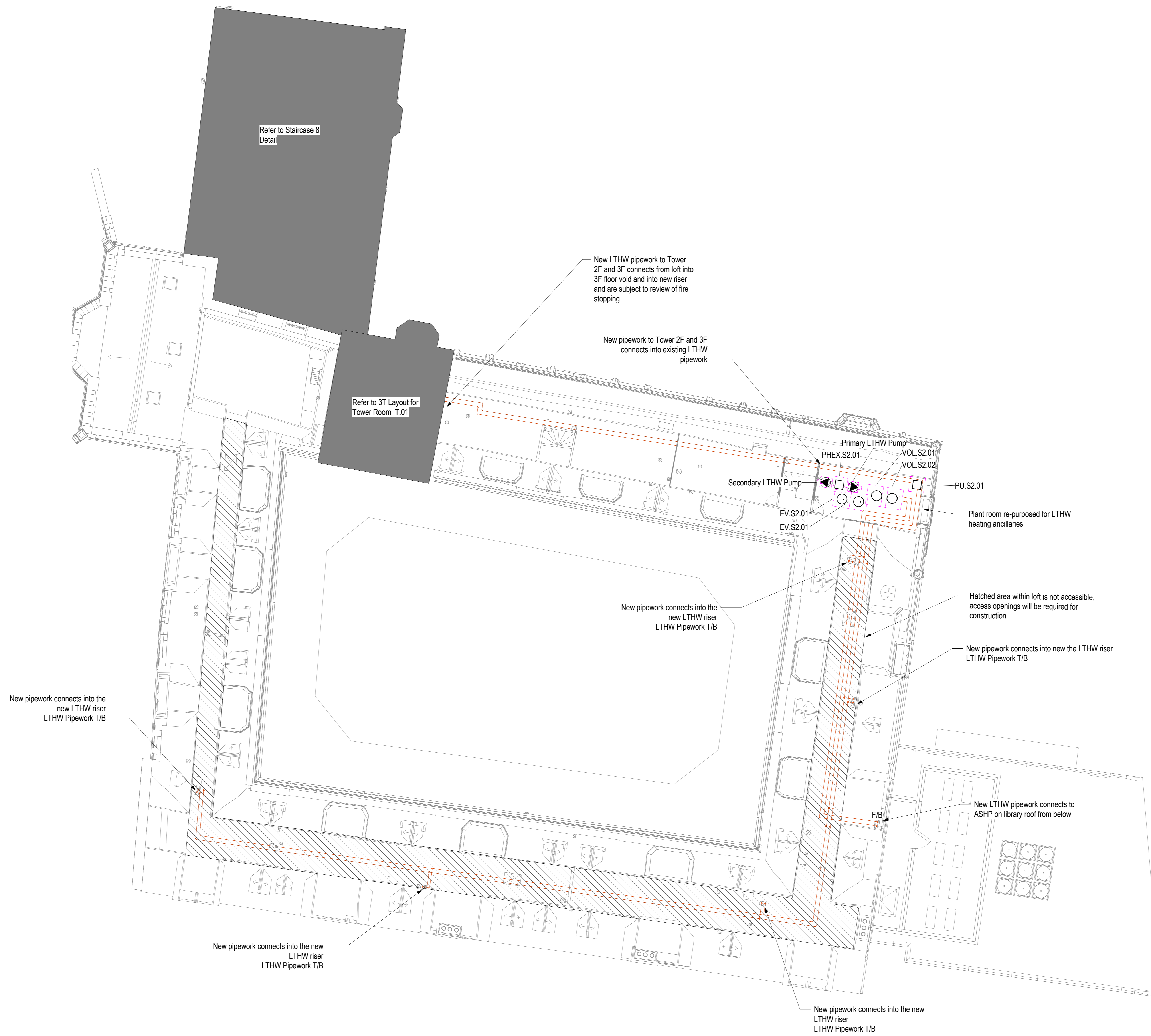
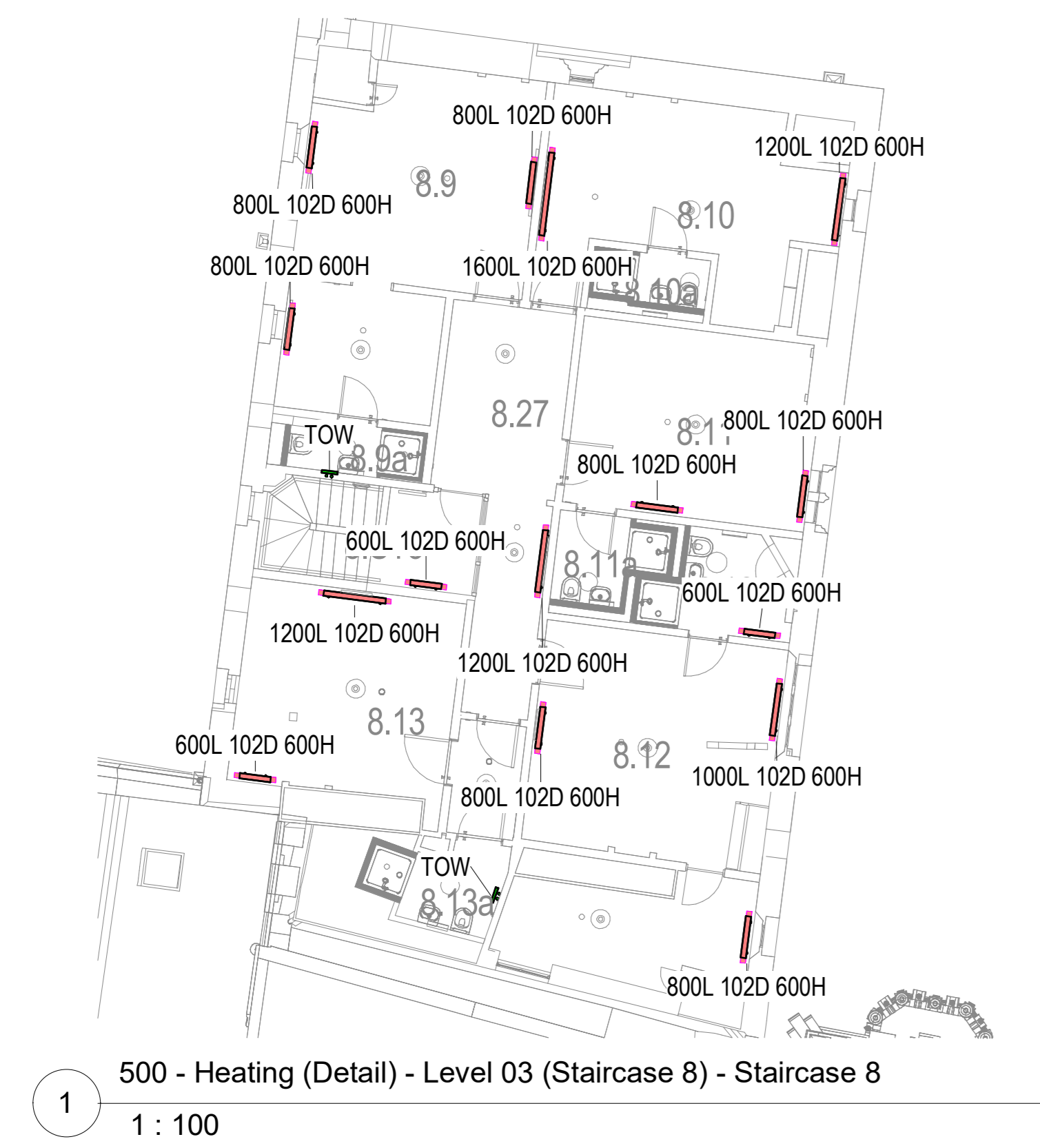

2 500 - Heating (Detail) - Loft (Old Quad) - Old Quad
1 : 100