



**Elevation 03**  
Old Quad courtyard elevation  
1:100@A1



**Elevation 04**  
Old Quad courtyard elevation  
1:100@A1

**Stonework repairs and cleaning**

Stonework to be sensitively cleaned by a suitable specialist, to remove atmospheric soiling and water staining.

High level inspection to be carried out to locate any blown faces. Blown faces to be patch repaired as per Detail 01

**General notes**

All windows to be refurbished - refer to 2313-PD-5100- Window Schedule

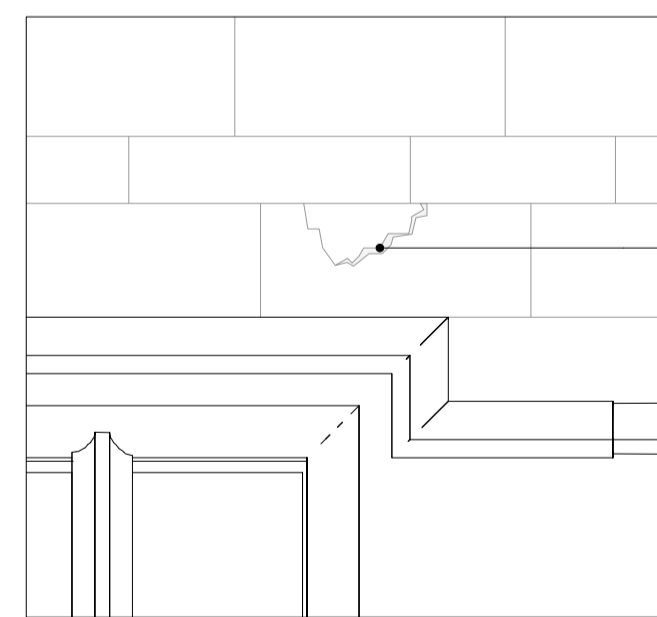

1. Existing condition

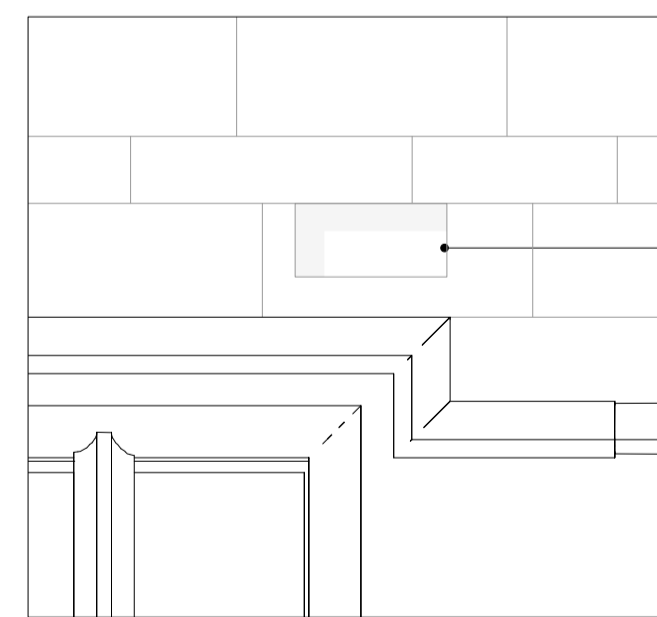

2. Affected stonework removed

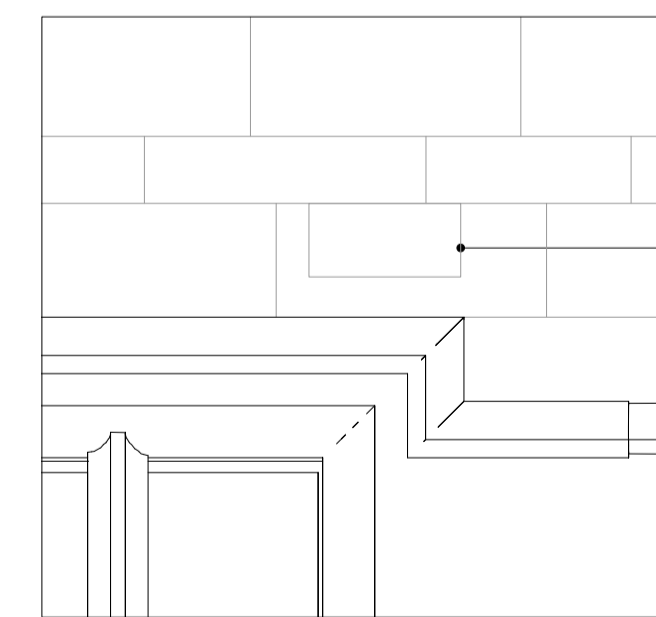

3. Proposed condition

**Detail 01**  
Typical repair approach for blown faces  
1:20 @ A1

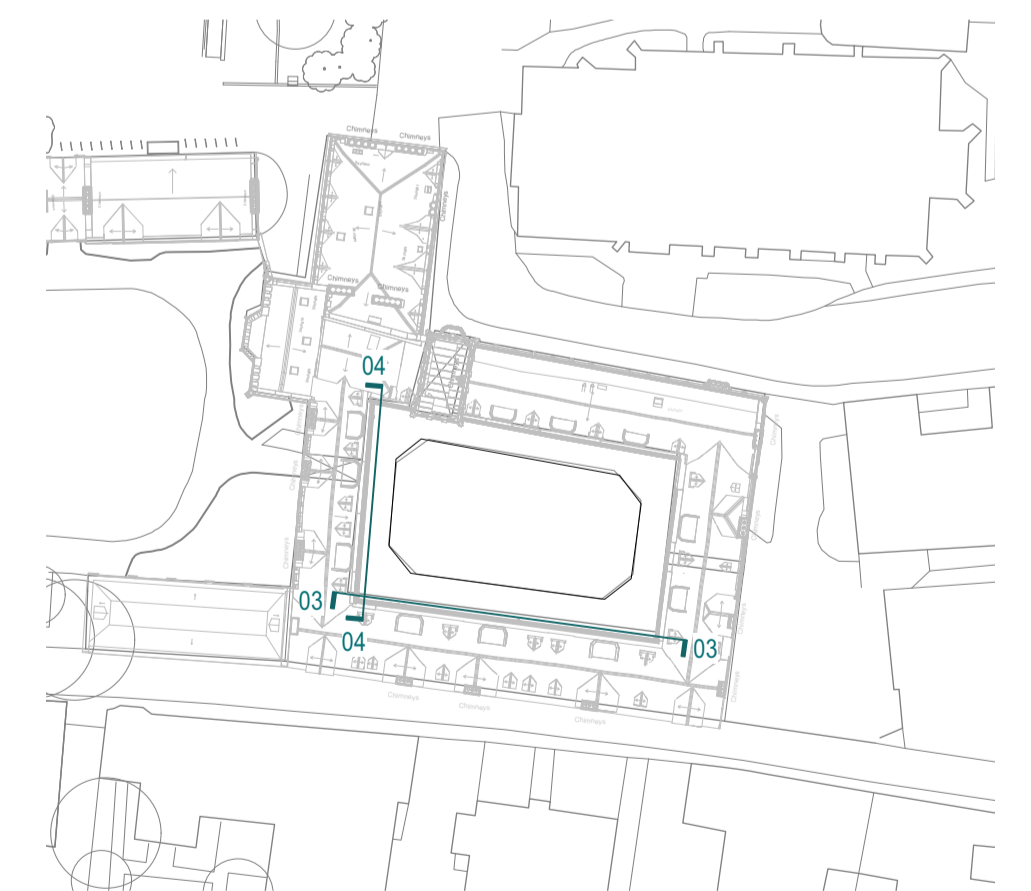

**Key plan**  
(NTS)



| Rev | Date     | Amendment           |
|-----|----------|---------------------|
| --  | 15.03.24 | Issued for Planning |

|   |                   |  |                 |   |               |
|---|-------------------|--|-----------------|---|---------------|
| <b>WALTERS &amp; COHEN ARCHITECTS</b>                 |                   | 2 Wilkin Street<br>London<br>NW5 3NL<br>mail@waltersandcohen.com |                 | Telephone 020 7428 9751<br>mail@waltersandcohen.com |               |
| <b>Pembroke College Rokos and Old Quad</b>            |                   | <b>External repairs - Elevations 03 &amp; 04</b>                 |                 |   |               |
| Checked by<br>TL                                      | Scale<br>1:100@A1 | Date Drawn<br>28.11.23   | Job No.<br>2313 | Drawing No.<br>PD-1953                              | Revision<br>- |
| © This drawing is copyright. Check dimensions on site |                   |  |                 |   |               |

**PLANNING**