

NOTES:

This is a planning drawing and is not to be used for construction.

Proposed amendments to approved drawings 23/00189/LBC are shown in red.

EXTERNAL RENDER

Allow to replace late C20 cement render in lime subject to agreement of render sample. Omit late C20 bottle parget panel detail to reinstate appearance to the flush appearance of the historic photograph shown in the Heritage Statement.

Unless otherwise agreed with the Conservation Officer / LPA:

Allow to retain any sound historic lathes that survive and to carefully remove metal mesh.

In principle any areas retaining historic lathes are to be repaired in matching timber lathe and the metal mesh substrate is to be replaced with 15mm external quality woodwool or similar agreed breathable substrate. Allow to insulate in Steico woodfibre or similar breathable insulation batts if practical to do to a whole wall without disturbance of historic fabric and without cold bridging.

Allow to finish in Anglia Lime external lime render mix.

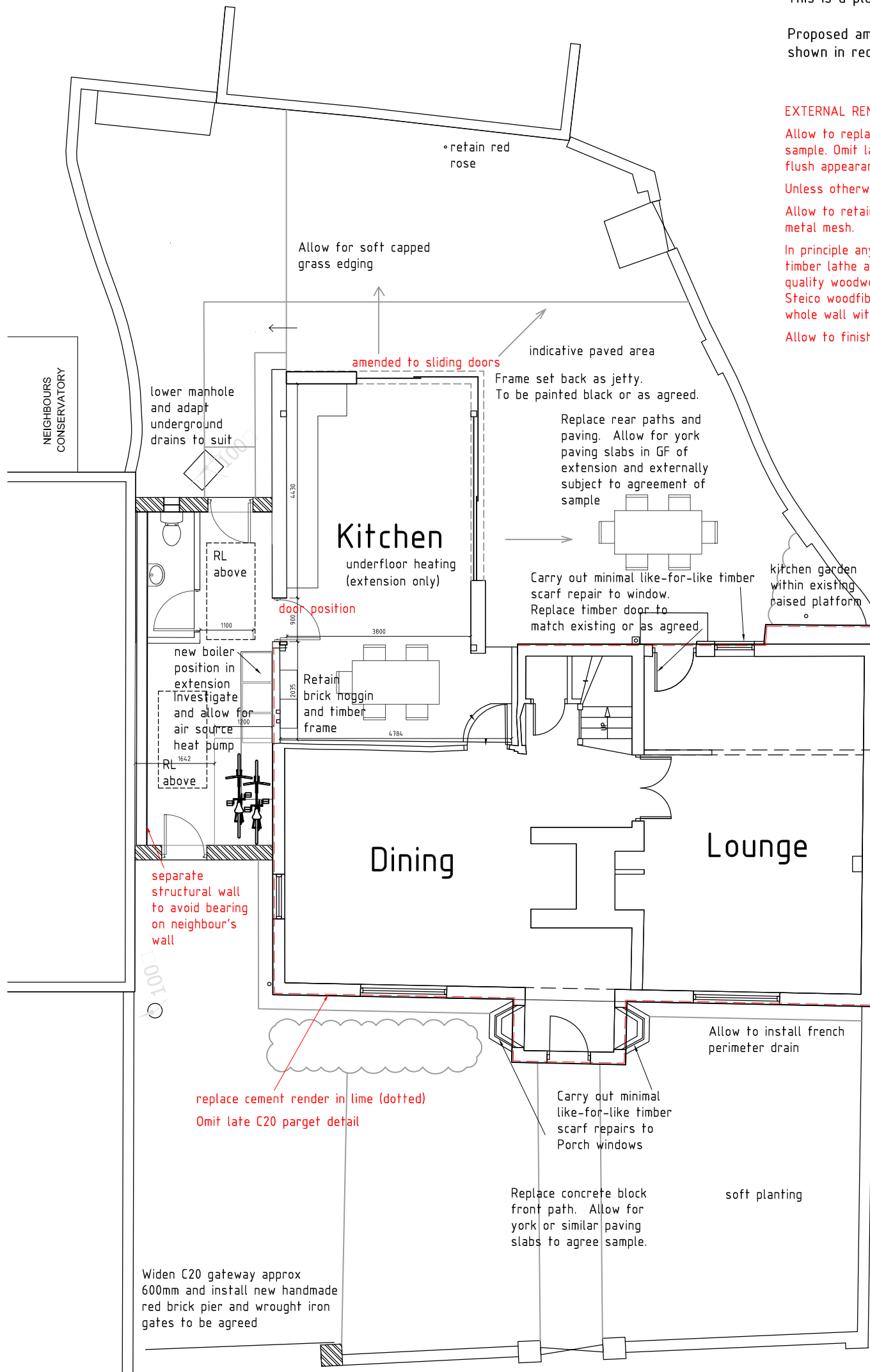

Ground Floor Plan

Rev G 23.03.2024 Planning Application. Sliding doors, render notes added.

Rev F 23.03.2024 Amends to Planning Application. Door positions and glazing.

CORRIE NEWELL BA Arch Hons RIBA ARB IHBC

90 Highfields, Great Yeldham CO9 4QH. Tel: 07914 957035

**LITTLE JERICHO
BLACKMORE**

PROPOSED GROUND FLOOR PLAN

1:100 AT A3

242.12G

