

GROUND FLOOR

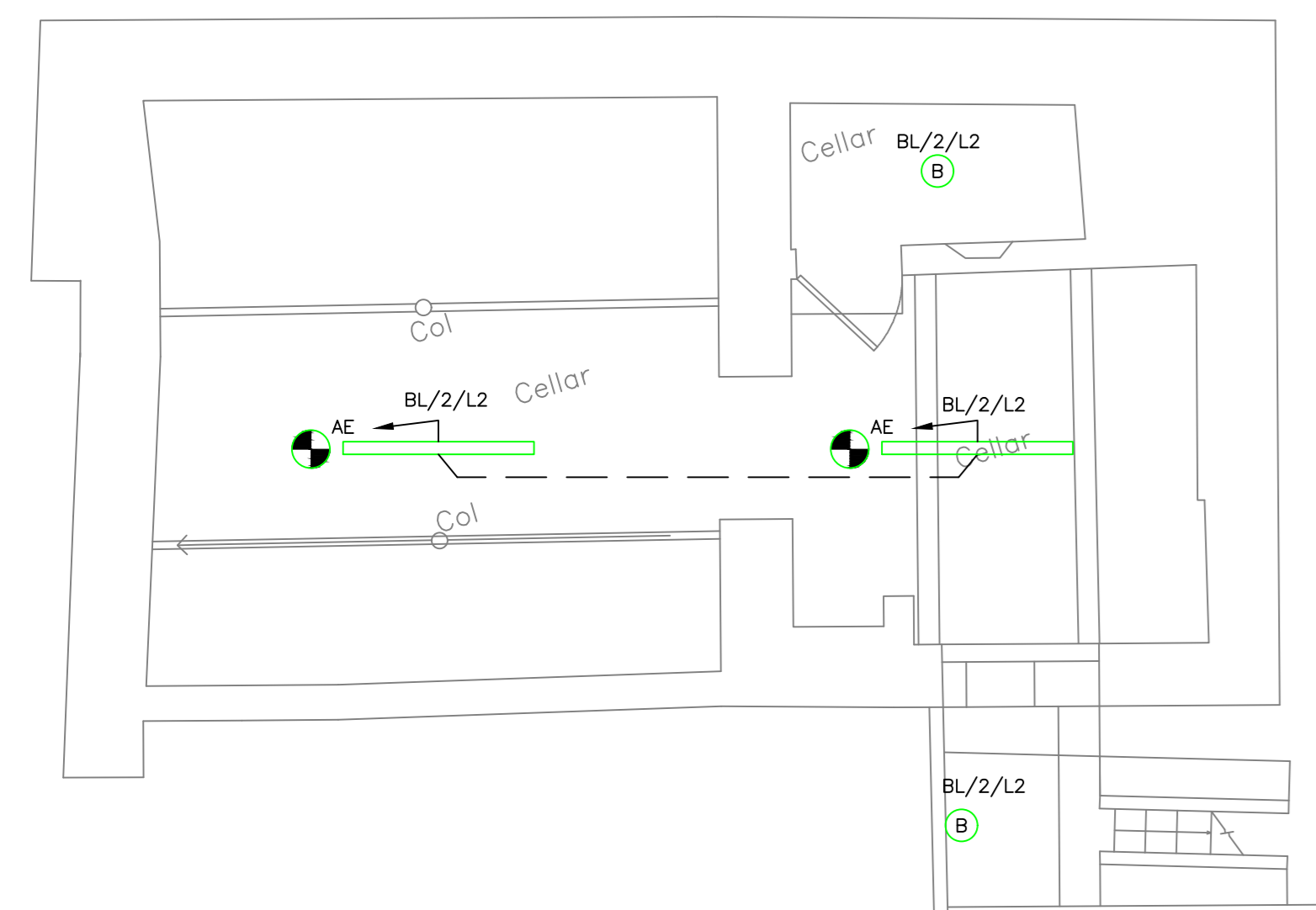

CELLAR



FIRST FLOOR

**LEGEND**

A-WALL MOUNTED FITTING - DEXTRA LIGHTING, TYPON, 1500mm, IP65 POLYCARBONATE, LINEAR, 39.6w, 5418lm, C50-SW, WARM WHITE, 3000K - DEXTRA B AE-AS ABOVE c/w INTEGRAL 3hr MAINTAINED EMERGENCY CONVERSION PACK - TYP L63 PC 55 LE3

A1-WALL MOUNTED FITTING - DEXTRA LIGHTING, TYPON, 1200mm, IP65 POLYCARBONATE, LINEAR, 28.8w, 4300lm, LED, 4000K LUMINAIRE-TYP L63 PC 45 AE-AS ABOVE c/w INTEGRAL 3hr MAINTAINED EMERGENCY CONVERSION PACK - TYP L50 PC 45 LE3

B-CEILING MOUNTED FITTING - ANSELL LIGHTING, GAMMA, POLYCARBONATE, CIRCULAR, 17W LED, 4000K LUMINAIRE c/w INTEGRAL MICROWAVE SENSOR - ADAM/LED/TC/MS/MS BE-AS ABOVE c/w INTEGRAL 3hr MAINTAINED EMERGENCY CONVERSION PACK - ADAM/LED/TC/MS/MS

C-SUSPENDED DIRECT/INDIRECT FITTING - DEXTRA LIGHTING, RUNWAY, 1500mm, OPAL GREY, COLOUR 84, LINEAR, 34.6w, 4244lm, LED, 4000K LUMINAIRE-TYP RWY 1500 L60 BD DP DY (TO BE APPROVED BY CLIENT PRIOR TO PROCUREMENT)

CE-AS ABOVE c/w INTEGRAL 3hr MAINTAINED EMERGENCY CONVERSION PACK - RWY 1500 L60 BD DP DY LE3

D-RECESSED DOWNLIGHTER - ANSELL LIGHTING, EDGE, FIRE RATED GIMBAL, ANTIQUE BRASS c/w PHILIPS 4.6w LED5050S WARM WHITE GU10 LAMP (TO BE APPROVED BY CLIENT PRIOR TO PROCUREMENT)

D1-RECESSED DOWNLIGHTER - ANSELL LIGHTING, EDGE MINI IP65, FIRE RATED BLACK CHROME c/w PHILIPS 4.6w LED5050S WARM WHITE GU10 LAMP (TO BE APPROVED BY CLIENT PRIOR TO PROCUREMENT)

PS-PENDANT SET TO BE SUPPLIED AND FREE ISSUED BY CLIENT FOR INSTALLATION BY ELECTRICAL CONTRACTOR - LAMPS TO BE DIMMABLE (TYPICAL DETAILS SHOWN - ANTIQUE BRASS)

W-WALL LIGHT TO BE SUPPLIED AND FREE ISSUED BY CLIENT FOR INSTALLATION BY ELECTRICAL CONTRACTOR - LAMPS TO BE DIMMABLE (TYPICAL DETAILS SHOWN - ANTIQUE BRASS)

INDICATES EXISTING FITTINGS BOTH INTERNALLY AND EXTERNALLY THAT ARE TO BE REMOVED, CLEANED, TESTED, REWIRING REQUIRED AND REINSTATED. NEW LAMPS TO THE INTERNAL WALL LIGHTS AND LAMP STANDARDS TO BE OF THE 4.5W PHILIPS 3000K LANCEL LAMPS

DA-IP65, BLACK, RECESSED LIGHT - COLLINGWOOD LIGHTING - 1/2 PRO EXTREM C50-SW, WARM WHITE, 3000K - DEXTRA B (CLIENT PRIOR TO PROCUREMENT)

OB-IP65, ORNAMENTAL, BLACK, WALL LIGHT - ANSELL LIGHTING - LATINA WALL LANTERN-SW, WARM WHITE, 3000K - ADAM/LED/TC (CLIENT PRIOR TO PROCUREMENT)

OC-IP65, 1 DIRECTIONAL, BLACK, WALL LIGHT - ANSELL LIGHTING - MIGNO CURVE-11W, WARM WHITE, 3000K - ADAM/LED/TC/MS/MS (CLIENT PRIOR TO PROCUREMENT)

OC-IP65, 1 DIRECTIONAL, BLACK, WALL LIGHT - ANSELL LIGHTING - MIGNO CURVE-11W, WARM WHITE, 3000K - ADAM/LED/TC/MS/MS (CLIENT PRIOR TO PROCUREMENT)

ASD LIGHTING - EMERGENCY ONE SOLE, EMERGENCY FITTING.

EMERGENCY/LIGHT TEST KEY SWITCH

EE - ASD LIGHTING - EMERGENCY SAFEROUTE ELITE CEILING, WHITE, SELF TEST, MAINTAINED, 3hr LITHIUM IRON BATTERY EMERGENCY EXIT FITTING. - SW/MS-MULTI - (LEGEND AS REQUIRED)

**LEGEND**

SWITCHED FUSED SPUR

KEY SWITCH

2 WAY SWITCH

SWITCH

DIMMABLE SWITCH

EMERGENCY/LIGHT TEST KEY SWITCH

DIRECTIONAL MICROWAVE DETECTOR

MICROWAVE DETECTOR

SAMP LIGHTING SOCKET OUTLET

TIMECLOCK

CONTACTORS

PHOTO ELECTRIC CELL

- COM. NOTES**
- THE ELECTRICAL CONTRACTOR SHALL ENSURE THAT RISK ASSESSMENTS AND METHOD STATEMENTS ARE PRODUCED FOR ALL ELEMENTS OF THEIR WORKS AND ARE INCLUDED WITHIN THE ON SITE HEALTH AND SAFETY MANUAL.
  - THE ELECTRICAL CONTRACTOR SHALL FAMILIARISE THEMSELVES WITH THE HEALTH AND SAFETY FILE, ASBESTOS REGISTER AND ASBESTOS REGISTER PRIOR TO COMMENCEMENT OF WORKS.
  - WORKING FROM HEIGHT - USE OF SAFE WORKING PLATFORMS TO BE USED.
  - WORKING AT HEIGHT - RISK OF TOOLS OR EQUIPMENT BEING DROPPED ONTO OPERATIVES BELOW - RESTRICTED ACCESS TO AREAS DIRECTLY BELOW WHERE WORKS ARE BEING CARRIED OUT.
  - INSTALL SERVICES WITHIN CEILING AND CEILING/SERVICE VOIDS - RISK OF FALLING MATERIALS, DUST FIBRES - SUITABLE USE OF SAFE PLATFORMS AND USE ADDITIONAL PPE IE DUST MASKS, GLOVES ETC.
  - USE OF HAZARDOUS MATERIALS - HAZARDOUS MATERIALS HAVE NOT BEEN SPECIFIED IN THE NEW WORKS, COSHH SHEETS TO BE PROVIDED WHERE APPLICABLE AND SUITABLE PPE TO BE USED BY STAFF.
  - MANUAL HANDLING OF PLANT AND EQUIPMENT - EQUIPMENT IS GENERALLY SMALL ENOUGH TO BE SUITABLE FOR MANUAL HANDLING. MECHANICAL MEANS TO BE USED TO LIFT LARGER ITEMS.
  - CUTTING, DRILLING ETC. OF METALWORKS SUCH AS TRAY CONDUIT TRUNKING ETC - NORMAL SAFETY PROCEDURES TO BE USED. PROVIDE PROTECTIVE CLOTHING GOGGLES ETC.

- LIGHTING INSTALLATION NOTES**
- IF IT IS A REQUIREMENT OF THIS TENDER THAT ALL TENDERING CONTRACTORS ATTEND SITE TO FAMILIARISE THEMSELVES WITH THE EXISTING SITE CONDITIONS AND THE EXTENS OF THE WORKS REQUIRED UNDER THIS CONTRACT.
  - ALL WORKS INCLUDING BONDING, TESTING & CERTIFICATION ARE TO BE CARRIED OUT IN ACCORDANCE WITH THE CURRENT EDITION OF THE BS WIRING REGULATIONS BS7671 AND ALL OTHER RELEVANT STANDARDS AND REGULATIONS.
  - THIS DRAWING SHALL BE READ IN CONJUNCTION WITH THE ARCHITECT'S SPECIMEN INSTALLERS & STRUCTURAL ENGINEERS DRAWINGS AND REPORTS.
  - THIS DRAWING SHALL NOT BE USED FOR DIMENSIONING PURPOSES. ALL SETTING OUT SHALL BE CARRIED OUT ON SITE AND APPROVED BY THE INTERIOR DESIGNER & MAIN CONTRACTOR.
  - THE ELECTRICAL CONTRACTOR SHALL BE RESPONSIBLE FOR ALL BUILDERS WORK HOLES, CUTTING, CHASING AWAY ETC THAT IS REQUIRED IN RELATION TO THE ELECTRICAL INSTALLATION WORKS.
  - CEILING AND GENERAL FINISHES WITHIN THE EXISTING AREA ARE TO BE RETAINED, AS SUCH THE ELECTRICAL CONTRACTOR SHALL GARBAGE PLAN ALL NEW CABLES ROUTES TO MINIMIZE DISRUPTION, DAMAGE AND REPAIR TO THE EXISTING AESTHETICS.
  - ALL AREAS ARE TO BE WIRED AS NEW OR REWIRING PART FROM THE FIRST & SECOND FLOORS AREAS ABOVE THE RETAINED PUB AREA, ALL REDUNDANT CABLES & CONTAINMENT TO BE REMOVED IN THEIR ENTIRETY.
  - THE ELECTRICAL CONTRACTOR SHALL TAKE GREAT CARE TO ENSURE THAT WHEN ISOLATING CIRCUITS TO BE STRIPPED OUT DISRUPTION TO AREAS OUTSIDE OF THE WORKS IS KEPT TO A MINIMUM.
  - THE ELECTRICAL CONTRACTOR SHALL INCLUDE FOR THE SUPPLY, INSTALLATION & TESTING OF ALL ASPECTS OF THE LIGHTING INSTALLATION AND SHALL LEAVE AN INSTALLATION THAT IS FULLY OPERATIONAL IN ALL RESPECTS.
  - ALL LIGHT FITTINGS ARE TO BE APPROVED BY CLIENT PRIOR TO ORDER AND INSTALLATION.
  - ALL LIGHT FITTINGS INSTALLED WITHIN A SUSPENDED CEILING SHALL BE SUPPORTED SEPARATELY FROM THE BUILDING STRUCTURE AND SHALL NOT RELY SOLELY ON THE SUSPENDED CEILING.
  - ALL LIGHT FITTINGS SHALL BE SUPPLIED COMPLETE WITH FIRE HOODS, LAMPS AND SHALL BE CLEAN & DUST FREE AT TIME OF HANDOVER.
  - ALL 230V WIRING OF LIGHTING CIRCUITS IS TO BE CARRIED OUT IN MINIMUM SIZED 1.5mm<sup>2</sup> LSZH TWIN & EARTH CABLE CONTAINED AND SUPPORTED ON GALVANIZED STEEL CABLE BASKET WHERE POSSIBLE OR LSZH COATED STEEL ALL ROUND BANDING WHENS NOT POSSIBLE TO USE CABLE BASKET. CABLEING TO THREE PHASE EQUIPMENT SHALL BE WIRED IN LSZH SCREENED FIXED WIRING LSZH WHITE CABLE OR SWA TYPE CABLEING.
  - ALL CABLES AND CONTAINMENT SHALL BE CONCEALED WITHIN CEILING VOIDS, SERVICE BUNDLES & WITHIN THE FABRIC OF THE BUILDING TO PROVIDE A FLUSH INSTALLATION THROUGHOUT.
  - ALL CONTAINMENT SHALL BE INSTALLED IN A NEAT UNIFORM FASHION WITH ALL RUNS BEING LEVEL/PLUMB.
  - WHERE CABLES DROP DOWN BLOCK WALLS THEY SHALL BE PROTECTED BY STEEL GALVANIZED CAPPING.
  - OPEN ENDOMETERS SHALL BE USED WHERE ALL CABLES ENTER BOXES OR ENCLOSURES.
  - ALL CABLEING SHALL BE PULLED IN A NEAT AND UNIFORM FASHION.
  - ALL CABLE ROUTES SHALL BE AGREED ON SITE AND SHALL BE CO-ORDINATED WITH MECHANICAL SERVICES.
  - ACCESSORIES WITHIN THE WORK AREAS THAT ARE TO BE REWIRED WILL BE REPLACED WITH NEW.
  - ALL SWITCHES, SOCKETS AND ACCESSORIES SHALL BE MANUFACTURED BY SCOWOORE INTERNATIONAL. WITHIN THE RETAINED PUB AREAS, THE NEW WAITING AREAS, DINING ROOM, BAR, ACC. INC. & LOBBY THEY SHALL BE OF THE CLUCK DECO ANTIQUE BRASS RANGE WITH BLACK INDENTS. WITHIN ALL OTHER AREAS THEY SHALL BE OF THE MODE RANGE WITH EXPOSED BACK OF HOUSE AREAS THEY SHALL BE OF THE METAL CLAD RANGE. EXTERNALLY MOUNTED ACCESSORIES SHALL BE OF THE AQUIP65 RANGE.
  - EMERGENCY LIGHTING SHALL BE PROVIDED IN LINE WITH BS5266.
  - EMERGENCY LIGHTING TEST KEY SWITCHES ARE TO BE PROVIDED FOR TESTING OF THE EMERGENCY LIGHTING. GENERAL LIGHTING SHOULD REMAIN ON UNDER TEST CONDITIONS.
  - THE FINAL LAYOUTS AND POSITIONS OF ALL ACCESSORIES AND EOT SHALL BE AGREED WITH THE CLIENT/ARCHITECT PRIOR TO COMMENCEMENT OF THE ELECTRICAL INSTALLATION.
  - ON COMPLETION OF THE WORKS THE ELECTRICAL CONTRACTOR SHALL PROVIDE ALL RELEVANT CERTIFICATION INCLUDING AN ELECTRICAL INSTALLATION CERTIFICATE AND EMERGENCY LIGHTING DESIGN, INSTALLATION & COMMISSIONING CERTIFICATES IN LINE WITH BS7671 AND BS5266.
  - ALL CERTIFICATION SHALL BE CONTAINED WITHIN AN O&M MANUAL WHICH SHALL BE SUPPLIED BY THE ELECTRICAL CONTRACTOR. THE O&M MANUAL SHALL BE PROVIDED IN BOTH PAPER (BOUND & INDEXED WITH COVER AND CONTENTS PAGES) AND DIGITAL FORMATS AND SHALL ALSO CONTAIN DETAILS OF ALL MAINTENANCE PROCEDURES, MANUFACTURERS LITERATURE AND AS FITTED DRAWINGS.

Rev	Description	Date	CA/MS	CA/MS
T1	ISSUED FOR TENDER	28.03.24	CA/MS	CA/MS



CLIENT: The Stanley Arms

Proposed Lighting Layout

All Floors

DATE	BY	CHKD	APPD	REV
MAR 24	SM	F.F.	CA	N.S.

Scale: 1:50 @ A0

Project: TENDER

Sheet: 38A/E03 of T1