

Footpath Crossing Point - Plan
Scale 1:25

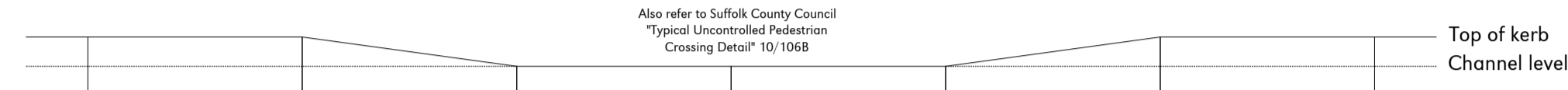

Footpath Crossing Point - Front Elevation
Scale 1:25

DRAWING TO BE READ IN CONJUNCTION WITH SUFFOLK COUNTY COUNCIL STANDARD DETAILS

- Kerbs as per 10/101B.
- Vehicular Access as per 10-102B & DM01
- Footway Construction as per 10/103B
- Catchpits Detail as per 7/103B
- Access to Chambers as per 7/107
- Pipe Bedding as per 7-101B

Note:

- All dimensions noted are in metres unless stated otherwise.
- Do not scale from this drawing, if dimensions are not clear ask.
- This document has been created in accordance with Plandescil Ltd Terms & Conditions along with the scope of works provided by the client to Plandescil. Any use of this document other than for its original purpose is prohibited, Plandescil accept no liability for any third party uses of this document.
- Plandescil Ltd to be immediately notified of any suspected omissions or discrepancies.
- This drawing is to be read in conjunction with all other relevant documents relating to the project.
- All levels relate Plandescil Topographical Survey drawings 22536/001, 002 & 003.
- All proprietary materials to be fixed strictly in accordance with manufacturer's recommendations using materials approved by the manufacturer.
- Inspections by the Local Authority, shall be arranged by the contractor to suit their program.
- Until technical approval has been obtained from the relevant authorities it should be understood that all drawings issued are preliminary and not for construction. Should the contractor start site work prior to approval being given, it is entirely at their own risk.
- All existing drainage and highway tie-in details are to be confirmed on site prior to the commencement of the proposed works.
- Road markings to be in accordance with TSRGD 2016, material to be Superimposed Thermoplastic to BS EN 1871 and BS EN 1436.
- Specifications for the roadway construction is subject to CBR test details. These tests will need to be carried out prior to any road works starting.
- Excavations close to trees/hedges to be carried out in accordance with NJUG Guidelines Volume 4. In particular no roots over 25mm dia should be cut without consulting an arboriculturalist and any smaller roots that are damaged should be cut cleanly with sharp secateurs.
- Any tree pruning should be carried out in accordance with BS 3998:2010 Tree Recommendations.

Works Requiring Inspection By The Highways Inspector

The Contractor shall give advance notice to Suffolk County Council to allow the Highways Inspector proper inspection and checking of the works at the following designated stages:

- Prior to the start of works a photographic record of the existing highway condition adjacent to the development is to be agreed and recorded.
- Start of the works
- Before backfilling any trenches under new highway
- Completion of formation
- Completion of sub-base
- Arrival and planting of trees
- Laying of base
- Laying of binder course
- Laying of surface course
- All damage to existing highway resulting from construction traffic is to be repaired before the Inspector will recommend works for interim or adoption

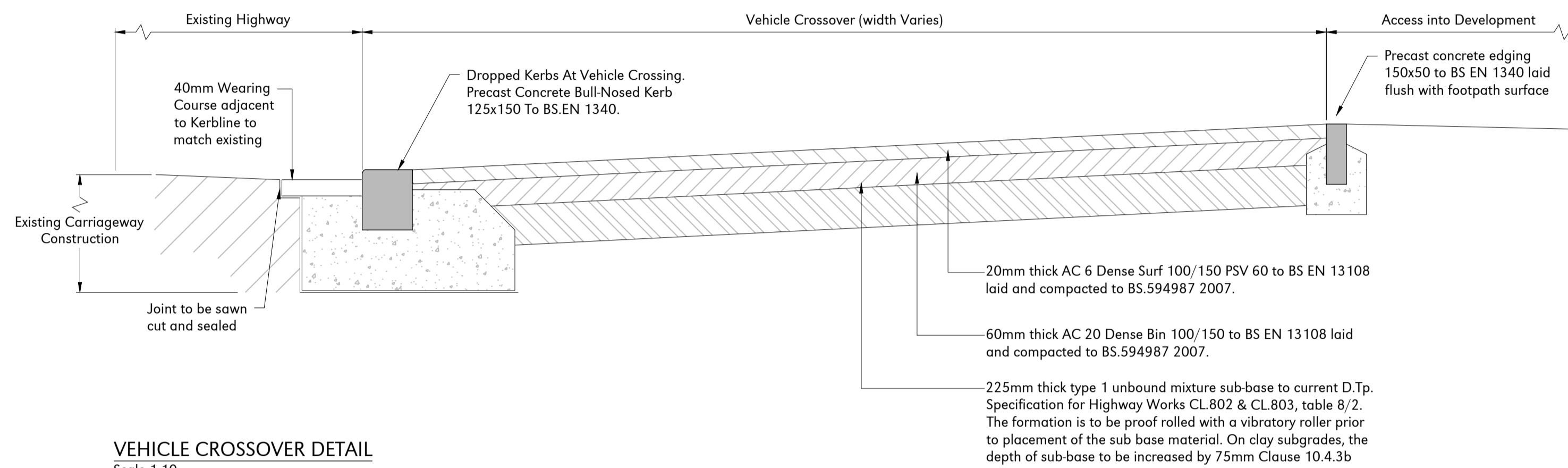

VEHICLE CROSSOVER DETAIL
Scale 1:10

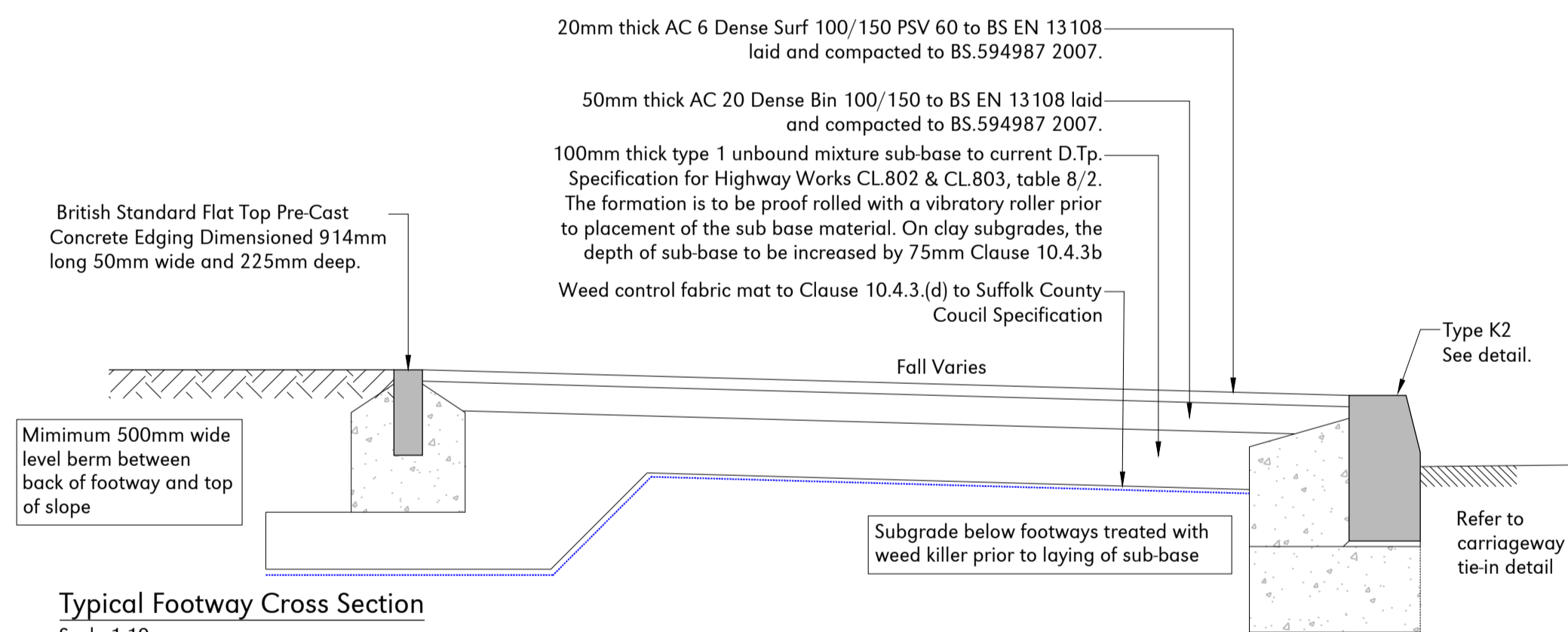

Typical Footway Cross Section
Scale 1:10

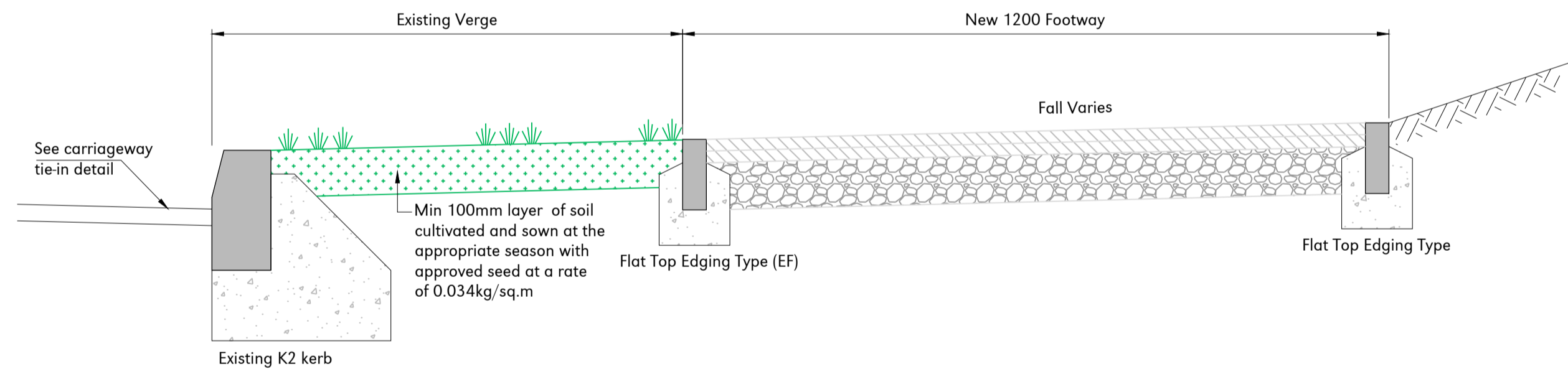

GRASS VERGE AND FOOTWAY DETAIL
Scale 1:10

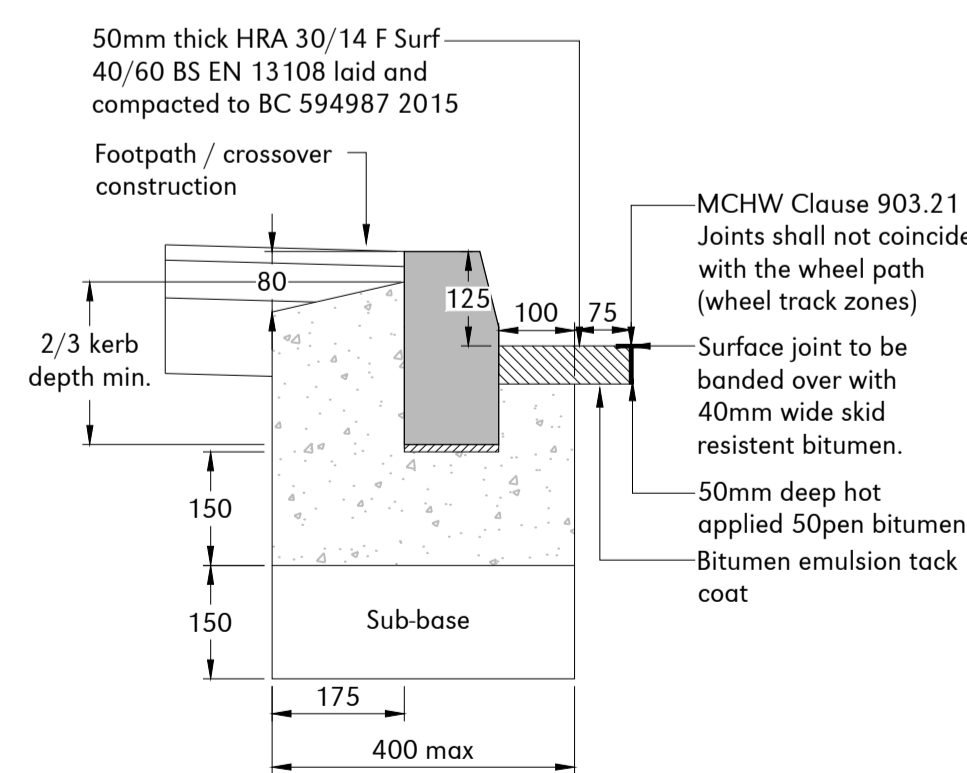

Kerb Detail Tie-in to Existing Carriageway
Scale 1:10

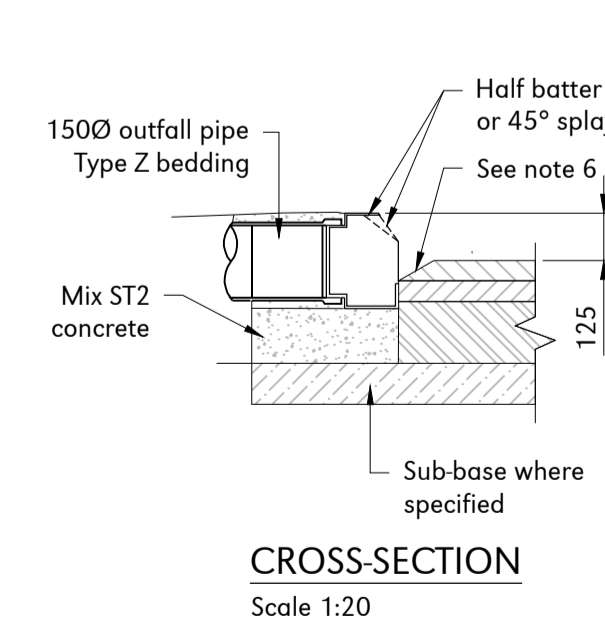

CROSS-SECTION
Scale 1:20

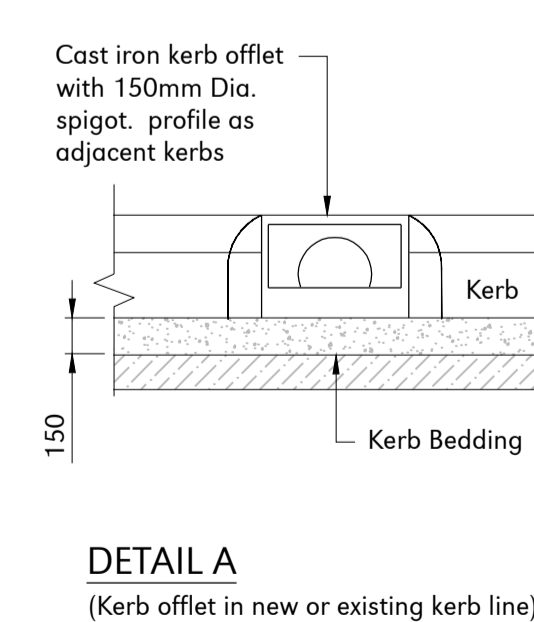

DETAIL A

(Kerb offlet in new or existing kerb line)

Notes:

- All dimensions in millimetres.
- Kerb types as stated
- Outfall pipe to have Type Z bedding.
- Joint between offlet spigot and pipe socket to have concrete mix ST2 surround. Concrete to finish flush with top of kerb in verge. In footways concrete surround to allow full depth binder and surface course.
- Offlet to be uncoated iron to BS EN 124
- "Dish" surfacing at mouth of offlet to ensure water falls into pipe

APPROVAL & COMMENT

Rev	Date	Rev By	Chkd	Description
0	27-03-24	-	MJH	First Issue



Units T6 & T7 Snetterton Business Park
Harling Road Snetterton Norfolk NR16 2JU
Telephone: (01953) 452001
E-mail: pdc@pdcengineering.co.uk www.pdcengineering.co.uk
PDC Engineering a Plandescil Ltd Company

civil • structural • environmental • surveying

Client

WSB Developments Ltd

Project

**Proposed Residential Dev.
Southolt Road, Bedfield
Suffolk, IP13 7HH**

Drawing Title

**SCC S278 Highway Works
Details**

Scale	U.N.O.	Date	Drawn By
		As Noted (A1) March 2024	CND
Drawing No.	29017/620	Rev	0