

NORTH BOUNDARY
HEDGE & WALL

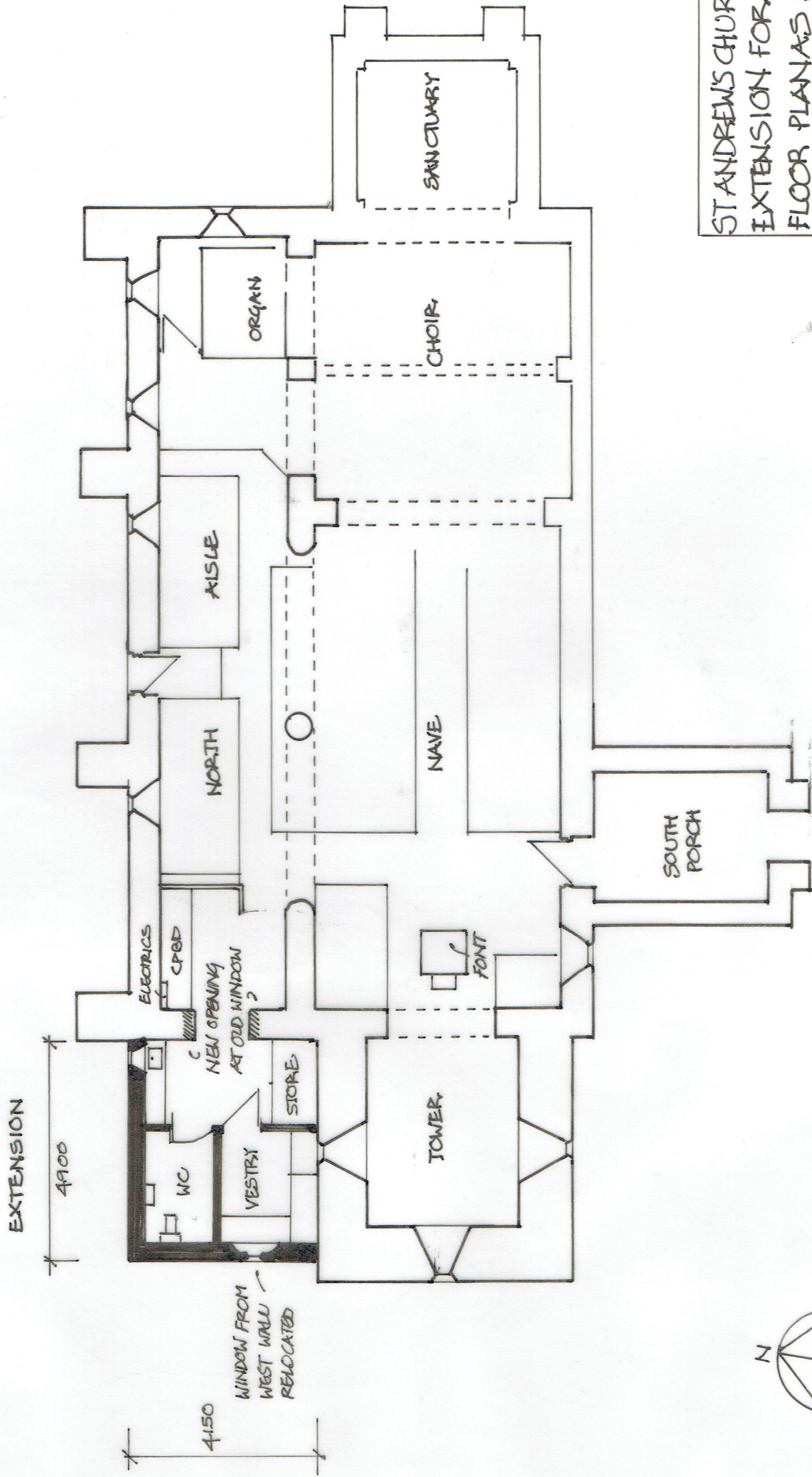

ST ANDREW'S CHURCH, BISHORSTONE
EXTENSION FOR WC ETC
FLOOR PLAN AS PROPOSED

169 Western Road
Haywards Heath
West Sussex RH16 3LH
Telephone 01444 702708
andy@andyburrellarchitecture.co.uk
www.andyburrellarchitecture.co.uk

ANDY BURRELL
ARCHITECTURE

1:100
CAB

12.23

5006/007

