

CWM GELLI FARM, BLACKWOOD.

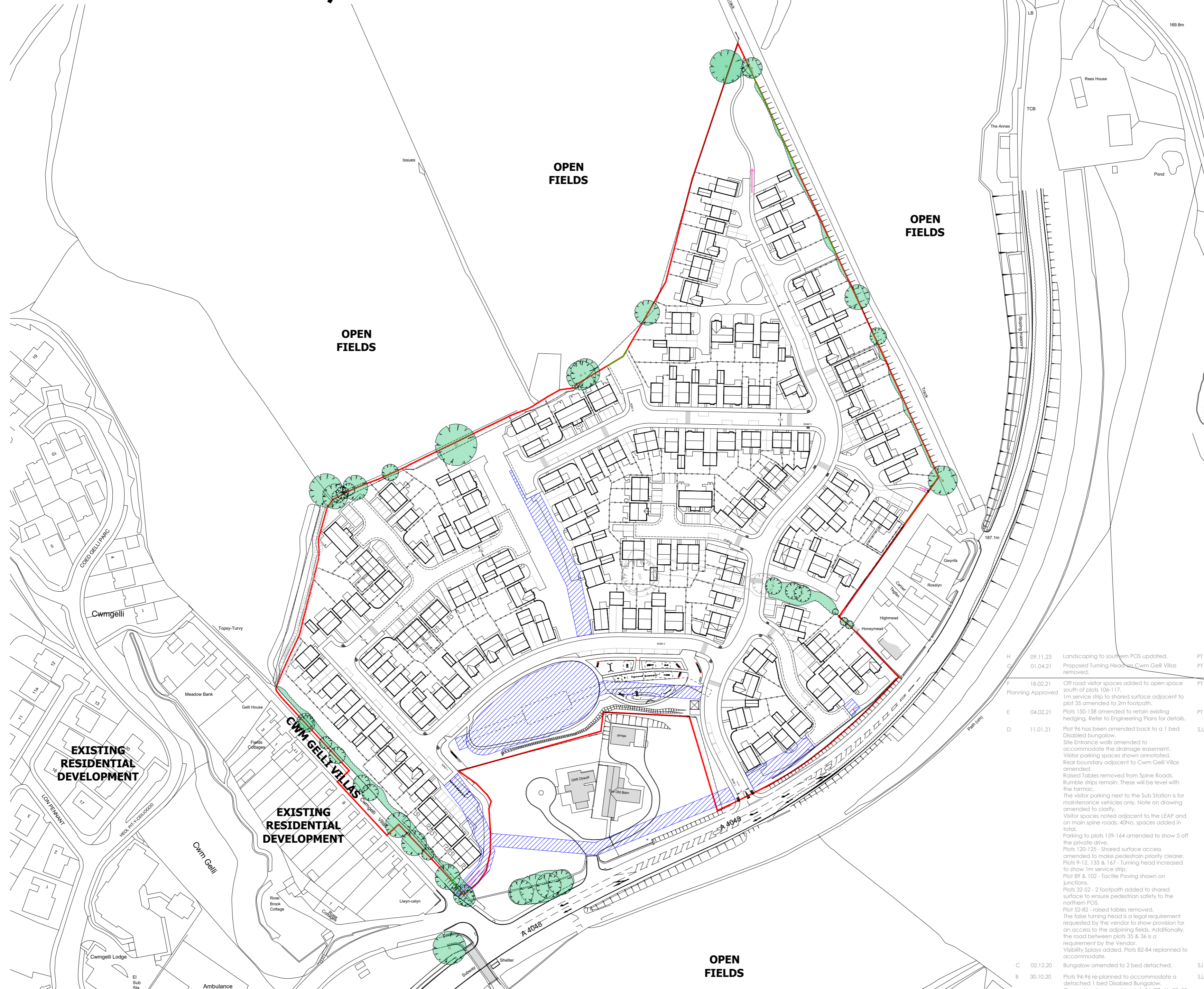

- A 12.06.20 6.1m road added to entrance spine road. Plots 6-9, 12, 13, 17-20, 26-36 & 52-58 amended. PVCT
- Front Wall amended to Metal Railings and a Hedgerow.
- T junction to the front of plots 3 & 4 enlarged - Plot 2 moved back.
- Car Parking provision updated.
- Plots 11, 12, 102-106, 136-138 & 148-164 amended.
- Plots 21-23 changed to affordable homes.
- Visitor spaces to the rear of plots 8 & 9 removed.
- Plots 94-99 - layout amended, tree removed and turning head updated.
- Plots 45-51 amended to show 5 units off the private drive.
- Hedging added to the north side of the fence to plots 39-48, 59-65 & 138.
- Plots 52-58 updated to improve car parking arrangement.
- Plots 59-64 amended to include affordable homes.
- Homes overlooking the central - North, South open space moved back to provide a wider corridor.
- 3m cycleway link added to the front of plots 159-164.
- Highway paving updated and increased.
- New alignment of the northern watercourse added and is subject to the approval by the local authority.
- New Turning head on Cwm Gelli Villas increased in size.
- Ghost Island added to A4048 Site Access.

Revision	Date	Amendment	Initials
H	09.11.23	Landscaping to southern POS updated.	PT
G	01.04.21	Proposed Turning Head on Cwm Gelli Villas removed.	PT
F	18.02.21	Off road visitor spaces added to open space south of plots 106-117. 1m service strip to shared surface adjacent to plot 35 amended to 2m footpath.	PT
E	04.02.21	Plots 150-158 amended to retain existing hedging. Refer to Engineering Plans for details.	PT
D	11.01.21	Plot 96 has been amended back to a 1 bed Disabled bungalow. Site Entrance walls amended to accommodate the drainage easement. Visitor parking spaces shown annotated. Rear boundary adjacent to Cwm Gelli Villas amended. Raised Tables removed from Spine Roads. Rumble strips remain. These will be level with the tarmac. The visitor parking next to the Sub Station is for maintenance vehicles only. Note on drawing amended to clarify. Visitor spaces noted adjacent to the LEAP and on main spine roads. 40No. spaces added in total. Parking to plots 159-164 amended to show 5 off the private drive. Plots 120-125 - Shared surface access amended to make pedestrian priority clearer. Plots 9-12, 133 & 167 - Turning head increased to show 1m service strip. Plot 89 & 102 - Tactile Paving shown on junctions. Plots 32-52 - 2 footpath added to shared surface to ensure pedestrian safety to the northern POS. Plot 52-82 - raised tables removed. The false turning head is a legal requirement requested by the vendor to show provision for an access to the adjoining fields. Additionally, the road between plots 35 & 36 is a requirement by the Vendor. Visibility Splays added. Plots 82-84 replanned to accommodate. Bungalow amended to 2 bed detached. Plots 94-96 re-planned to accommodate a detached 1 bed Disabled Bungalow. Car parking increased to plots 26, 27, 41, 82, 88 & 89. Timber Kissing Gates added to Eastern boundary pedestrian links. Boundary fence amended adjacent to plot 59. Rear boundary enclosure to plots 150-164 changed to 2m high Steel Weld Mesh Fencing.	SJ/PT
C	02.12.20	Bungalow amended to 2 bed detached.	SJ
B	30.10.20	Plots 94-96 re-planned to accommodate a detached 1 bed Disabled Bungalow. Car parking increased to plots 26, 27, 41, 82, 88 & 89. Timber Kissing Gates added to Eastern boundary pedestrian links. Boundary fence amended adjacent to plot 59. Rear boundary enclosure to plots 150-164 changed to 2m high Steel Weld Mesh Fencing.	SJ/PT

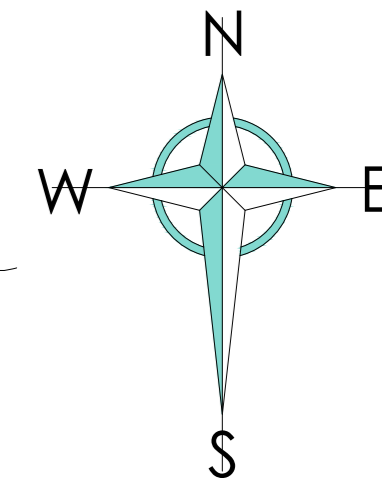

project title CWM GELLI FARM, BLACKWOOD.

drawing title
SITE LOCATION PLAN. date
23.12.19
scale
1:1250 @ A2 drawn by
KE

status PLANNING	drawing number BLAC-15-04-01	revision H
---------------------------	---------------------------------	---------------

Do NOT scale off this drawing. Check dimensions before use and notify Think Urban Design Ltd. of any discrepancies immediately. Contractors, subcontractors and suppliers must verify all dimensions supplied on the drawings and on site before commencing work. Check the contents of this drawing and any submittal information before ordering materials. © Think Urban Design Ltd.

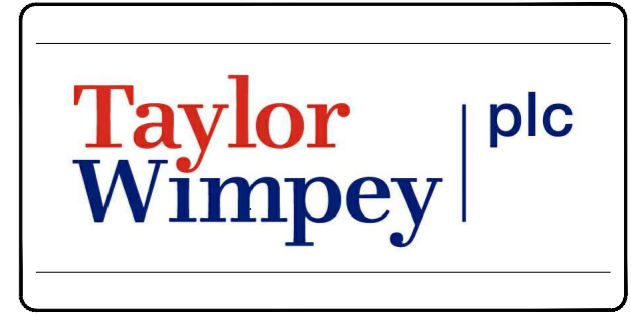

TAYLOR WIMPEY HOMES
Building 2, Eastern Business Park,
Wern Fawr Lane, St Mellons, Cardiff.

