

Upper Floor Plan

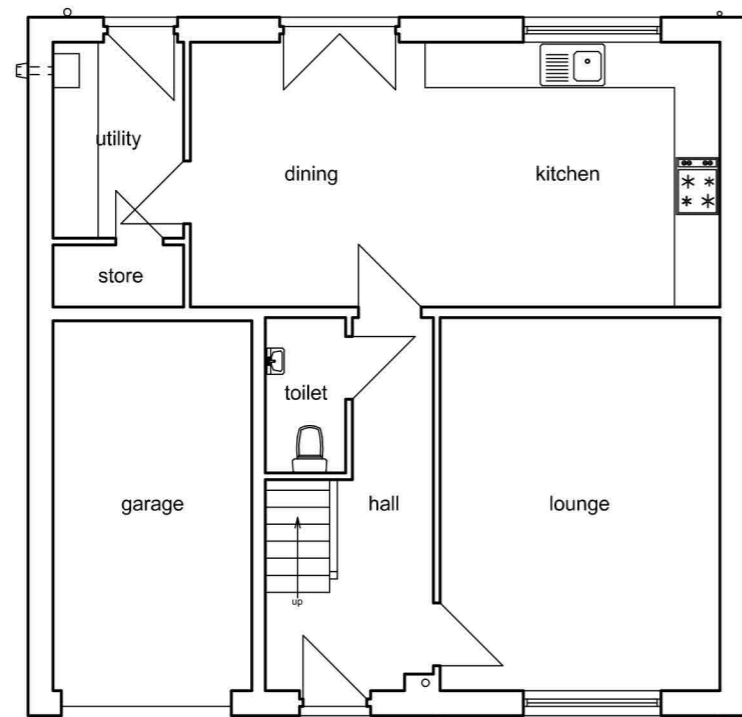

Ground Floor Plan

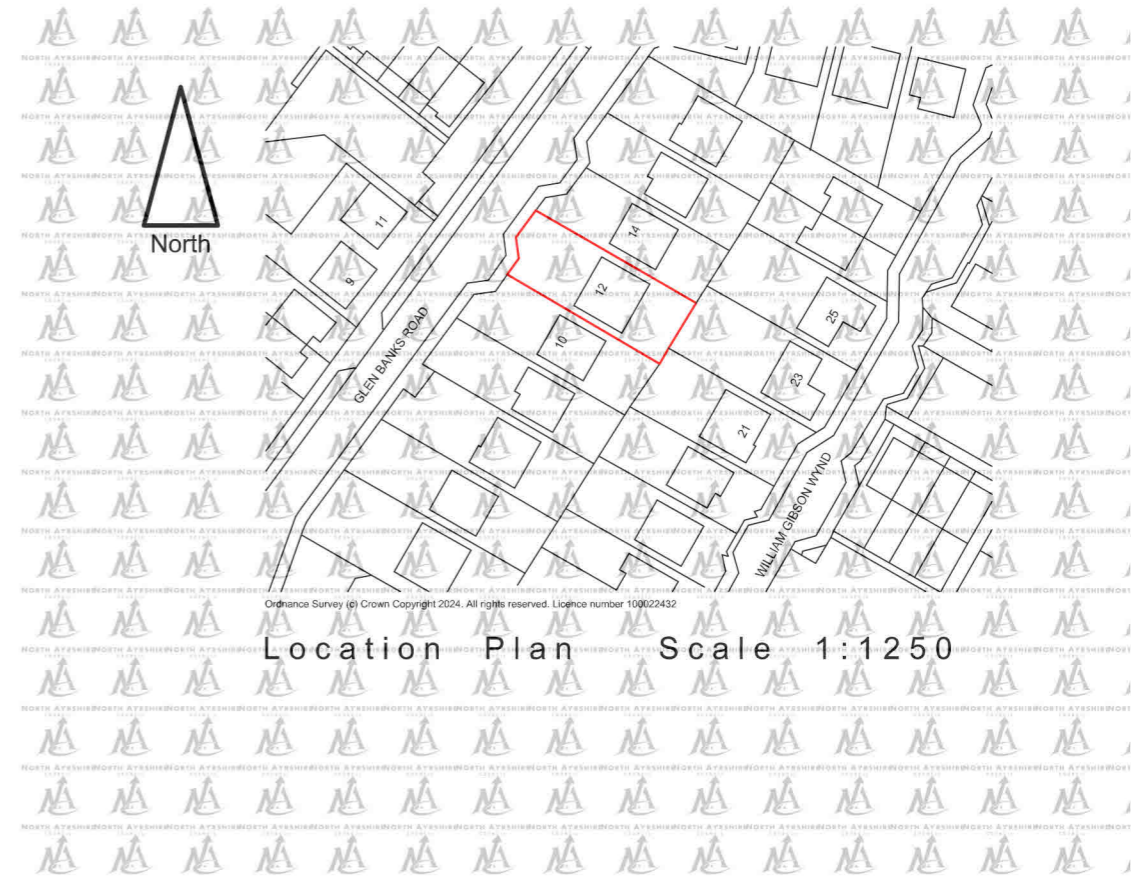

This is a true copy of the drawing referred to in the application dated2024

signed.....

Constructive Architectural Design Ltd.

Unit 5 Ladykirk Business Park,
Skye Road,
Prestwick, KA9 2TA
Tel: 01292 479355
e-mail: constructivedesign@btconnect.com

Client	Mr & Mrs S. Gibson		
Address	12 Glen Banks Road, Saltcoats, KA21 6BS		
Project	Proposed Rear Extension		
Drawing	Existing Floor Plans & Location Plan		
Date	March 2024	Scale	1:100
Drawn By	S. McCartney		
Job Ref.		Drawing No.	
24/1426		01	