

©Crown Copyright. All rights reserved. Licence no. 100019980

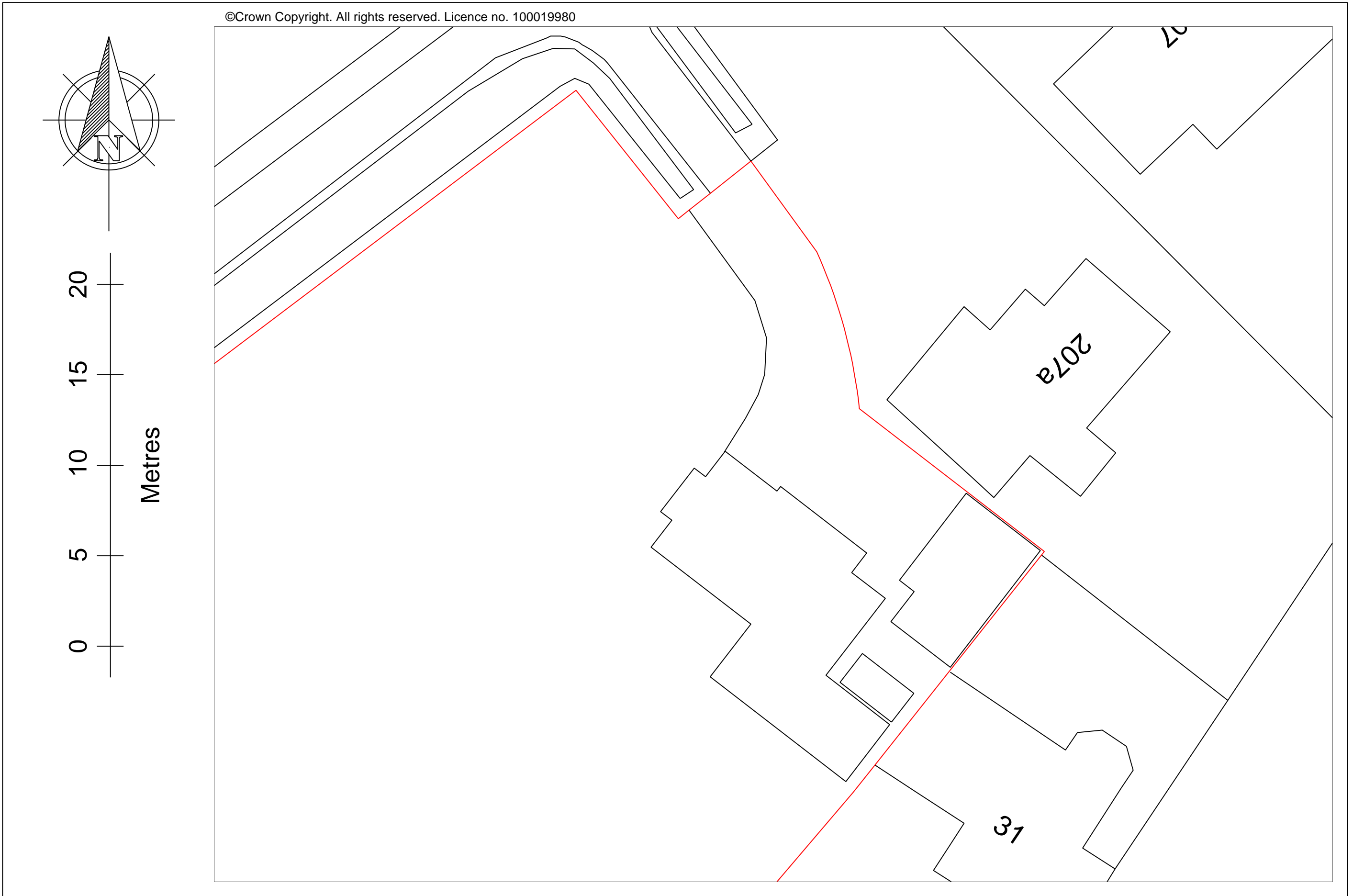

S- (13)02

Site Plans: Existing Block Plan
(Scale 1:200 @A3)

Date: July 2022 Drawing Number:22047GM-PP-S-(13)02
Client: Mr & Mrs G McNulty. Project: Extensions & Loft Conversion
Site Address: 209 Forest Road, Tunbridge Wells. TN2 5JA
Drawn By: Des Harman

Building Drawings
124a North Road, Hythe, CT21 5DY
www.building-drawings.co.uk