

**A HEDGES + TREES SPECIES (Any soil)**

1. Ivy (*hedera helix*) - climber
  2. Wild cherry (*prunus avium*) - tree
  3. Dog rose (*rosa canina*) - shrub
  4. Red campion (*silene dioecia*) - herbaceous perennial
  5. Wayfaring (*viburnum lantana*) - tree
- 
6. Field maple (*acer campestre*) - tree/shrub
  7. Hawthorn (*crataegus monogyna*) - shrub
  8. Common ash (*fraxinus excelsior*) - tree
  9. Holly (*ilex aquifolium*) - tree
  10. Blackthorn (*prunus spinosa*) - shrub
  11. Sugar maple (*acer saccharum*) - tree \*
  12. Apple (*malus spp.*) - tree \*
  13. Common lime (*tilia x europaea*) - tree \*

**B BEDS + BORDERS SPECIES (Any soil)**

1. Ivy (*hedera helix*) - climber
  2. Wild cherry (*prunus avium*) - tree
  3. Dog rose (*rosa canina*) - shrub
  4. Red campion (*silene dioecia*) - herbaceous perennial
  5. Wayfaring (*viburnum lantana*) - tree
- 
14. Forget-me-not
  16. Soapwort
  17. Clover
  18. Honesty \*
  19. Michaelmas daisies \*

**C 'AQUATIC' SPECIES (Moist soil)**

20. Cuckoo-flower (*cardamine pratensis*) - herbaceous perennial
21. Hemp agrimony (*eupatorium cannabinum*) - herb
22. Valerian (*valeriana spp.*) - herbaceous perennial
23. Guelder rose (*viburnum opulus*) - shrub
24. Willow (*salix spp.*) - shrub
25. Primrose (*primula vulgaris*) - herbaceous perennial

\* Non-native species.  
*Planting list obtained from Bat Conservation Trust's 'Landscape and urban design for bats and biodiversity' Appendix.*

- ENCOURAGING FORAGING:**
- Mixtures of flowering and fruiting trees and shrubs to encourage insect biodiversity.
  - Retaining areas of unmanaged wood with dense understorey.
  - Open areas to have a presence of flower rich meadows, scrub and groups of trees.
  - Create a freshwater source (pond).
  - Encourage climbing plants and creepers where possible.

- ENCOURAGING ROOSTING:**
- Retain mature and veteran trees wherever possible.
  - Mark trees which exhibit high levels of roosting (cracks, crevices, and holes).
  - Maintain buffer zones of trees and understorey around roost trees at least 1.5 times the canopy diameter of roost tree.
  - Deliberate measures for roosting provision, e.g. bat boxes and houses.

- ENCOURAGING COMMUTING:**
- Known bat commuting routes to be retained.
  - Improve commuting through avenues of trees and hedgerows to connect fragmented habitats.
  - Avoid creating gaps where possible.
  - Prioritise tall, wide and continuous hedgerows with vegetation around the base - three dimensional structure of garden.
  - Provide un-lit linear / linking zones.
  - Reduce the amount of permeable surfaces where possible, include planters, soften walls / fencing / railings with planting.

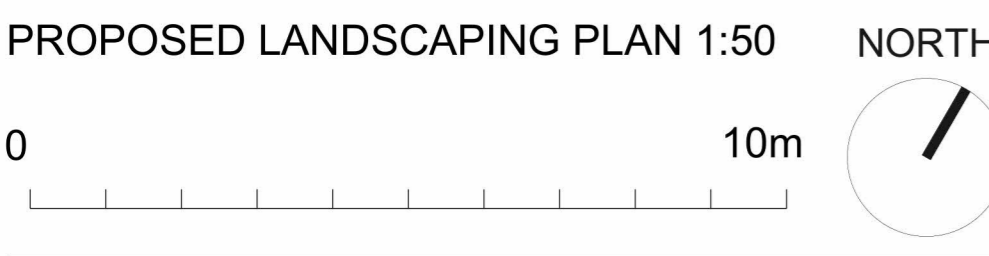

**PLANNING**  
 All dimensions in mm

Drawing number: PB23 - 103  
 Revision: Date: 27.03.2024  
 Scale: 1:50 @ A1

Drawing name: PROPOSED LANDSCAPING PLAN  
 Client: Jenny Hall & Mehdi El-Radhi  
 Project: Plas Bach, Aberystwyth Road,  
 Machynlleth, SY20 8EU

THESE DRAWINGS ARE NOT TO BE SCALED.  
 ALL DRAWINGS, THE DESIGN, AND THE DETAILS THEREON REMAIN THE PROPERTY OF CRAFTED SPACE AND ARE NOT TO BE ALTERED, RE-USED OR REPRODUCED WITHOUT WRITTEN CONSENT.  
 THE CONTRACTOR MUST FIELD VERIFY ALL DIMENSIONS AND MUST CONFIRM & CORRELATE ALL DETAILS WITHIN THE FULL DRAWING PACKAGE BEING RESPONSIBLE FOR SAME THROUGHOUT CONSTRUCTION, REPORTING ANY DISCREPANCIES TO CRAFTED SPACE PRIOR TO COMMENCING THE RELEVANT WORK.