

This is a scaled drawing for planning purposes. Contractor to check all dimensions on site prior to the commencement of the works.

NOTES

- 1 THIS DRAWING IS THE COPYRIGHT OF THE CONSULTANT AND MUST NOT BE USED OR REPRODUCED WITHOUT THEIR PERMISSION.
- 2 THIS DRAWING IS TO BE READ IN CONJUNCTION WITH ALL RELEVANT ARCHITECTURAL AND M&E DRAWINGS AND THE SPECIFICATIONS.
- 3 THE CONTRACTOR IS RESPONSIBLE FOR THE ACCURACY OF ALL DIMENSIONS AND THE CORRECT SETTING OUT OF THE WORK ON SITE.
- 4 THE CONTRACTOR SHALL PROVIDE ALL NECESSARY BRACING AND SAFEGUARDS TO ENSURE THE STABILITY OF THE STRUCTURE AND ALL ASSOCIATED PARTS AT ALL TIMES DURING CONSTRUCTION, AND SHALL ENSURE THAT ALL WORKS ARE CARRIED OUT IN STRICT ACCORDANCE WITH THE CONSTRUCTION (DESIGN & MANAGEMENT) REGULATIONS.
- 5 ALL NEW FOUNDATIONS HAVE BEEN DESIGNED FOR A SAFE BEARING PRESSURE OF 100kN/M<sup>2</sup>. IF BAD GROUND IS ENCOUNTERED IT SHOULD BE REMOVED AND REPLACED WITH LEAN MIX CONCRETE 1:20MIX.
- 6 CONCRETE MIXES  
CONCRETE BLINDING 15N/mm<sup>2</sup> MIX.  
MASS CONCRETE FOUNDATIONS 30N/mm<sup>2</sup>.  
PADSTONES 20N/mm<sup>2</sup> MIX.  
ALL REINFORCED CONCRETE 35N/mm<sup>2</sup> MIX.
- 7 STEELWORK  
ALL STRUCTURAL STEELWORK TO BE OF MILD STEEL GRADE S275. STEELWORK SHOP DRAWINGS TO BE SUBMITTED IN DUPLICATE TO S.E. FOR APPROVAL PRIOR TO COMMENCING FABRICATION. CONNECTORS TO BE ISO ZINC COATED HEXAGONAL BOLTS AND NUTS TO B.S.4190. WELDING SHALL BE METAL ARC TO THE APPROPRIATE BRITISH STANDARDS. ALL STEELWORK SHALL BE PREPARED USING UNIT OR SHOT BLASTING. SURFACE FINISH TO BE 2ND QUALITY. ALL STEEL WORK ABOVE GROUND IS TO BE PROTECTED BY ZINC RICH PREFABRICATION PRIMER FOLLOWED AFTER BY ONE COAT OF ZINC RICH PRIMER, ONE UNDERCOAT AND ONE GLOSS COAT BOTH OF MICACEOUS IRON OXIDE PAINT. ALTERNATIVE PREPARATIONS, PRIMING AND FINISHING MAY BE USED ON THE WRITTEN APPROVAL OF THE S.E. ALL STEELWORK BELOW GROUND SHALL BE LEFT UNPAINTED AND ENCASED IN 100mm DENSE CONCRETE.
- 8 THE STEELWORK CONTRACTOR IS TO DESIGN ALL CONNECTIONS AS SHOWN ON DRAWINGS.
- 9 USE FIGURED DIMENSIONS ONLY. SUBJECT TO SITE SURVEY AND ALL NECESSARY CONSENTS. ALL DIMENSIONS TO BE CHECKED BY USER AND ANY DISCREPANCIES OR OMISSIONS TO BE REPORTED TO THE S.E. BEFORE WORK COMMENCES.
- 10 THE CONSTRUCTION (DESIGN AND MANAGEMENT) HEALTH AND SAFETY 2015 REGULATIONS APPLY TO THIS PROJECT.
- 11 THE CLIENT MUST ENSURE THAT SUITABLE ARRANGEMENTS ARE IN PLACE BEFORE WORKS COMMENCE.



Horizontal Section

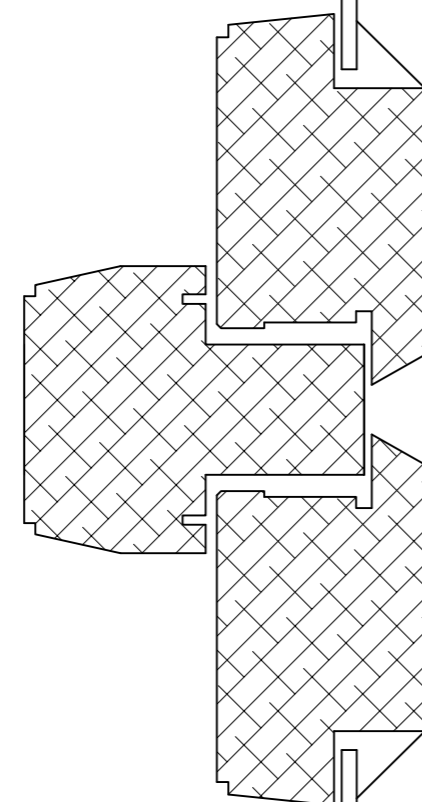
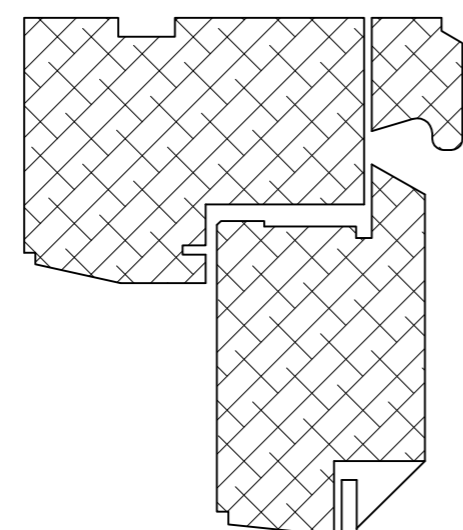

Inside

Outside



Vertical Section 1 : 2 @ A1

Window GF 01, Fanlight over opening casement

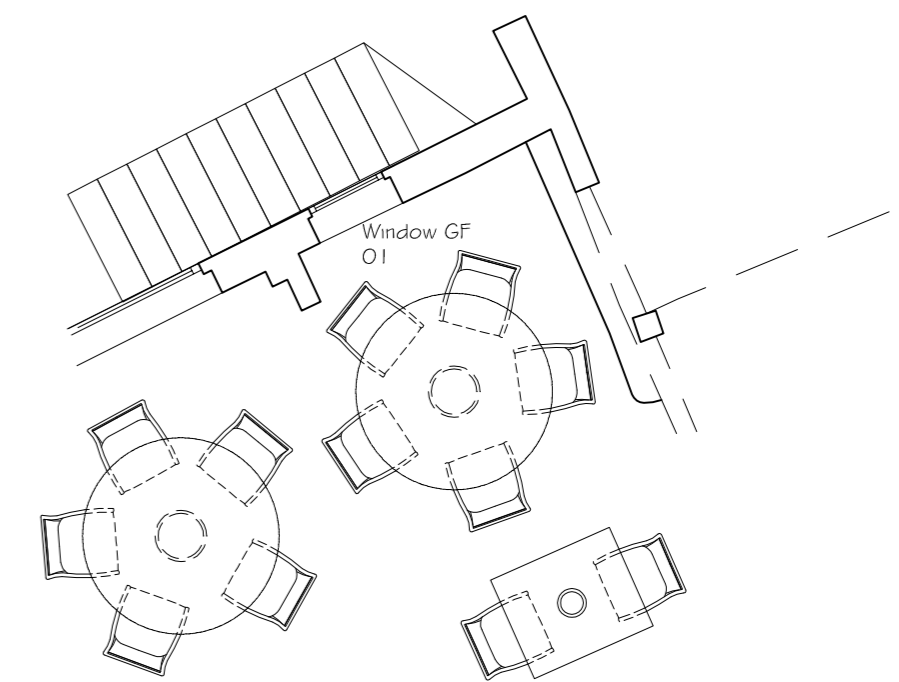

Part Floor Plan 1:50

REV		DATE
CLIENT	MR AHMET TOPCU	
PROJECT	21 - 23 CHURCH STREET, BASINGSTOKE	
TITLE	Window Replacement	
Minton House, London Road, Amesbury, SP4 7RT Tel: 01980 677722 Fax: 01980 655587		
email:eng@jcpengineers.co.uk		www.jcpengineers.co.uk
SCALE 1:2 & 1:50 @ A1	DATE March 2017	DWG NO 9399-25
DRAWN	CHKD	REV