

This drawing is the copyright of the architectural designer Matthew Goodchild. It is a planning purposes and may not be reproduced in whole or in part without permission. The content is subject to site survey and H&S risk assessment prior to construction. Do not scale from drawings.

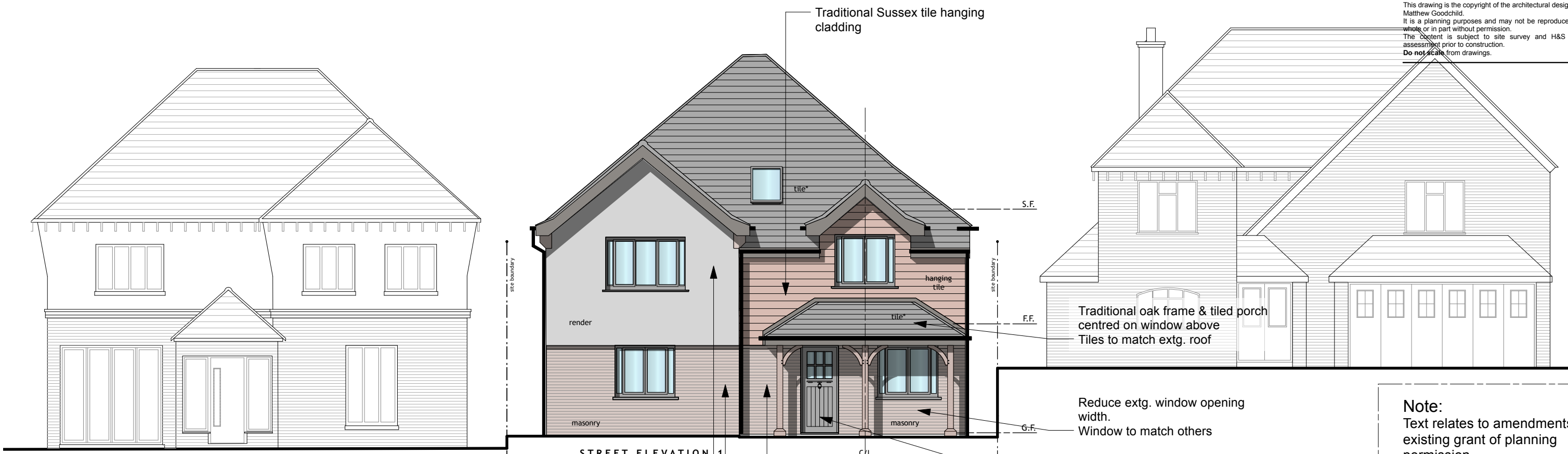

Reduce extg. window opening width.
Window to match others



Traditional main entrance without side light window

Note:
Text relates to amendments to existing grant of planning permission.
23 June 2023
No: BH2023/00492

STREET ELEVATION 1

Masonry - replace extg. poor quality masonry

Render - make good extg. Colour light grey

Traditional Sussex Tile Hanging - To match local vernacular - plain single or double camber clay tile	Render - Sand & Cement - Light Grey	Brick - FLB Multi - Dark Red
		

Traditional Sussex tile hanging cladding - Make good extg. substrate

Render finish - make good extg. substrate Colour light grey

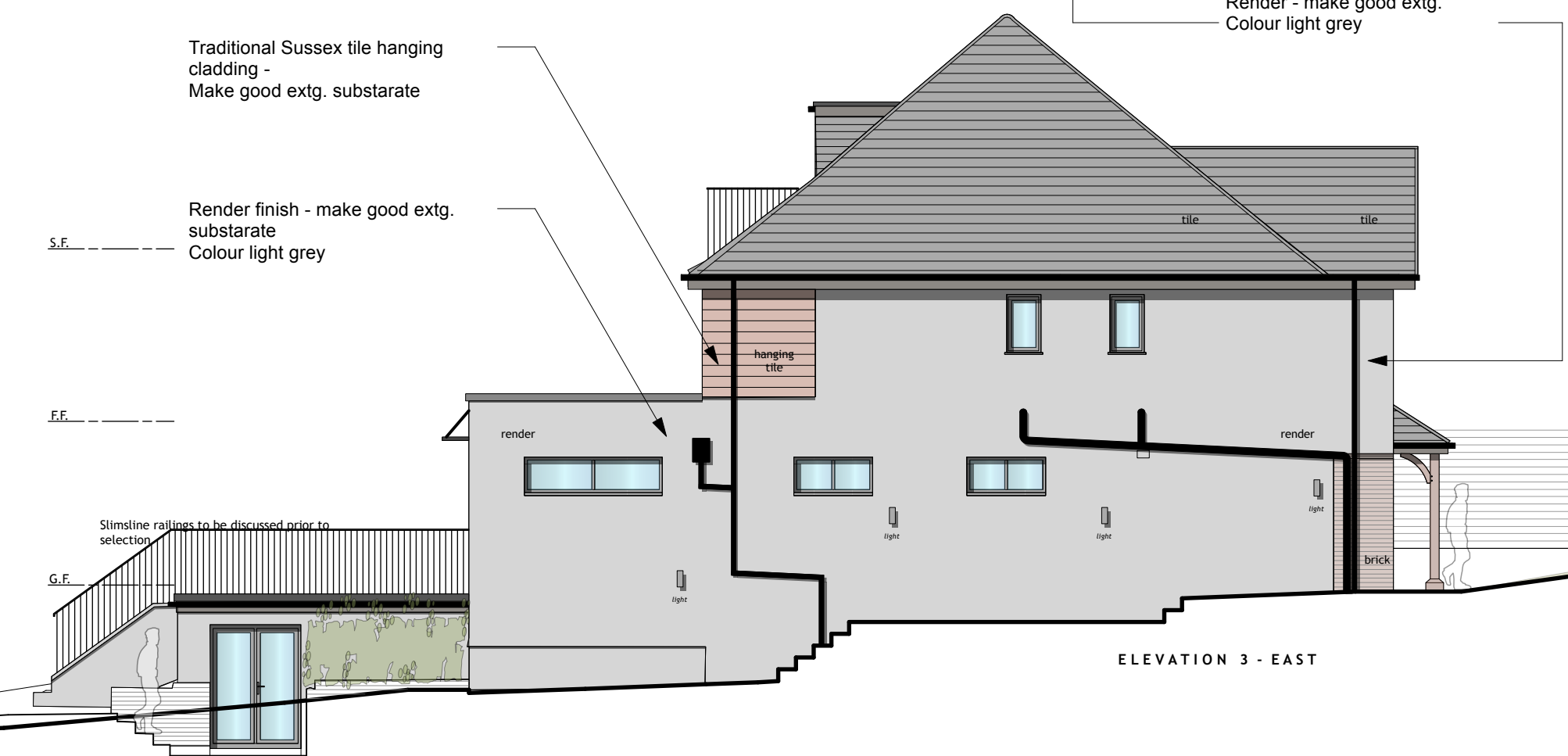

ELEVATION 3 - EAST

Rev	Date	Description	By
-----	------	-------------	----

MATTHEW GOODCHILD
architectural DESIGN
e: mgarchitecturaldesign@gmail.com
w: mgarchitecturaldesign.com

Client
Patterson Family Home
Project
6 TONGDEAN AVENUE
HOVE

Drawing
PROPOSED ELEVATIONS
With amendment notes for
Variation of Condition

Scale	Status	Date	Drawn	Checked
1:100 @ A3	P3 - PLANNING	03/24	MG	

Drawing No. **115-P122** .

