

PROPOSED CAR WASH LAYOUT PLAN / CABIN ROOF PLAN

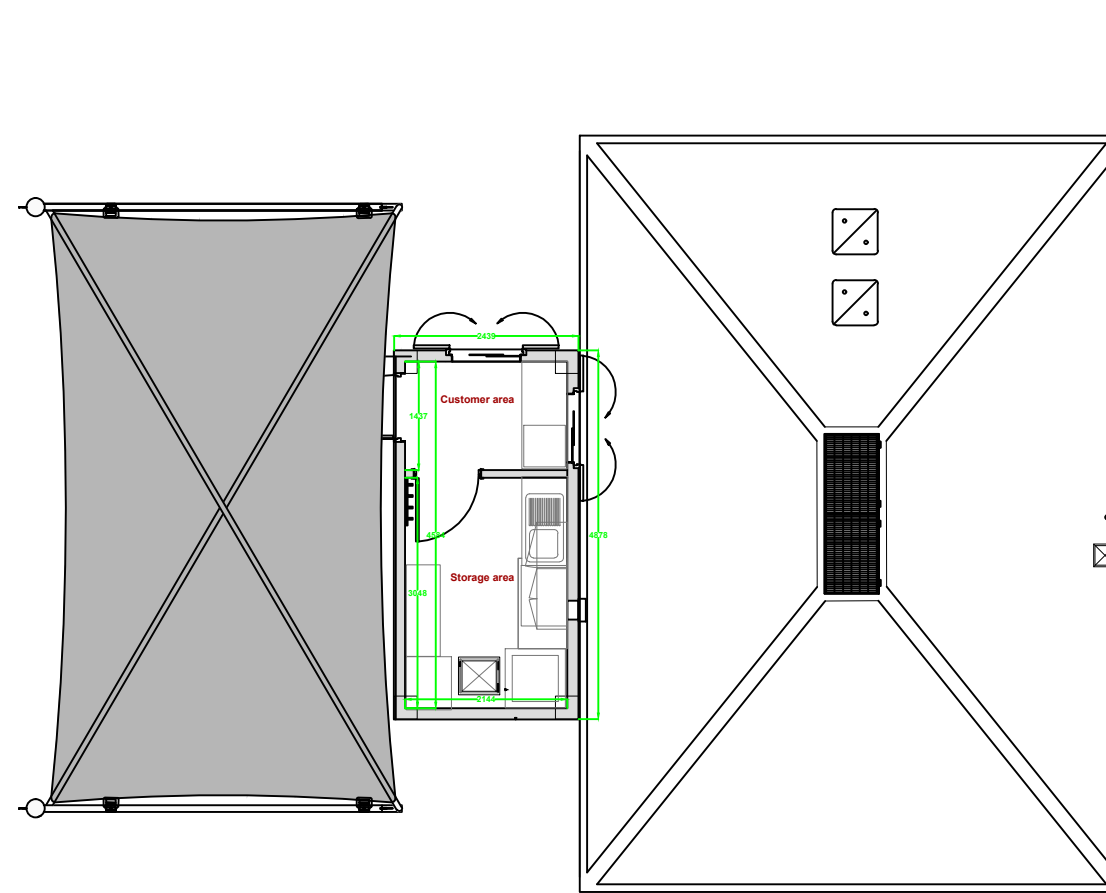

PROPOSED CAR WASH LAYOUT PLAN / CABIN FLOOR PLAN

SCALE BAR 1:100



Notes:

Hand car wash will be installed over 12 parking bays. Six used to install the concrete wash pad and used as the wash area. Two used to position the steel cabin and four to be used as the dry valeting area with a 2 post canopy over.
Please see accompanying design and access for more information.



REV:	DESCRIPTION:	BY:	DATE:
STATUS:			
PLANNING			
 Gilmore Consultancy 1 Castle Court Brewhouse Lane London SW15 2JJ 07975852755 planning@gilmoreconsultancy.com			
SITE: Homebase Discovery Park, Westhampnett Rd, Chichester, PO19 6UX			
TITLE: Proposed hand car wash layout plan			
SCALE AT A3: 1:100	DATE: 28.02.24	DRAWN: JB	CHECKED: JB
PROJECT NO: n/a	DRAWING NO: HB-hcw-install-02/24-003	REVISION: n/a	