

Existing Rear Elevation

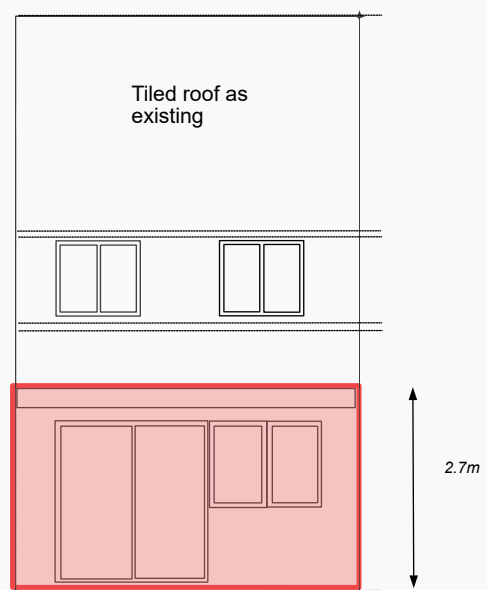

Proposed Rear Elevation

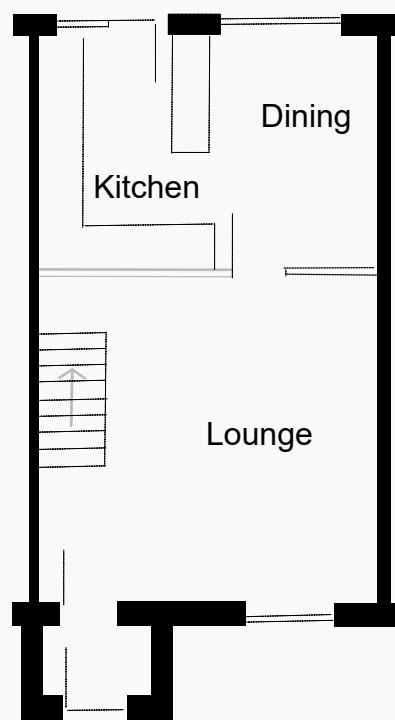

Existing Ground Floor

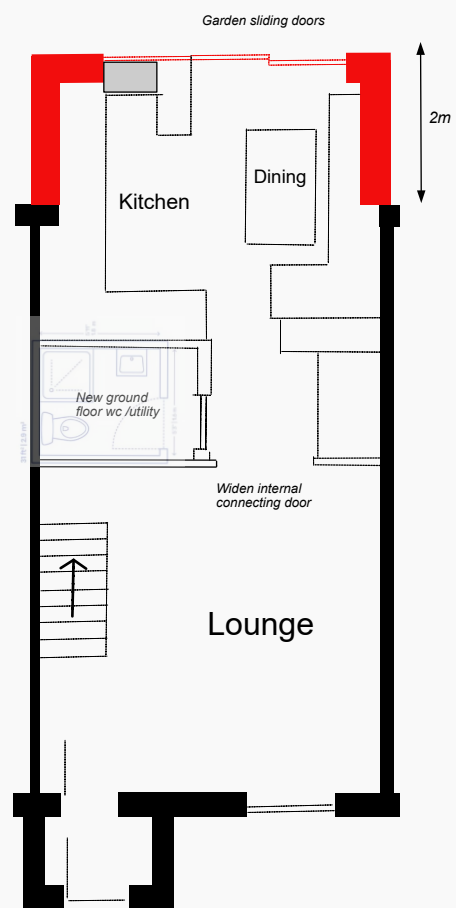

Proposed Ground Floor

103 Tamworth Road,  
Hertford. SG13 7DN

Proposed Single Storey  
Rear Extension

Ground Floor Plan and Rear Elevation  
Existing and as proposed

**Drawing: No 01**

**Date: April 2024**

Scale: 1:100 @ A3

