

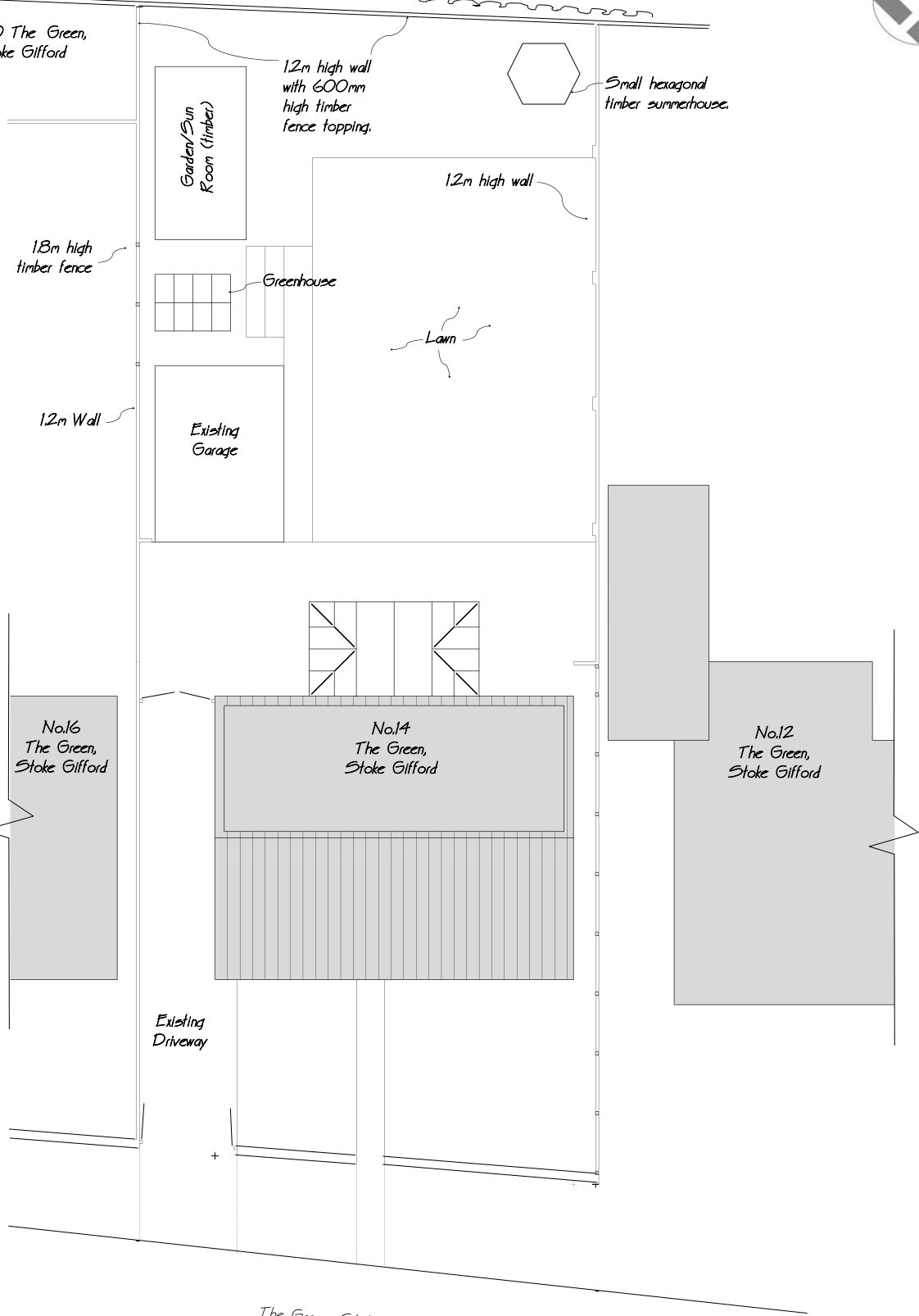

No.20 The Green,
Stoke Gifford



**PLANNING
ISSUE**

EXISTING BLOCK PLAN 1:200

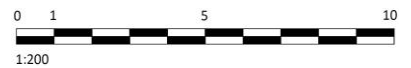

**REPLACEMENT GARAGE AND GARDEN ROOM AT
14 THE GREEN, STOKE GIFFORD, BRISTOL B34 8PD**

DRAWING No. BR 02 - EXISTING BLOCK PLAN
Rev: A 00/00/202? -

SCALE 1:200

MARCH 2024