

Ground Floor

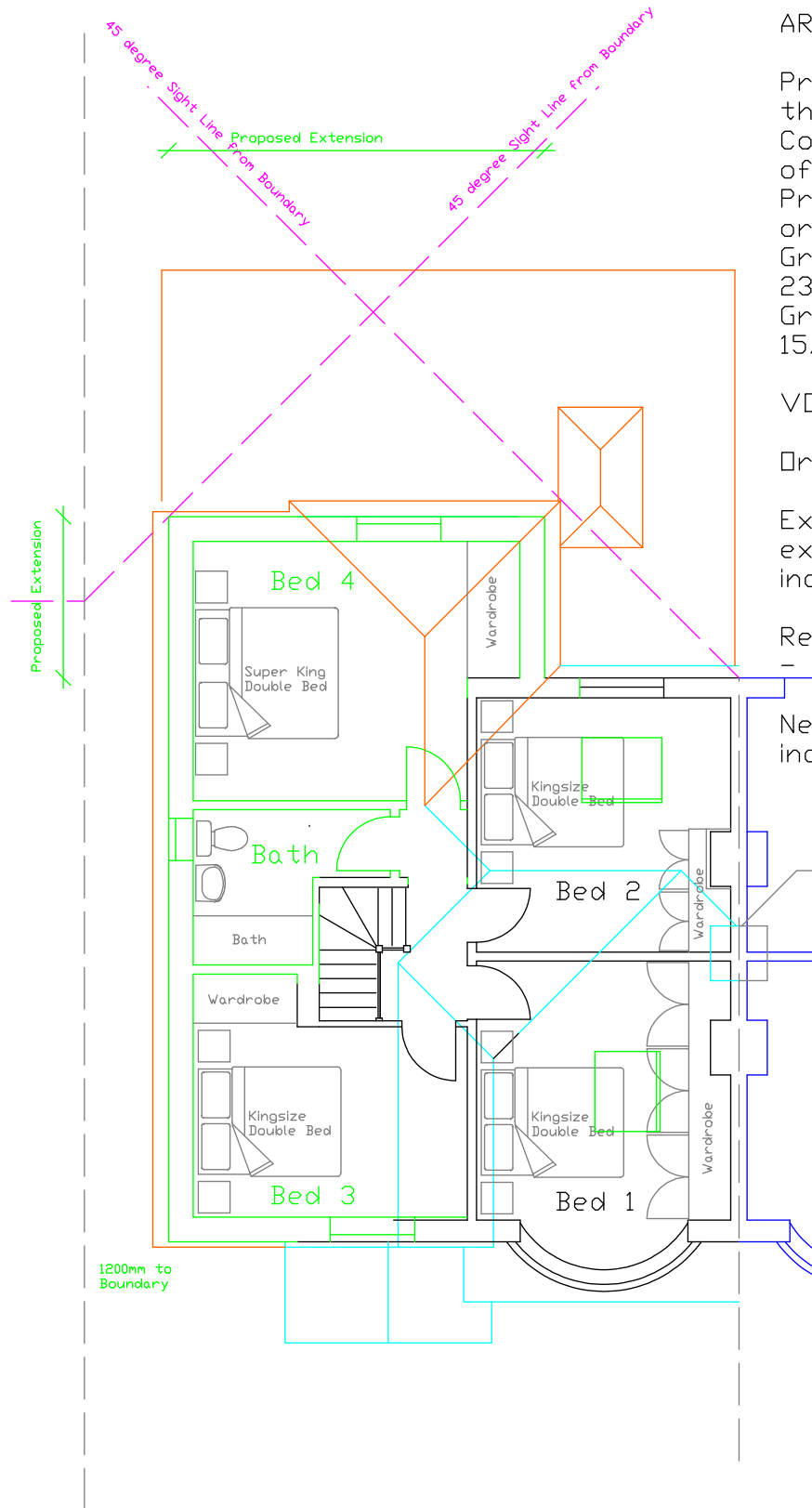

First Floor
Existing Roof
Proposed Roof

AREA CALCS:

Property is a SMALL DWELLING for the purposes of the Green Belt SPD. Confirmed as 109sqm in the previous officer report at para 7.1.5. Proposed area (over and above original) - 189 sqm - 73%.
Granted at 11 Hyde Lane under 23/0361/FUL - 70%.
Granted at 12 Hyde Lane under 15/0324/FUL - 75%.

VOLUME CALCS:

Original property 419.68 m³.
Existing property, with the existing extensions 549.34 m³ - a 31% increase existing on site.
Refused, appeal scheme 682.29 m³ - a 63% increase.
New proposal 625.37 m³ - a 49% increase.

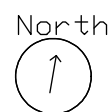
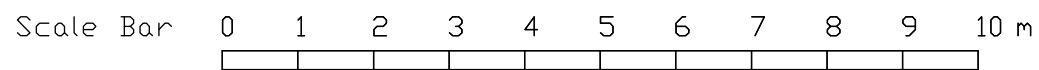

Proposed Extension for :-
Mr & Mrs M Cooper
13 Hyde Lane, Nash Mills,
Hemel Hempstead HP3 8RY

Title :-
Proposed Floor Plans

Scale 1 : 100 @A3 Date 28/03/24

Prepared by:-
Nigel G Hammond MCIOB

DRW. NO. 05 Rev H