

Ground Floor

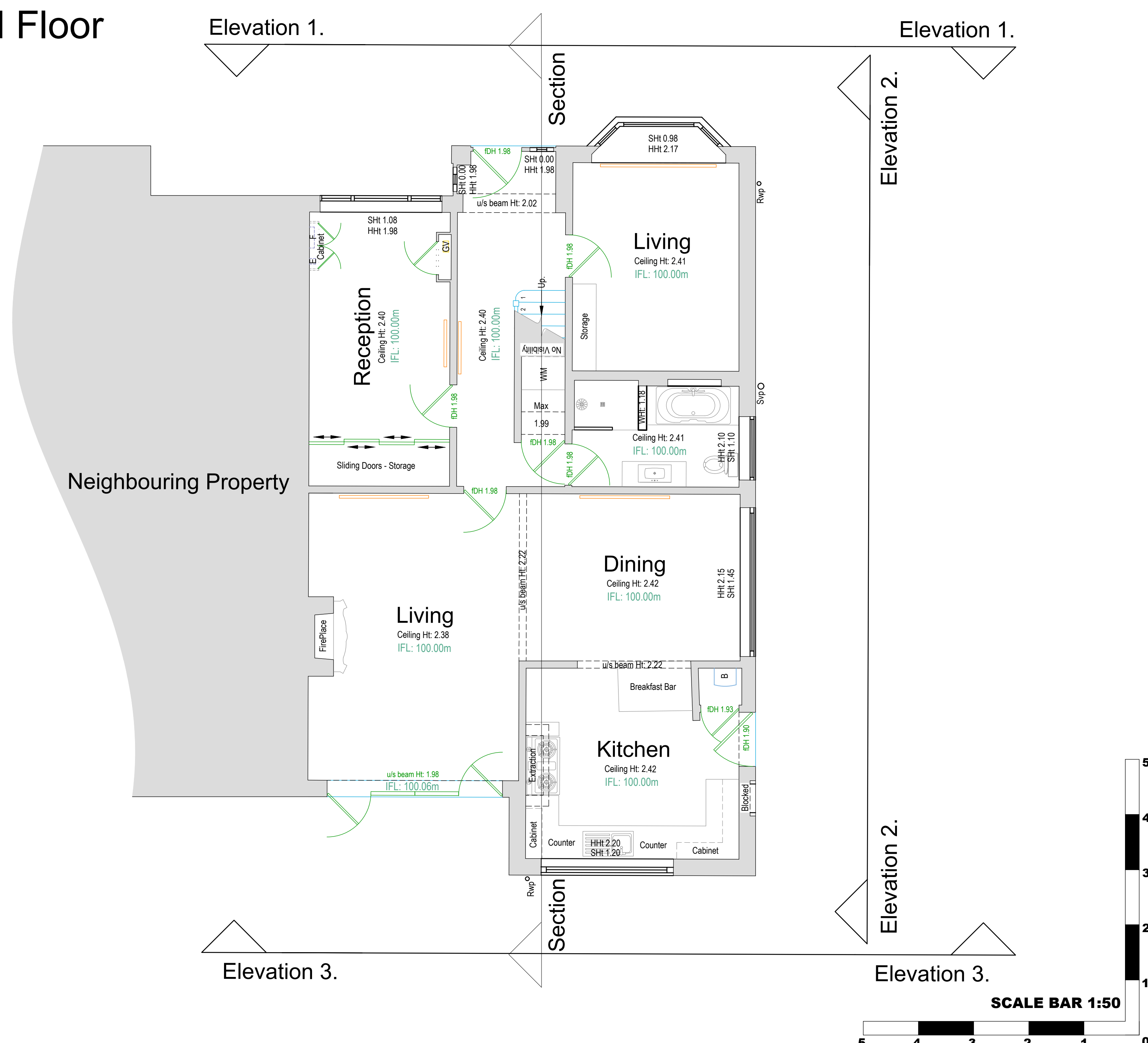

Approximate

OS Note:
Some services may have been omitted due to parked vehicles. The Ordnance Survey site is to be used as a guide only.

This survey has been orientated to the Ordnance Survey (O.S.) National Grid OSGB36(15) via Global Navigational Satellite Systems (GNSS) and the O.S. Active Network (OS Net). A true OSGB36 coordinate has been established near to the site centre via a transformation using the OSTN1GB5 & OSGB15GB transformation models.

The survey has been correlated to this point and a further one or more OSGB36(15) points established to create a true O.S. bearing for angle orientation.

No scale factor has been applied to the survey therefore the coordinates shown are arbitrary & not true O.S. Coordinates which have a scale factor applied.

Please refer to Survey Station Table to enable establishment of the on-site grid.

Comments

This plan should only be used for its original purpose. iG Surveys accepts no responsibility for this plan if supplied to any party other than the original client.

All dimensions should be checked on site prior to design and construction.
Drainage information (where applicable) has been visually inspected from the surface and therefore should be treated as approximate only.

Key:

SHt 1.00	Sill Height from Finished Floor Level.
HHt 2.12	Head Height from Finished Floor Level.
Susp Ceiling Ht: 2.00	Suspended Ceiling Height from FFL.
Ceiling Ht: 3.00	Structural Ceiling Height from FFL.
IFL: 100.00m	Internal Floor Level (General).
+100.00m	Internal Floor Level (Specific).
Insertion Point	Insertion Point for overlay drawings of other floors or details.
100.00	Height indicator showing level above Ordnance datum.

Client

JMJ Architecture

Project Address

8 Lawnswood Avenue
Burntwood
WS7 4YD

Drawing Title

Ground Floor Plan

Scale	Paper Size
1:50	A2
Drawn By	Date
NDK	03/01/2024

Level Datum Arbitrary

Grid Orientation Arbitrary

Drawing Number J440-01

Notes



iG Surveys Ltd
Unit 1 Garden Court,
Gee Road, Coalville
Leicestershire
LE67 4NB

