

PHYSICAL SCALE IN METERS @ 1:1250

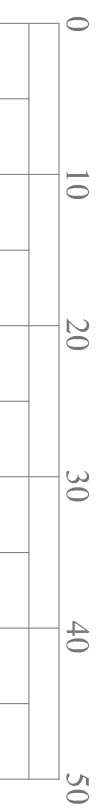

PHYSICAL SCALE IN METERS @ 1:500

NOTES:
 This drawing has been produced solely for PLANNING/DESIGN.
 Do not scale from this Drawing except for planning purposes.
 Any drainage shown is presumed and to be checked on site
 before commencement of works.
 This drawing is the copyright of MF Designs Ltd.

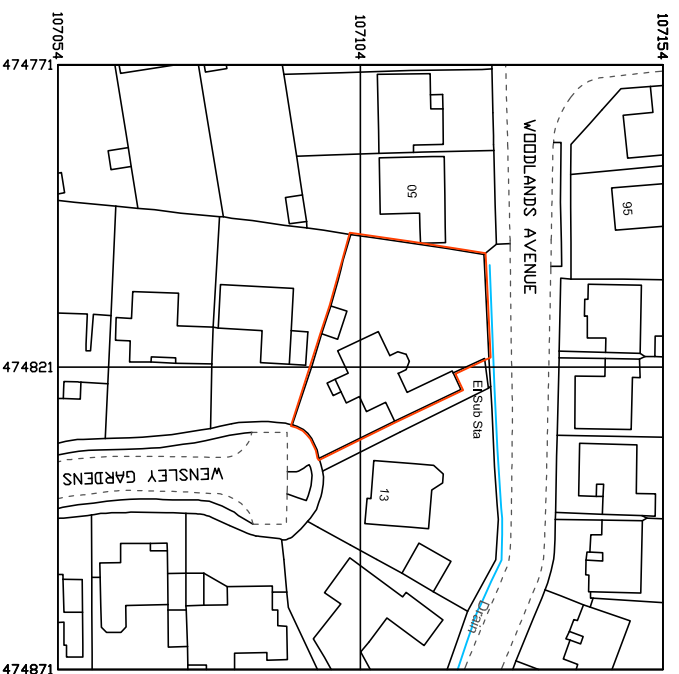

Produced on 05 April 2024 from the Ordnance Survey National Geographic Database and incorporating surveyed revision available at this date.
 This map shows the area bounded by 474771, 107054, 474871, 107154, 474771, 107154, 474771, 107054
 Crown copyright and database rights 2024 OS 100054135. Supplied by copla ltd trading as UKPlanningMaps.com a licensed Ordnance Survey partner (OS 100054135).
 Data licence expires 05 April 2025. Unique plan reference: vie/1088591/1457622

Location

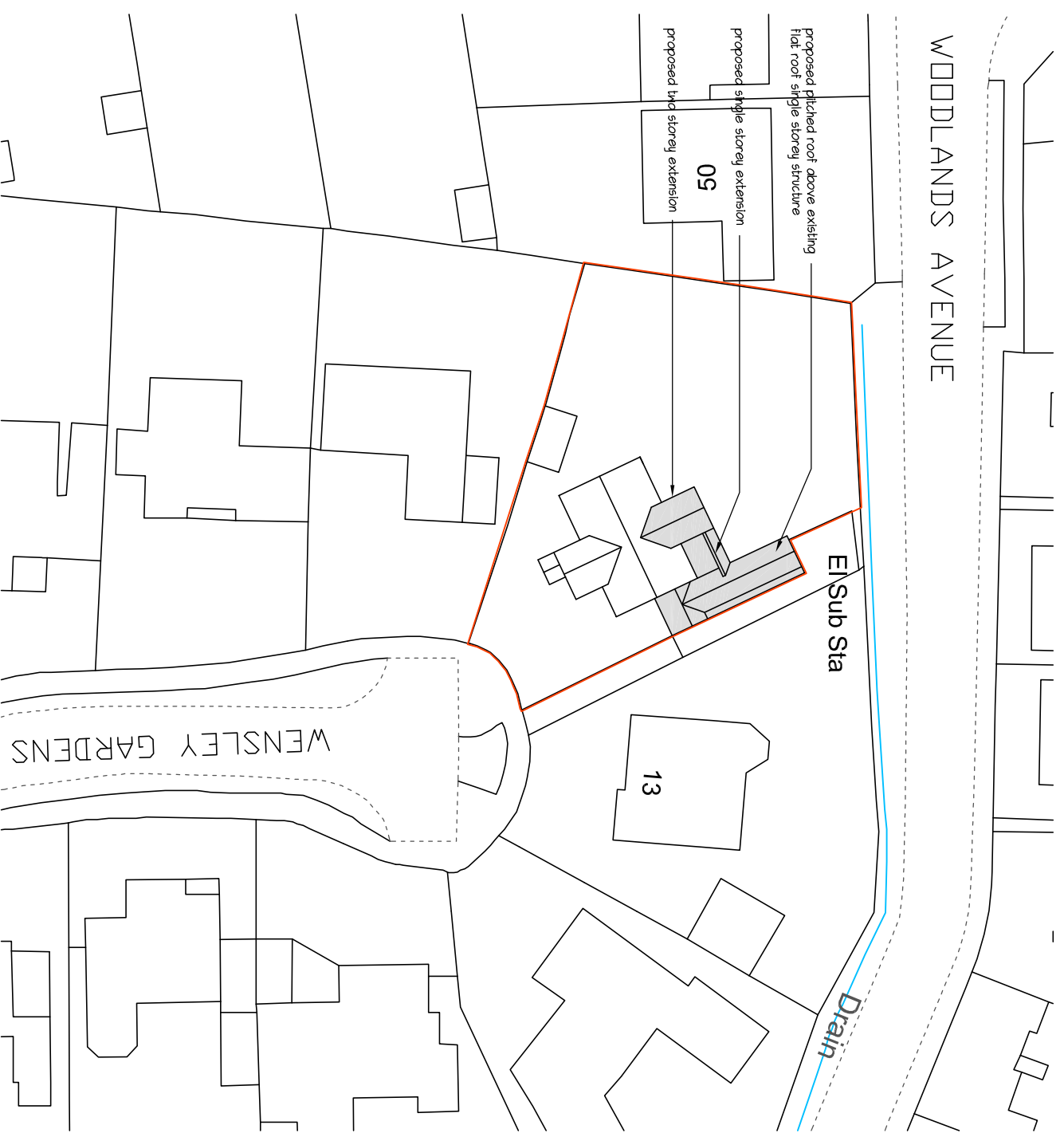

mf designs ltd
 Chartered Architects



36 Grove Road • Havant • Hampshire • PO9 1AR
 Director: Martin Farrer RIBA • Co Registration No.4507379

U/ 02392 470967
 e admh@mfdesigns.org.uk

Date: April 2024
 Scale: 1:1250/500

Job No: 3335
 Dwg No: P_03

EXTENSION & ALTERATIONS - 12 Wensley Gardens, Emsworth. PO10 7RA