

130mm cavity with 75mm Kingspan Kooltherm K108 Cavity Board insulation (partial fill cavity insulation), min. 50mm clear cavity between insulation and outer leaf to be maintained

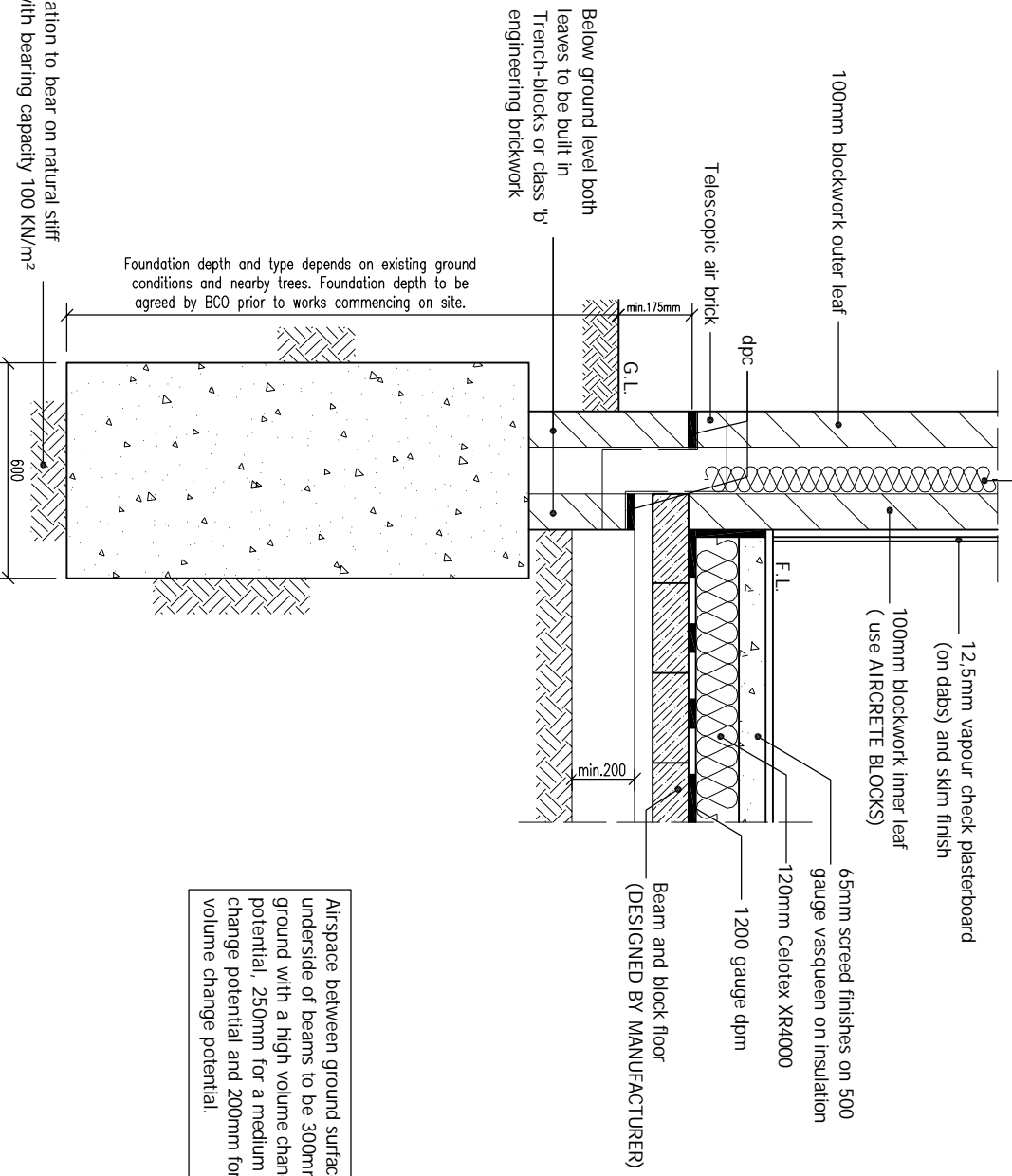

### TYPICAL FOUNDATION DETAIL

Scale 1:20

130mm cavity with 75mm Kingspan Kooltherm K108 Cavity Board insulation (partial fill cavity insulation), min. 50mm clear cavity between insulation and outer leaf to be maintained

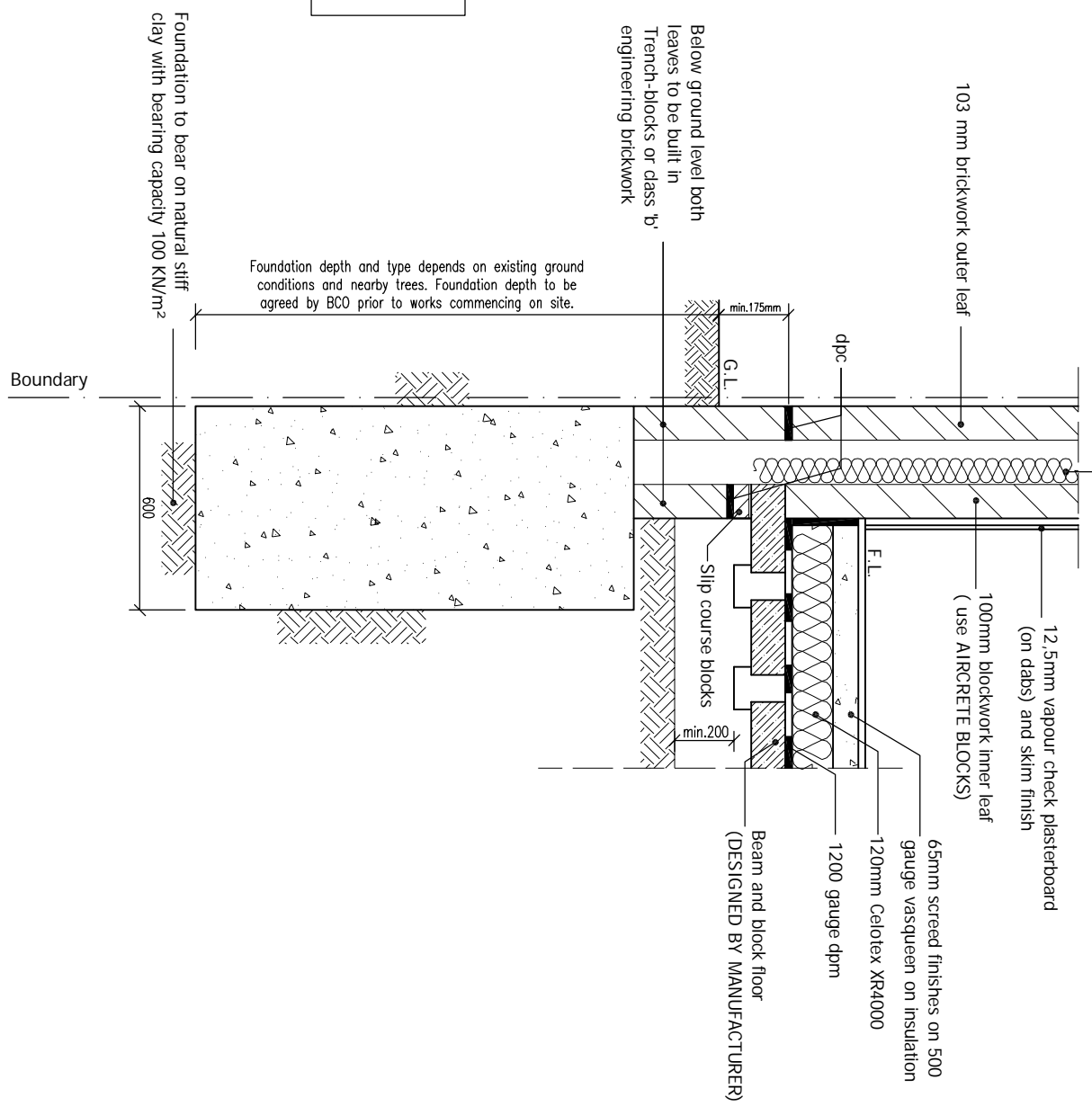

### FOUNDATION DETAIL ON BOUNDARY

Scale 1:20

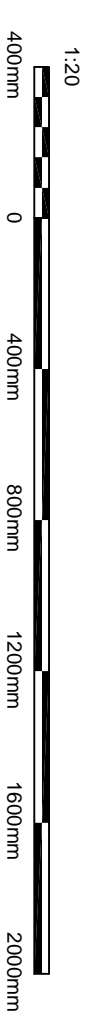

© This drawing and the works shown are the copyright of DISCOUNT PLANS LTD and may not be reproduced except by written permission

DRAWING STATUS	PLANNING		
REV.	DATE	NAME	DESCRIPTION

Architectural Design Studio

**DPL**

4 ST ANNES, DORIC WAY,  
EUSTON, LONDON NW1 1LG  
+44 07838 135 957

#### GENERAL NOTES:

1. Any dimensions shown are indicative only and are subject to verification on site. The contractor to set out, check and co-ordinate all dimensions on site during the course of the works and prior to setting out on site. This drawing to be read in conjunction with all other Architect's and Engineer's drawings, Structural Engineers calculations and any specialist supplier drawings. Homeowner is responsible and should ensure that all working drawings and calculations are completed, approved by Building Control or Planning Departments & that they are the current revised drawings before any works start on site.
2. Inform the Building Control department that the works are about to commence on site after receiving an approved decision from planning / building control in writing for your proposed works.
3. Verify boundary lines & ground conditions including checking positions and new connections of all gas, water, electricity, drainage, etc. before commencing works. If necessary, arrange for a gas safety check, water test, etc. to be carried out by a qualified professional before commencing works.
4. DPL are not responsible for builders changing design methods from proposed works. The client is responsible for any additional structural design changes on site from the start to end of building works requested by building control or any other third party's instruction during building works.
5. DPL are not responsible for any additional structural design changes on site from the start to end of building works requested by building control or any other third party's instruction during building works.
6. Request a copy of the Party Wall Award where works affect party wall or involve excavations within 3 meters of adjoining buildings or building over a public sewer. (Client's responsibility)

#### 7. Where works involve demolition to ensure that all elements of the building and adjoining structures are accounted for and that all necessary propping and temporary supports are in place. Do not scale off this drawing as the scaling may be off.

8. Works carried out under a building notice or prior to approval of drawings are of the Contractor's/Guard's risk. (All DPL drawings must be approved before works commence)
9. Any discrepancies, either between written and site dimensions or between this drawing and other consultant's or supplier drawings, should be brought to the immediate attention of DPL before executing the structural, drainage, mechanical and electrical works which is on site then this will need to be brought to DPL attention straight away before work commences and purchase of materials be made so an alternative design can be reached and approved by building control or the engineer before works commence.
10. All DPL structural designs are subject to building control approval. If necessary, the contractor should be advised of any additional work being implemented on site during construction. If required by an engineer, a written order should be issued on site by building control inspector/builder for load bearing or non-load bearing status before purchase of steel/a. If non-load bearing then steel should not be ordered. No refund or claim can be given against DPL on the design/materials changed for these steel/a.

#### OTHER NOTES:

11. All new proposed roof and wall finishes on this drawing to match existing materials. All new proposed roof and wall finishes should be specified in the drawing. For a permitted development, the roof should be of a similar material to the existing roof. For a full planning application, the roof should be of a similar material to the existing roof. For a full planning application, the roof should be of a similar material to the existing roof.
12. All drawings connections is assumed & is subject for checking by builder, Thomas water & building control, if necessary, arrange for a gas safety check, water test, etc. to be carried out by a qualified professional before commencing works.

#### ALL STRUCTURAL ELEMENTS (such as beams, lintels, joists, rafters, columns, walls, foundations and etc.) SHOWN ON DRAWINGS ARE ONLY INDICATIVE. THEY ARE SUBJECT TO FURTHER STRUCTURAL ENGINEER'S CONSIDERATION.

SITE ADDRESS  
16 RALEIGH DRIVE,  
WHESTONE, LONDON, N20 0UU

DRAWING TITLE  
PROPOSED DRAWINGS

DRAWN AT HEAD OFFICE  
SCALE AS SHOWN  
DRAWING NO. DPL.11.  
REVISION -

DRAWN BY  
10. APRIL 2024  
WWW.DISCOUNTPLANS.LTD.COM