

SCALE BAR 1:10
0m

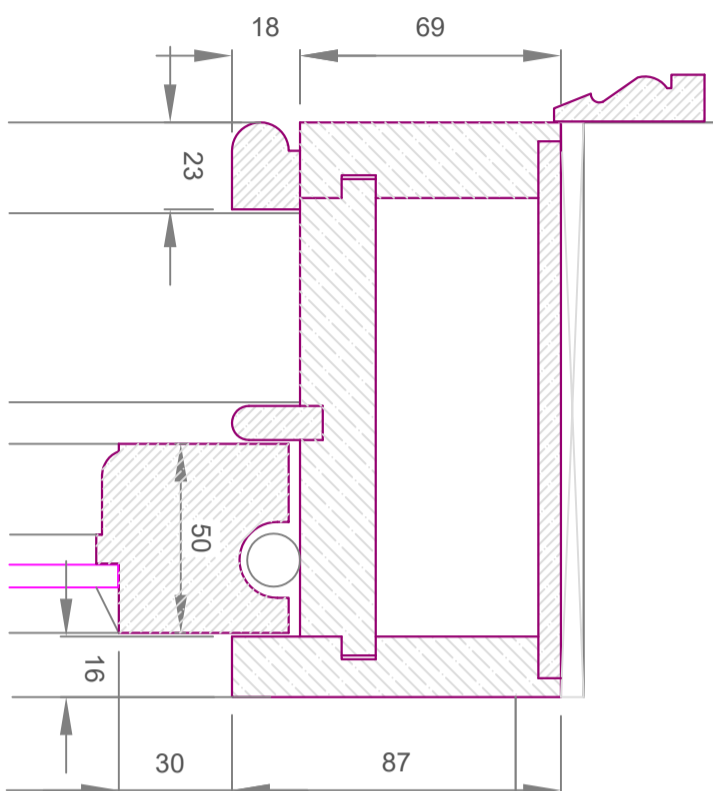

DETAIL C - HEAD SECTION

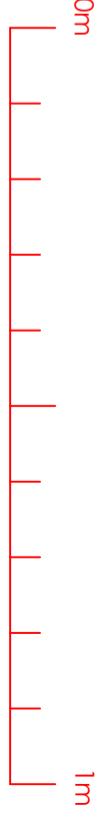
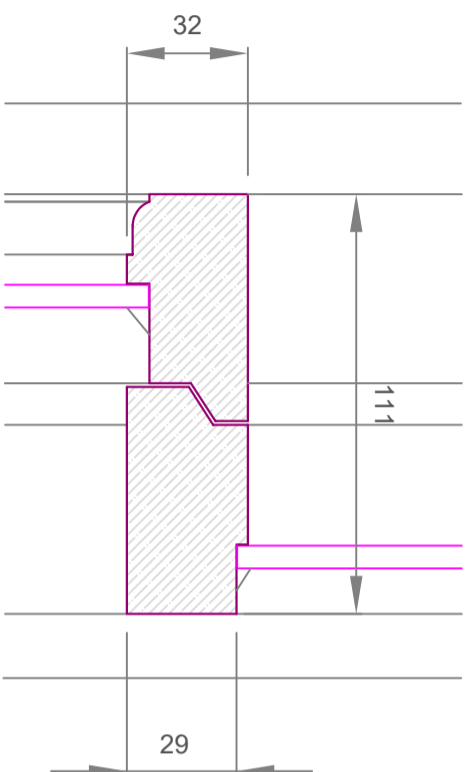

DETAIL D - MID RAIL

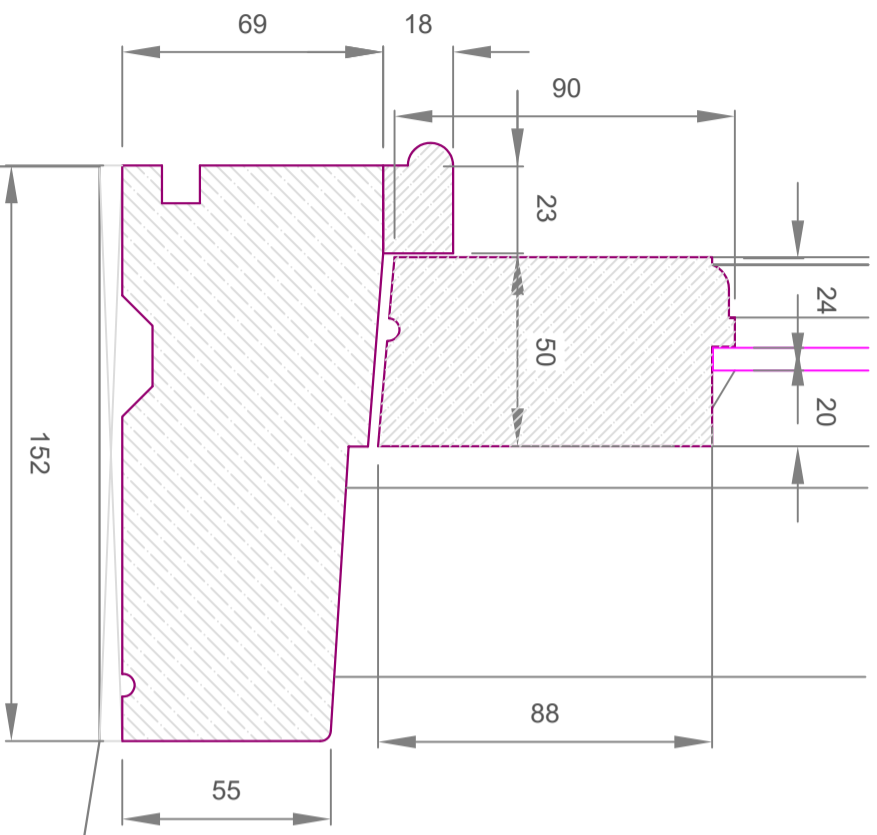

DETAIL E - CILL SECTION

REVISIONS:

PLANNING ISSUE

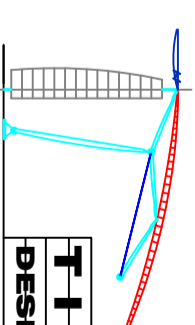

TILBY
DESIGN LTD.

Architectural + Design Services

52 KINGSDOWN ROAD, WALMER, DEAL, KENT, CT14 7LH.
TEL : 01304 373806 MOBILE : 07810 395968
E-MAIL: tilbydesignltd@yahoo.co.uk WEBSITE: tilby-design-ltd.com

Client

TREVOR PEARCE

Project

**PROPOSED ALTERATIONS
124 MIDDLE STREET, DEAL, KENT. CT14 6JX**

Drawing Title

AS PROPOSED - WINDOW JOINERY DETAILS 2

Date	Scale	Drawn by
MARCH 2024	1:2 @ A3	DCT

Project No.	Drawing No.	Revision
2024(10)	11	