

PROPOSED

NOTES:

© SIFA architecture.
The use of these plans and specifications is restricted to the original site for which they were prepared. Re-use, reproduction or publication by any method in whole or in part is prohibited, unless authorised by SIFA architecture. Ownership of the design, plans and specifications is solely with SIFA architecture.

| | | | |
|------|--------------|-----|-------|
| REV: | DESCRIPTION: | BY: | DATE: |
| | | | |

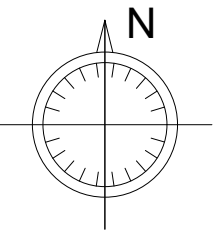

LOCATION PLAN
SCALE: 1:1250

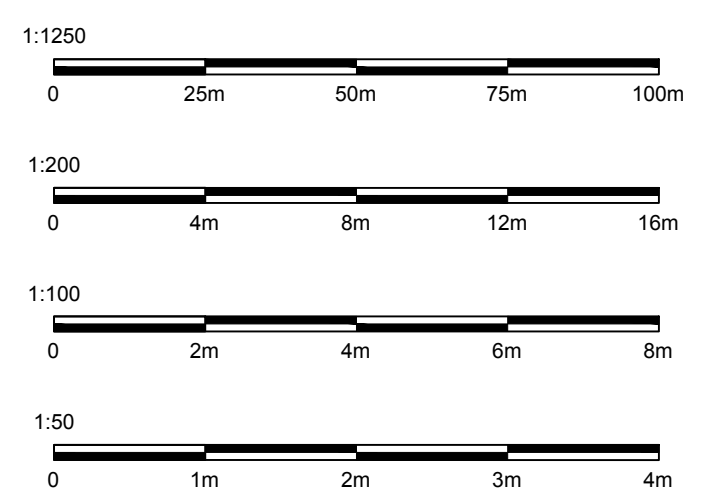

SIFA architecture
3 ST JAMES AVENUE
RAMSGATE
KENT
CT12 6DG
SIFAARCHITECTURE.COM
SIFA@LIVE.CO.UK
07940 220320

CLIENT:
-

PROJECT:
1 THE ST
SHOLDEN
DEAL
CT14 0AL

DRAWING TITLE:
SIGNAGE

PROJECT NO: SA DRAWING NO: A1/103

SCALE: 1:50 1:100 1:200 1:1250 SHEET SIZE: A1

REVISION: - DATE: 15/03/2024



Photograph showing existing sign board



New Sign board with low intensity LED light

WEST ELEVATION
SCALE: 1:50



BLOCK PLAN - Existing
SCALE: 1:200

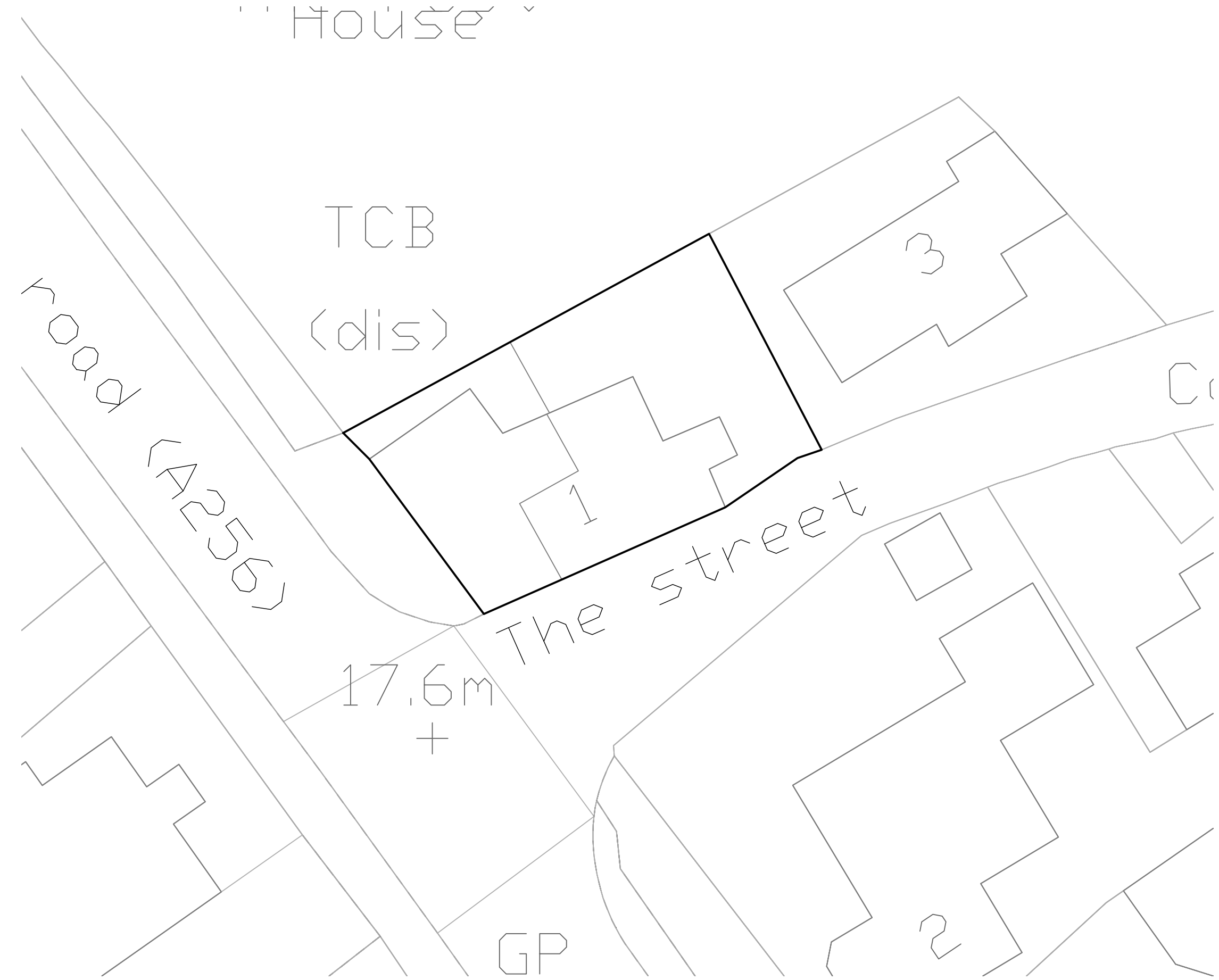

BLOCK PLAN - Proposed
SCALE: 1:200

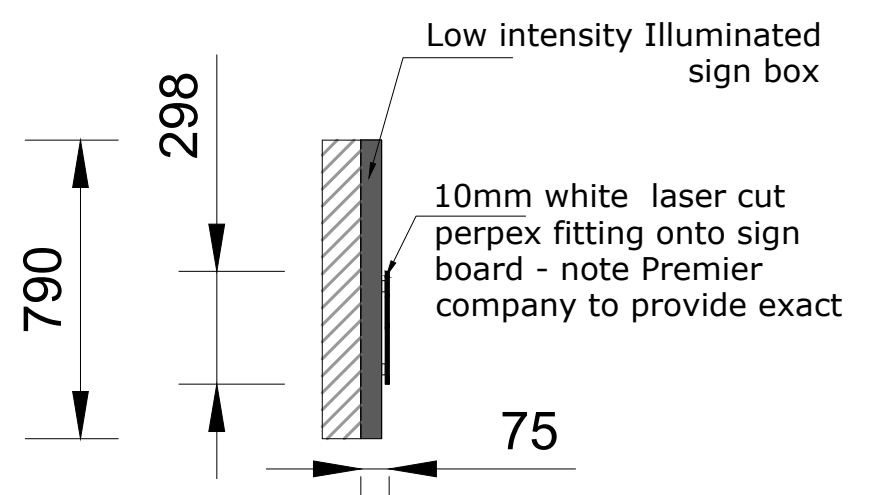
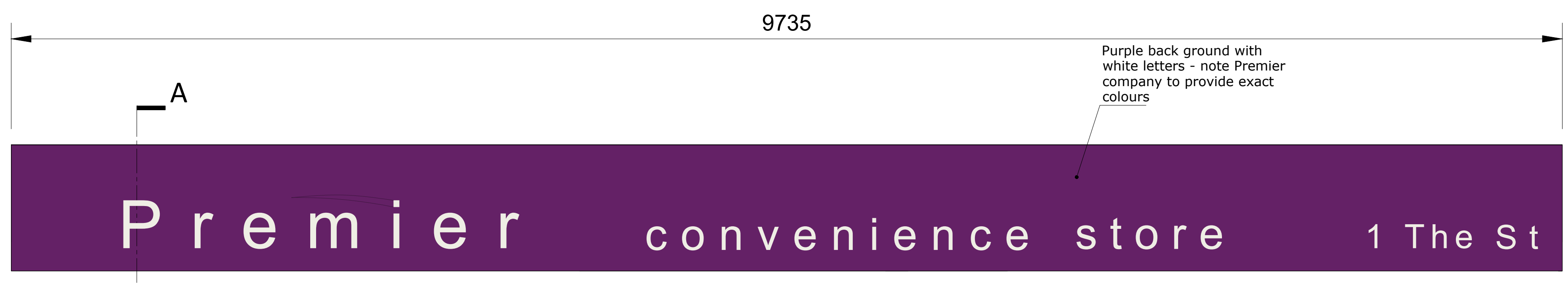

Elevation A - A
Section through new signage

New signage
scale 1:20