

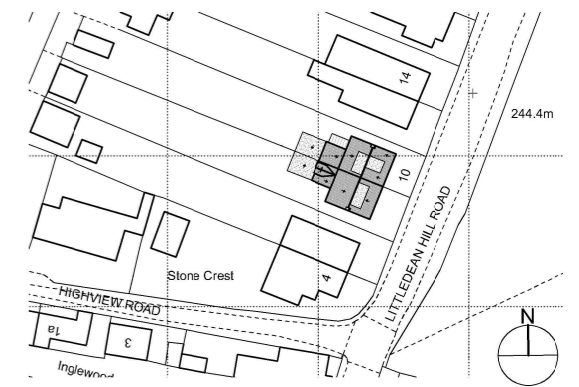

Existing South East Elevation (Front)
1:100



Existing North West Elevation (Rear)
1:100



WC and single storey part of kitchen to be demolished



Existing North East Elevation (Rear)
1:100

WC and single storey part of kitchen to be demolished

Lean-to to be demolished



Project Title: 10 Littledean Hill Road	
Client: Allan Watson	
Address: 10 Littledean Hill Road Cinderford GL14 2BE	
Drawing Title: Existing Elevations	
Project No: 1033 Drawing No: EX.PL.1033/013 Revision: Scale: 1:100@A3 Date: March 2024	Produced by: Forest Hills Design Sarah Hills sarah@foresthillsdesign.com
<small>This document and its design content is copyright and shall remain the property of Forest Hills Design Ltd. It shall be read in conjunction with all other associated project information including models, specifications, schedules and related consultants documents. Drawings are to be used for planning purposes only. Do not scale from documents. All dimensions to be checked on site. Materials are to be ordered from the site measurements. Report any discrepancies, errors or omissions on this document to Forest Hills Design. This drawing will not be reproduced without the written permission of Forest Hills Design.</small>	