

The use of this data by the recipient acts as an agreement of the following statements. Do not use this data if you do not agree with any of the following statements:-

Ryder Architecture has co-ordinated relevant information received from third parties, but are not responsible for the content of the information received from others.

The controlled version of this drawing should be viewed in DWF or PDF format not DWG or other formats. All prints of this drawing must be made in full colour.

Where this drawing has been based upon Ordnance Survey data, it has been reproduced under the terms of Ryder Licence No. 100000144. Reproduction of this drawing in whole or in part is prohibited without the prior permission of Ordnance Survey.

Do not scale the drawing. Use figured dimensions in all cases. Check all dimensions on site. Report any discrepancies in writing to Ryder before proceeding.

Scale Bar (m)

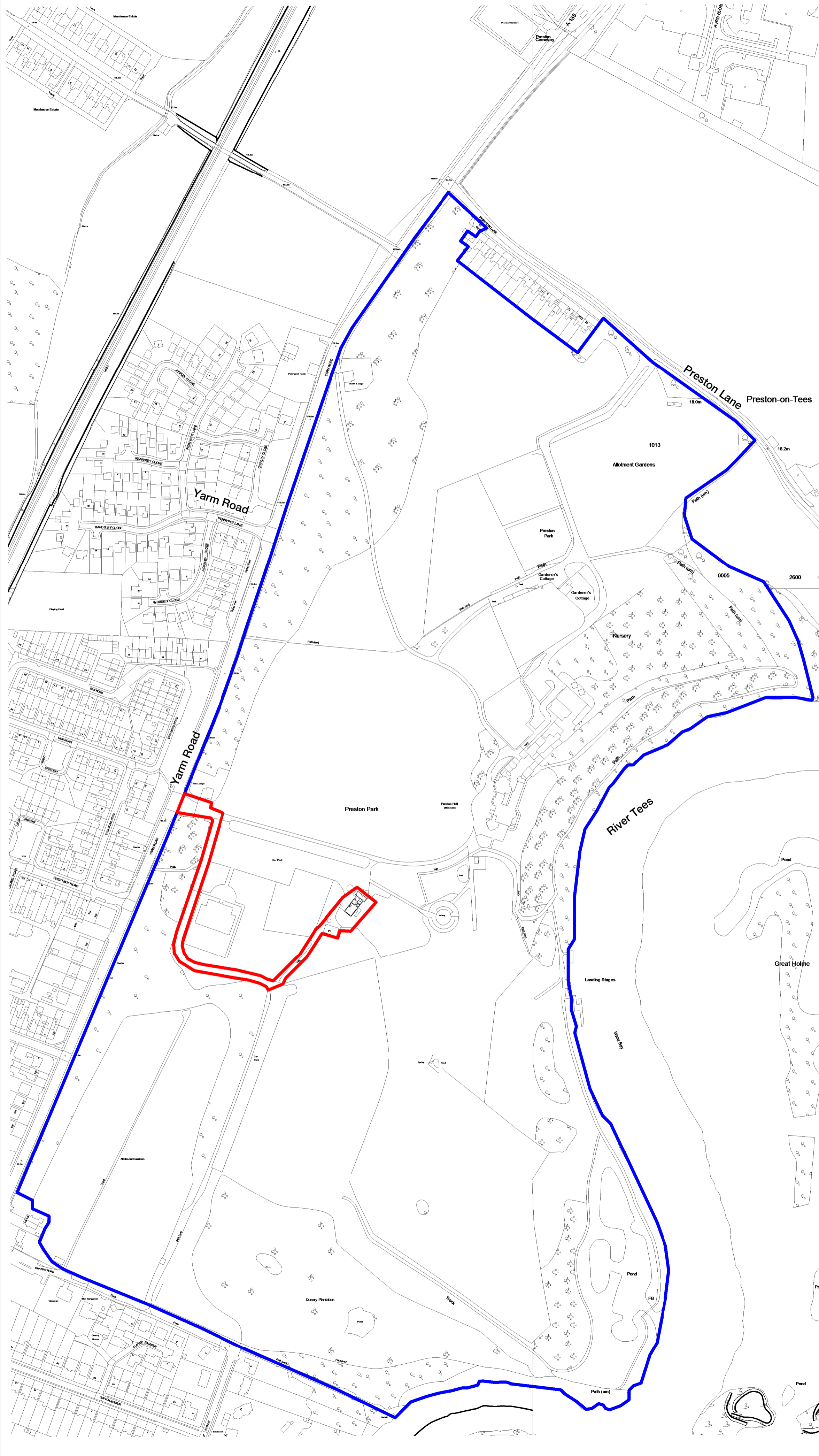
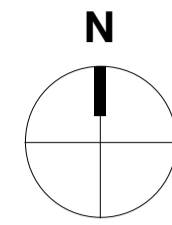
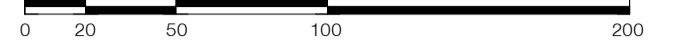

P3	Reissued for planning	BPI	KCR	09/04/24
----	-----------------------	-----	-----	----------

Rev	Description	Drawn	Checked	Date
-----	-------------	-------	---------	------

Suitability
For Information

Project
Stockton Borough Council
Preston Park Museum and Grounds - Cafe
Preston Park

Drawing
Location Plan

Drawing Number	Project ID	Originator	Zone	Level	Type	Role	Number
NE8703	- RYD	- C	- 00	- DR	- A	- 0003	
Project Number	Scale at A2	Status	Revision				
10863-00	1 : 2500	S2	P3				

info@ryderarchitecture.com
www.ryderarchitecture.com

Ryder