



The XP Slide Panoramic door offers a contemporary design statement for the most discerning homeowner.

Minimal frame and maximum glass means we can offer the finest panoramic sliding door in the UK.

With a premium, architectural design our new panoramic sliding door system, the XP Slide Panoramic incorporates glass that is bonded to the frame, giving it a sightline of only 30 mm. The outer frame of the door is designed to be hidden by the wall, giving the appearance of uninterrupted glass for an effortlessly sleek finish. The visible profiles at the head and foot of the door are only 35 mm, meaning this truly is a glass sliding door.

We have also designed a lockable cylinder into the side jamb, meaning it is the only panoramic sliding door that meets UK building regulations without the requirement for an electronically, or magnetically operated lock.

XP SLIDE PANORAMIC

BENEFITS INCLUDE:

- U value as low as 1.2W/m²K
- Testing Air Tightness: Class 4 in accordance with EN 12207
- Water Resistance: Class 8A in accordance with EN 12208
- Wind Resistance: Class B3 in accordance with EN 12210
- Weight limits per panel of 250 kg
- 16 stainless steel, high performance sliding carriage runners per panel
- Beautifully designed handle incorporated into the sliding panel
- Visible sightline of just 35 mm at the head and foot of the door
- 30 mm vertical profile sightline
- No architectural barriers
- Super thin high level design
- Extremely smooth sliding action
- Internal thumb turn three point lock with key locking cylinder
- Various vertical reinforced profiles dependent on wind loading requirements
- Maximum overall door height of 2500 mm
- Maximum panel width of 2100 mm



Incorporated handle with internal cylinder & thumb-turn

TWIN TRACK FOOT

XPSLIDE Panoramic Twin Track

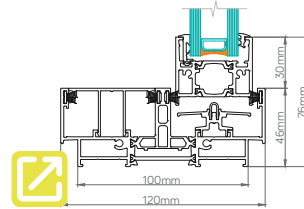

TRIPLE TRACK FOOT

XPSLIDE Panoramic Triple Track

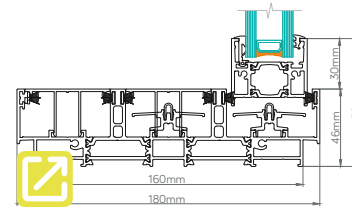

INTERLOCK SIGHTLINE

XPSLIDE Panoramic Interlock

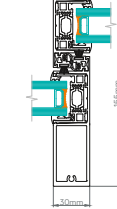

XPSLIDE Panoramic Twin Track

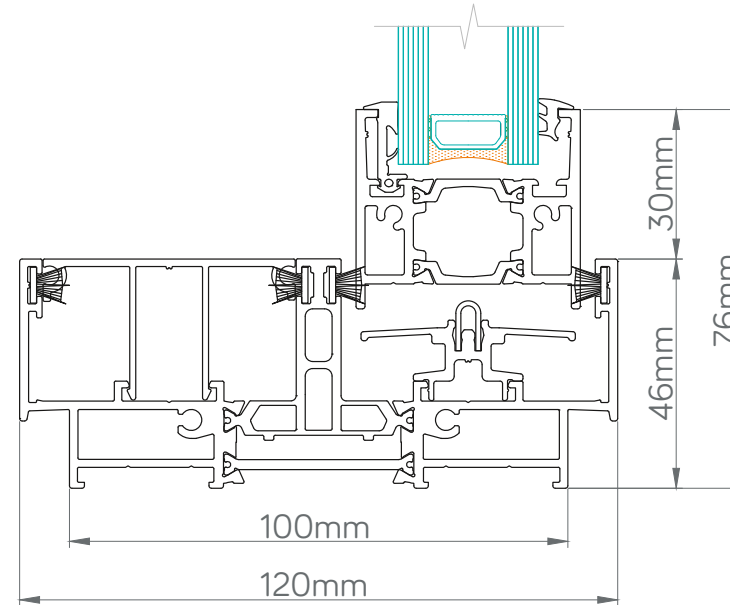

[CLICK HERE FOR TECHNICAL SPECIFICATIONS](#)



TWIN TRACK - FOOT AND HEAD DETAIL

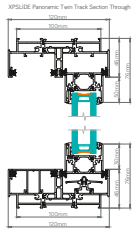

TRIPLE TRACK - FOOT AND HEAD DETAIL

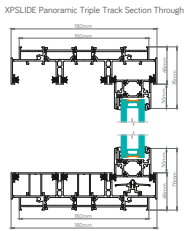

TWIN TRACK WITH CILL

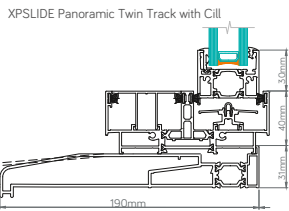

TWIN TRACK SIDE JAMB

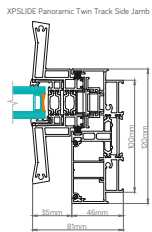

XPSLIDE Panoramic Twin Track Section Through

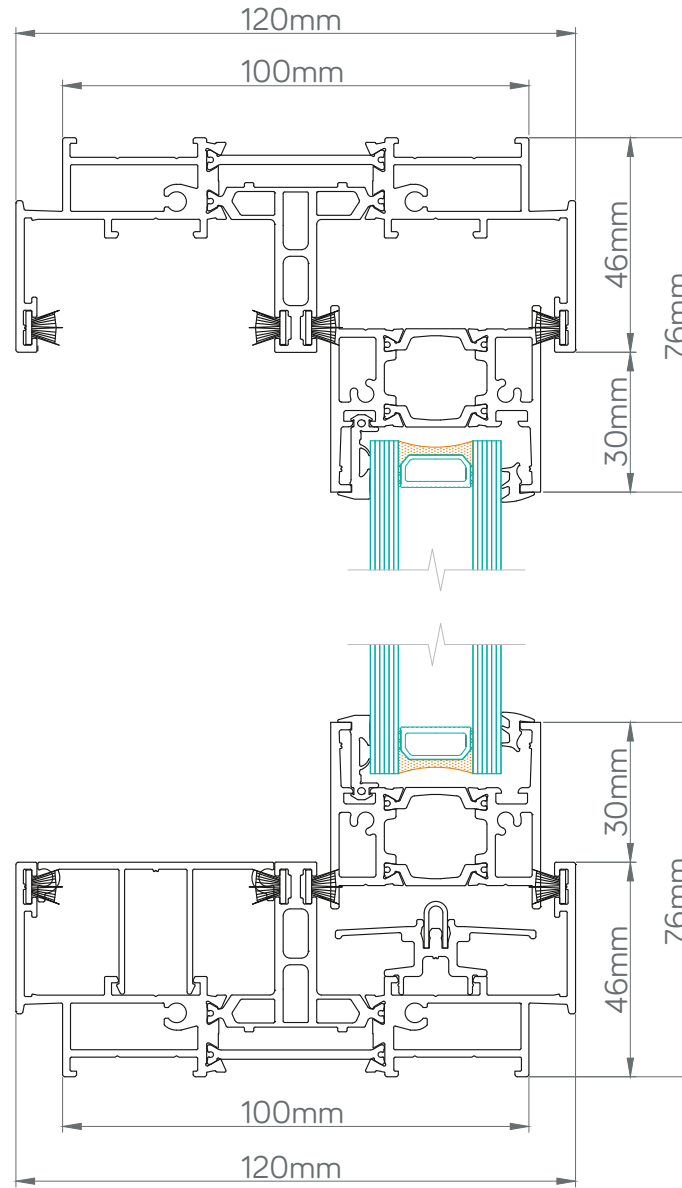

CLICK HERE TO COMPARE WITH XP GLIDE SPECIFICATIONS

