

**NOTES:**

This drawing is not a working drawing, and is only for the purpose of the following:-  
A- Planning Submission

The main contractor is responsible for informing the lead designer of any discrepancy on, or between, this drawing and any other relevant document.  
Boundaries, angles, and dimensions are to be checked by the main contractor prior to work commencing.  
Written dimensions only to be used from this drawing. If in doubt consult the lead designer for clarification.

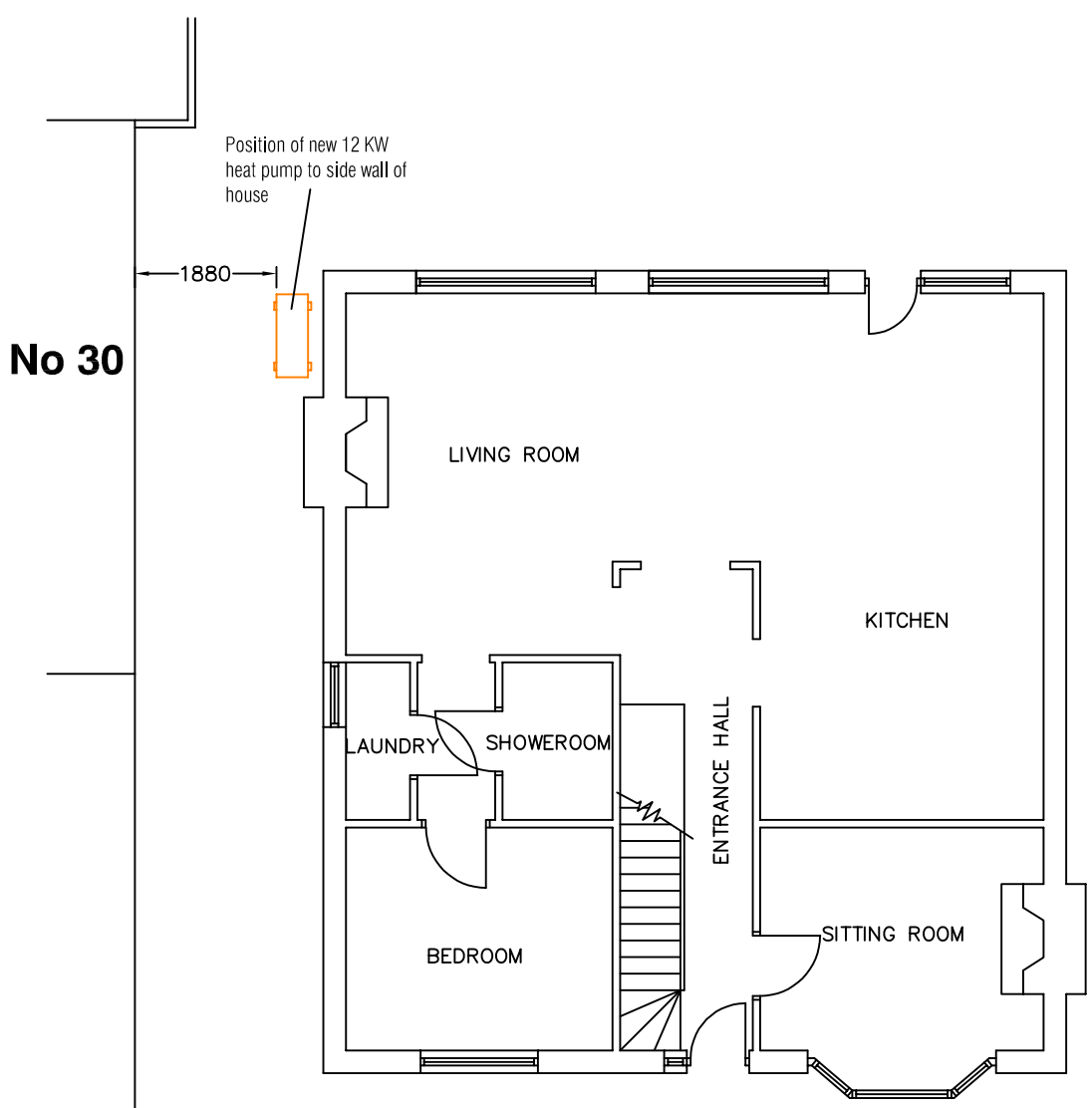

**PROPOSED GROUND FLOOR PLAN 1:100**

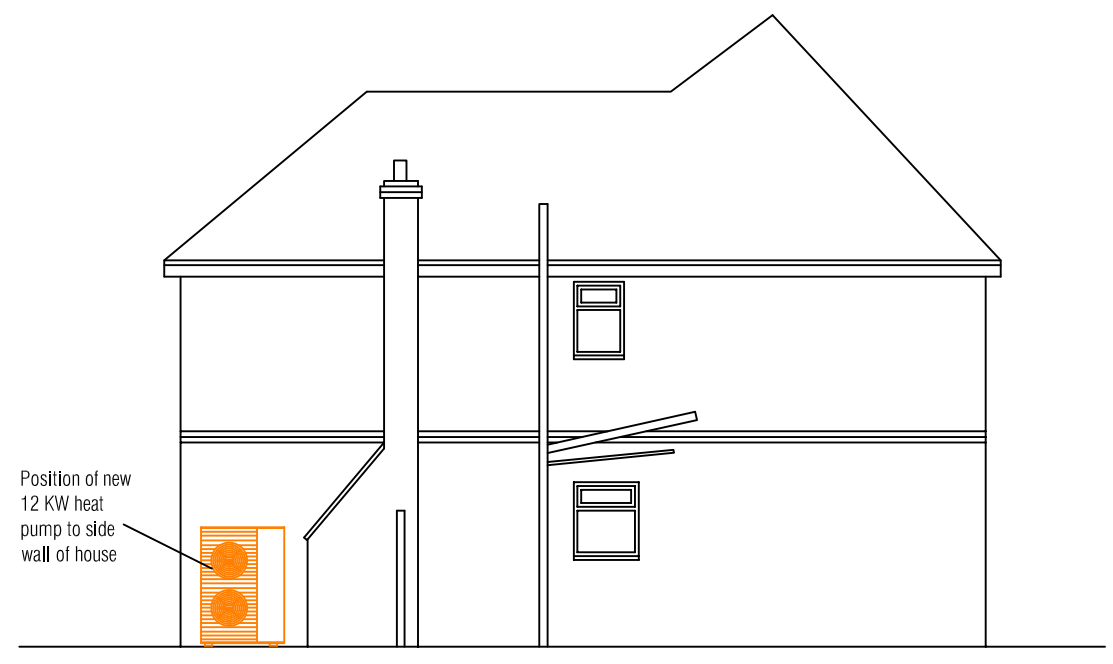

**PROPOSED SIDE ELEVATION 1:100**



**HEAT PUMP IMAGE**

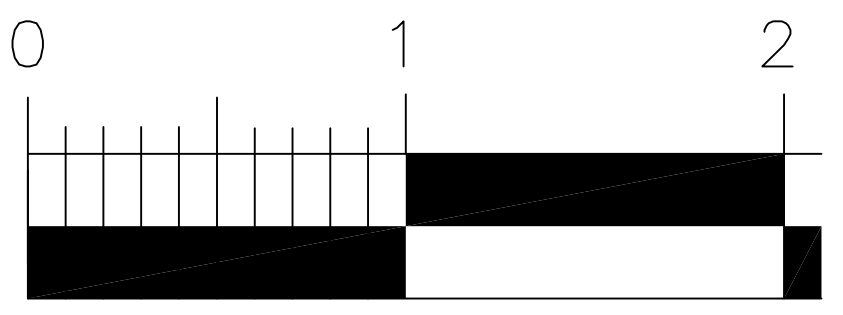

Scale 1:20

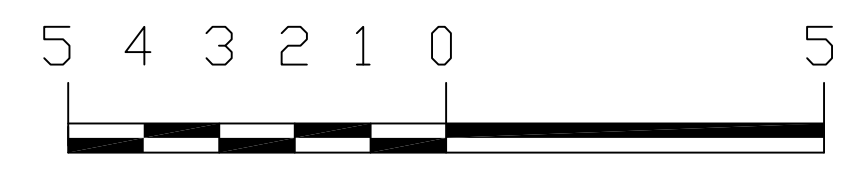

Scale 1:100

Vaillant aroTHERM plus 12.0 KW heat pump with sound power as low as 54 dB and floating floor design to absorb vibrations and reduce noise.

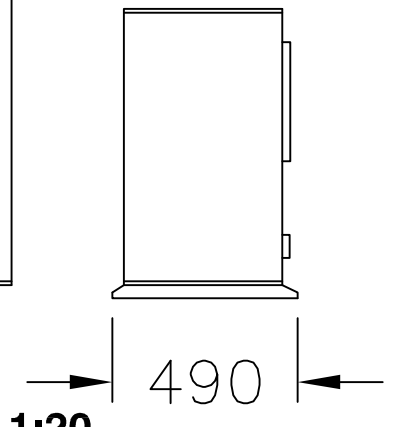
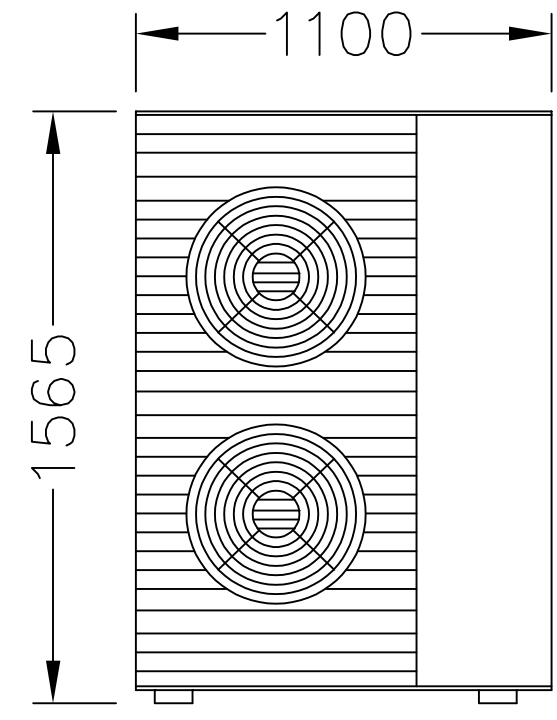
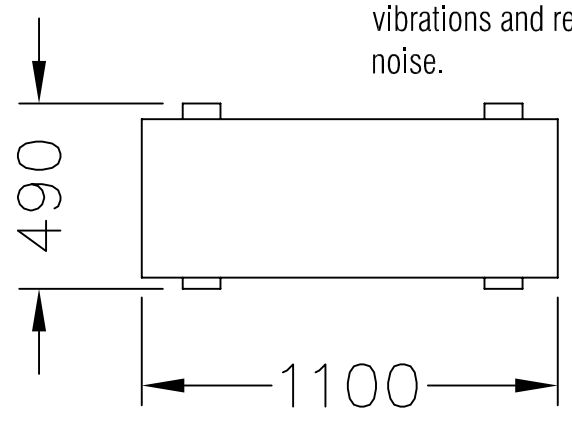

**HEAT PUMP 12 KW DIMENSIONS 1:20**

Rev A - planning comments  
08/04/24 AM

<b>STUDIO CHARRETTE</b> A: The Clubhouse, 50 Grosvenor Hill, London, W1K 3QT W: www.studiocharrette.co.uk	
<b>Client</b> <b>Ade Sangonuga</b>	
<b>Project Title</b> <b>28 Larkfield Road, Sevenoaks TN13 2QJ</b>	
Drawing Title Proposed Air source heat pump installation Proposed plan and elevation	
Drawing No. SC / 23 / 222 - 201	Rev A
Scale 1:50 & 1:20@ A3	Date - March 2024
Created By A Mc	Planning
Check By	Bulkling Control
	Client
	Sketch
	Information

This drawing and the copyright, design rights and all other intellectual property rights in it belong to Studio Charrette Ltd. No licence or assignment of any such rights is granted hereunder. This drawing is not to be copied or divulged to a third party without written permission.