

DENEHURST GARDENS

LUXBRIDGE ROAD

DO NOT SCALE this drawing, figured dimensions only are to be used.
 © This drawing is the sole copyright of Architecture519.
 Any discrepancy between this drawing and other information should be reported to the Architect.
 THE BOUNDARY SHOWN IS BASED ON INFORMATION SUPPLIED BY OTHERS. NOT ARCHITECTURE519. ALL BOUNDARIES TO BE VERIFIED ON SITE. MODIFICATIONS TO THIS DRAWING TO BE MADE SOLELY ON ORIGINAL MAGNETIC MEDIA, AND MAY ONLY BE CARRIED OUT BY ARCHITECTURE519.

REV:	DATE/DESCRIPTION:	BY:	RW:
C	27.08.19 Based for construction	LC	GS
CE	18.07.11 Lymburgs Hill wall added. Shower area added to new Substore. Door added to Core 1 lobby. Openings into rear corridor. Manufactures to 1910mm.	GS	NMB
CE	14.04.11 Levels amended as per Client instructions. Stairs added. Luxbridge Road residential entrance to A and C updated. Car and entrance lobby amended.	GS	NMB
CE	Electricity schedule updated.	GS	NMB
CE	Final construction Core 3 and new broomcup over lift.	GS	NMB
CC	10.05.11 Note on extent of works to Retail Units added.	LC	MAT
CC	Core to rest of Retail Units added.	LC	MAT
CC	24.08.11 Lobby to Core 5 introduced as per AMBC's requirements.	GS	LC

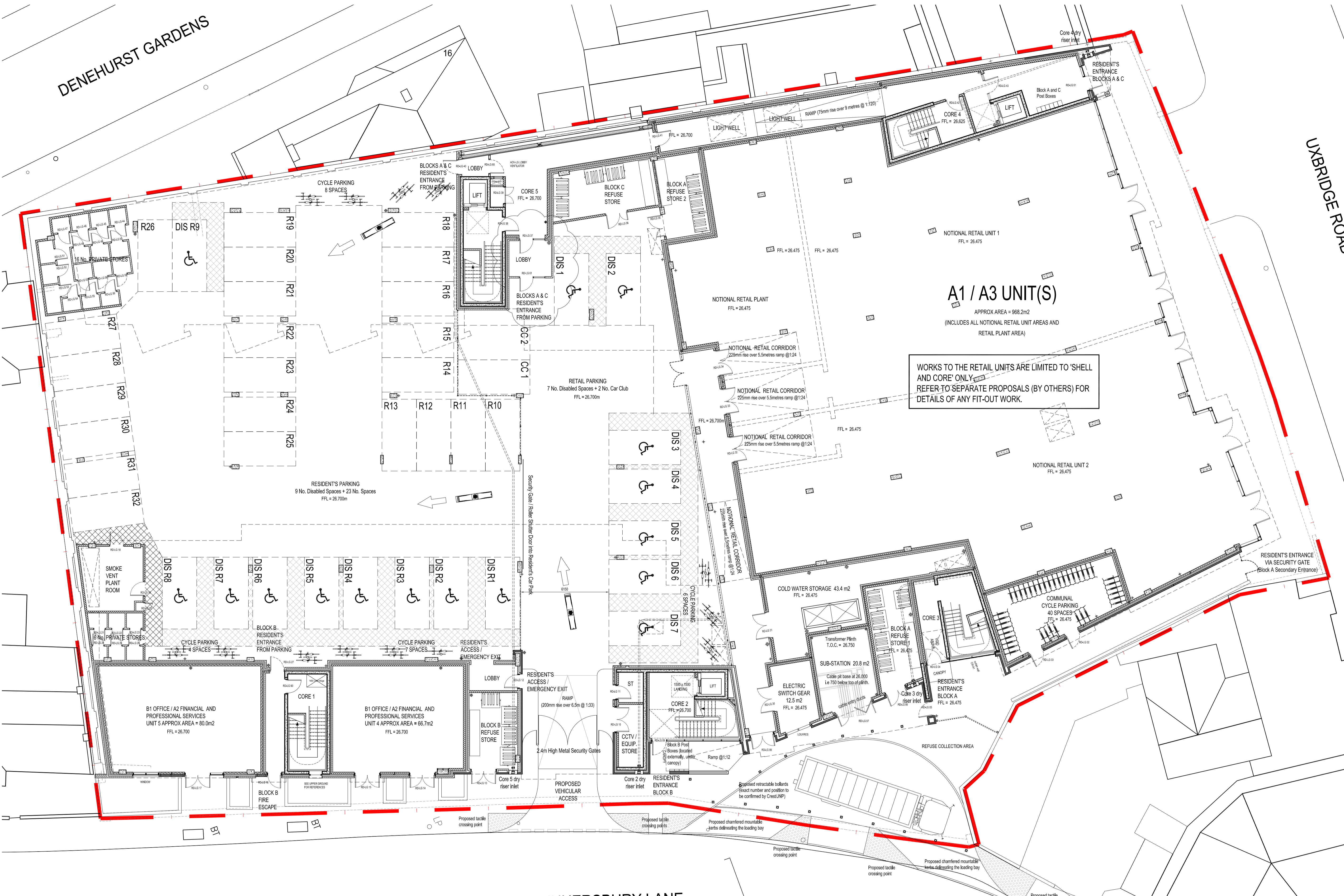

WORKS TO THE RETAIL UNITS ARE LIMITED TO 'SHELL AND CORE' ONLY. REFER TO SEPARATE PROPOSALS (BY OTHERS) FOR DETAILS OF ANY FIT-OUT WORK.

LOWER GROUND FLOOR - GENERAL ARRANGEMENT

GUNNERSBURY LANE

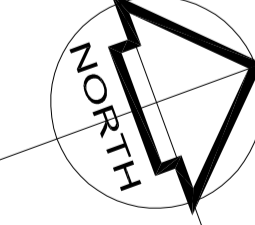

THIS DRAWING IS BASED ON SURVEY INFORMATION PROVIDED BY OTHERS AND NOT ARCHITECTURE519. ALL SVP'S ARE INDICATIVE ONLY AND SUBJECT TO VERIFICATION BY SPECIALIST DESIGNER

architecture519

Studio 12, 46 The Calls, Leeds, LS2 7EY
 Tel: 0113 213 5656 Fax: 0113 213 5657
 E-mail: Leeds@architecture519.com
 Website: www.architecture519.com



Client: Crest Nicholson (South)	
Project Name: Acton Bus Depot	Date: FEB 10
Drawing Title: Lower Ground Floor Plan - General Arrangement	Scale: 1:125
Drawing Status: CONSTRUCTION	Drawn: GS
Project No: 1038	Reviewed: LC
Drawing No: 200	Revision: CD