

Notes

1. 2 layers of plasterboard on suspended ceiling
2. 220mm timber joist
3. timber furring
4. WBP with vapour control layer
5. 185mm rigid insulation
6. mastic asphalt with root barrier and capping sheet
7. drainage layer
8. substrate to depth required 80-150mm average 133mm with semi-intensive green roof covering - with min 16 species of herb from 'London Living Roof Mix' and 4 species from 'Special Cornflower Mix'.

Including:

Agrimonia eupatoria, Anthyllis vulneraria, Centaurea nigra, Galium verum, Hypericum perforatum, Knautia arvensis, Lotus corniculatus, Origanum vulgare, Leontodon hispidus, Linaria vulgaris, Plantago media, Primula veris, Prunella vulgaris, Silene vulgaris, Sedum album, Agrostemma githago, Anagallis arvensis, Anthemis arvensis, Centaurea cyanus, Papaver rhoeas.

Maintenance as 'Bauder' guidance.

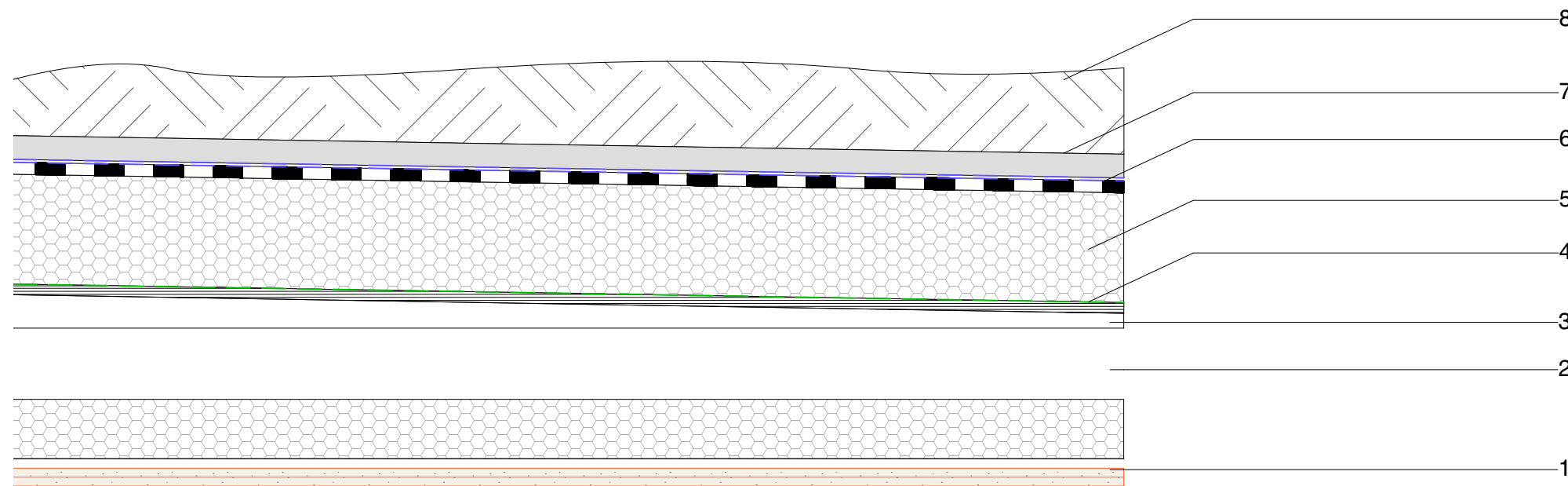

© All information contained within this document remains copyright of Architecture Landscape Urbanism Ltd and shall not be reproduced without prior consent.

- (1) Do not scale from drawings - use written dimensions only.
- (2) All dimensions are in millimeters unless noted.
- (3) All dimensions shall be verified on site before proceeding with the work.
- (4) Architecture Landscape Urbanism Ltd shall be notified of any discrepancies.
- (5) Engineer to specify all structural information.

|    |      |            |                      |
|----|------|------------|----------------------|
|    |      |            |                      |
|    |      |            |                      |
|    |      |            |                      |
|    |      |            |                      |
|    |      |            |                      |
|    |      |            |                      |
| P1 | FNMA | 2020-06-01 | Planning Application |

**Architecture Landscape Urbanism Ltd**

mail | archlandurb@gmail.com  
 tel | 07975660833  
 post | 28A Lower Marsh,  
 London,  
 SE1 7RG

Client  
**Billingsford Holdings Ltd**

|   |          |         |
|---|----------|---------|
| Project Title   |          |         |
| <b>Land off Springbank Road,</b><br>Hither Green, London SE13 6SN |          |         |
| Drawn Date  | Drawn    | Checked |
| 2020-06-01  | FNMA     | FNMA    |
| Scale   | Status   |         |
| 1:10 @ A3   | PLANNING |         |

|   |           |
|---|-----------|
| Drawing Title                             |           |
| <b>PROPOSED<br/>DETAIL</b><br>Living Roof |           |
| Drawing No.                               | Revision  |
| <b>156. 141</b>                           | <b>P1</b> |