

APPROVED

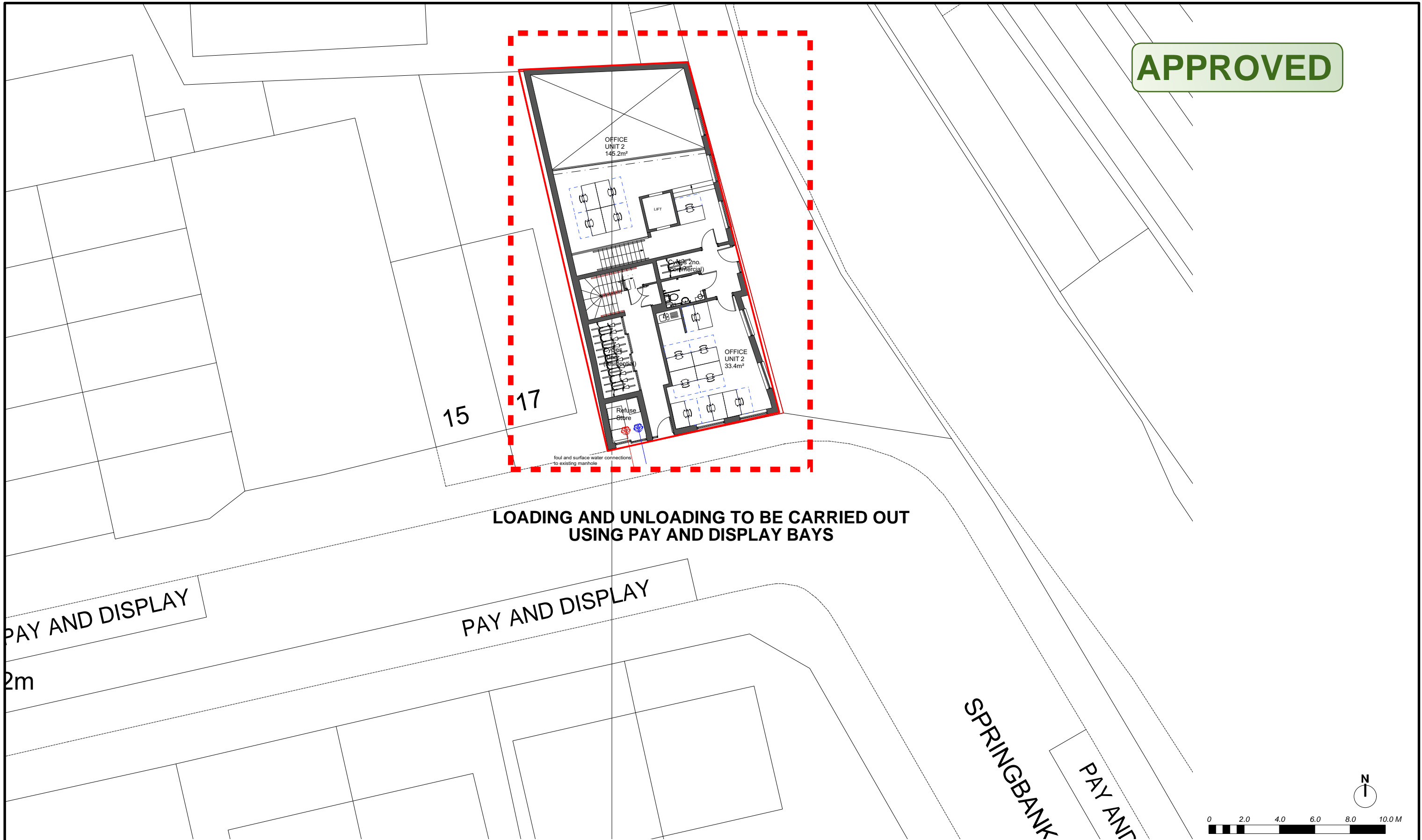

LOADING AND UNLOADING TO BE CARRIED OUT USING PAY AND DISPLAY BAYS

PAY AND DISPLAY

PAY AND DISPLAY

SPRINGBANK

PAY AND

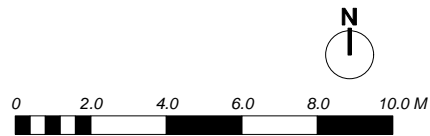

© All information contained within this document remains copyright of Architecture Landscape Urbanism Ltd and shall not be reproduced without prior consent.

- (1) Do not scale from drawings - use written dimensions only.
- (2) All dimensions are in millimeters unless noted.
- (3) All dimensions shall be verified on site before proceeding with the work.
- (4) Architecture Landscape Urbanism Ltd shall be notified of any discrepancies.
- (5) Engineer to specify all structural information.

P1	FNMA	2019-11-19	Planning Application

mail | archlandurb@gmail.com
 tel | 07975660833
 post | 28A Lower Marsh,
 London,
 SE1 7RG
 Client
Billingsford Holdings Ltd

Project Title
Land off Springbank Road,
 Hither Green, London SE13 6SN
 Drawn Date
 2019-11-19
 Drawn
 FNMA
 Checked
 FNMA
 Status
PLANNING
 Scale
 1:200 @ A3

Drawing Title
**PROPOSED
 PLANS**
 Vehicular Loading
 and Unloading
 Drawing No.
156. 131
 Revision
P1