

KEY

- Planning Application Boundary
- Existing Tree to be Removed

Trees to be Removed

Tree Reference	Species	Category	Reason for Removal
T1	<i>Amelanchier lamarckii</i>	B1	Proposed building location.
T2	<i>Prunus cerasifera 'Nigra'</i>	C1	In poor condition.

Notes:

To be read in conjunction with
 agb Environmental Ltd. - P3307.1.0 Arboricultural
 Feasibility Report for Chase Farm Parcel B, The
 Ridgeway, Enfield EN2 8JL on 31 July 2019.
 Please refer to document for further details of trees to be
 retained and removed, root protection areas and
 associated construction methodologies.

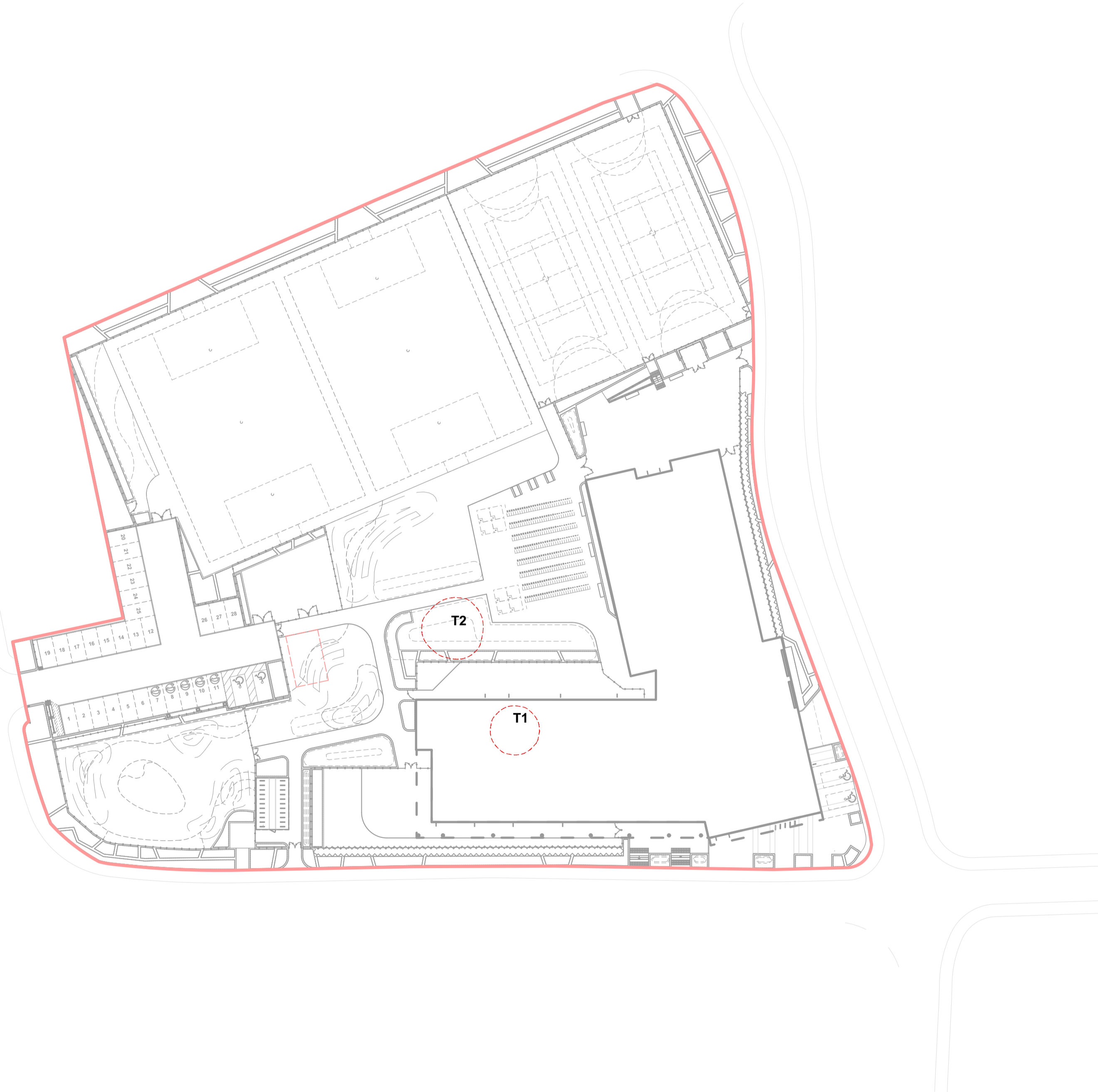

REV	DATE	DESCRIPTION
P01	25/03/2024	Issued for Planning.

CLIENT



CONTRACTOR



CONSULTANT



PROJECT

One Degree Academy

DRAWING TITLE

Tree Retention and Removal Plan

DRAWING PURPOSE

S2 - Planning

DRAWN BY	DATE	CHK'D BY	SCALE	MEDIA
AF	25/03/2024	TB	1:500	A1

CONTRACT DRAWING REFERENCE (AS REQUIRED)

PROJECT - ORIGINATOR - ZONE - LEVEL - TYPE - ROLE - NUMBER	REVISION
FS0404-ALA-ZZ-00-DR-L-0319	P01